

## Service Kit Instructions

### H1 pump

## Electrical displacement control (EDC) sensor replacement procedure



#### Removal of Sensor and Protection Cover

1. Clean pump externally with clean solvent to remove debris.
2. Remove and discard protection cover screws (D767) using a 2.5 mm internal hex wrench.
3. Remove the protection cover from the control.
4. If protection cover is damaged, discard.
5. Remove and discard sensor screws (D770) using a 2.5 mm internal hex wrench.
6. Remove and discard the sensor.
7. Clean the threads with a thread cutter.

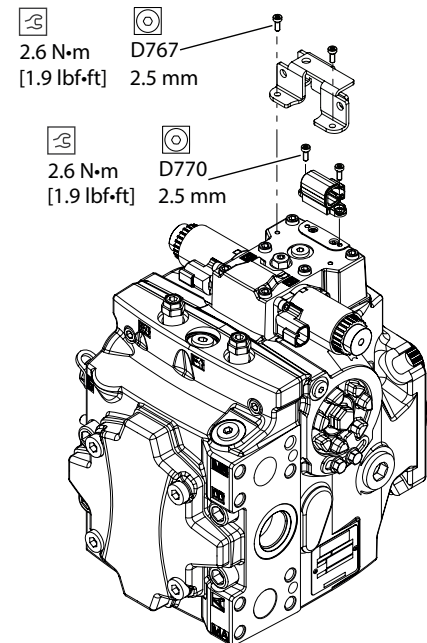

#### Installation of Sensor and Protection Cover

1. Position sensor on control housing.
2. Using a 2.5 mm internal hex wrench, fasten sensor to control housing with new screws provided in the service kit (D770). Torque screws to 2.6 N·m [1.9 lbf·ft].
3. Position protection cover on control housing over sensor.
4. Using a 2.5 mm internal hex wrench, fasten protection cover with new screws provided in the service kit (D767). Torque the screws to 2.6 N·m [1.9 lbf·ft].

#### Warning

*Calibration of sensor output in vehicle software is mandatory after sensor replacement because output signal can vary from one sensor to the next.*