



Check Valves Technical Information

Reverse Direction

CP103-2

OPERATION

This valve allows free flow from 2 to 1 and blocks flow from 1 to 2.

SPECIFICATIONS

Theoretical performance

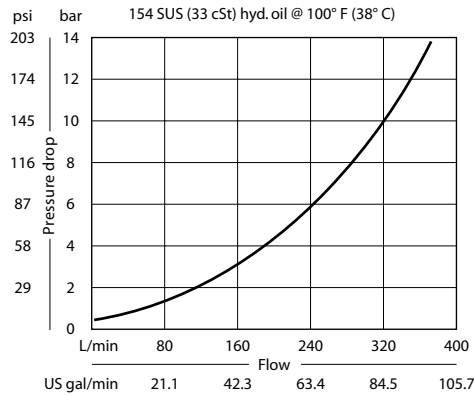

Schematic

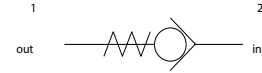

Specifications

Rated pressure	350 bar [5075 psi]
Rated flow at 7 bar	265 l/min
100 psi	[70 US gal/min]
Leakage	6 drops/min @ 207 bar 3000 psi
Weight	0.54 kg [1.20 lb]
Cavity	SDC20-2

DIMENSIONS

mm in

Cross-sectional view

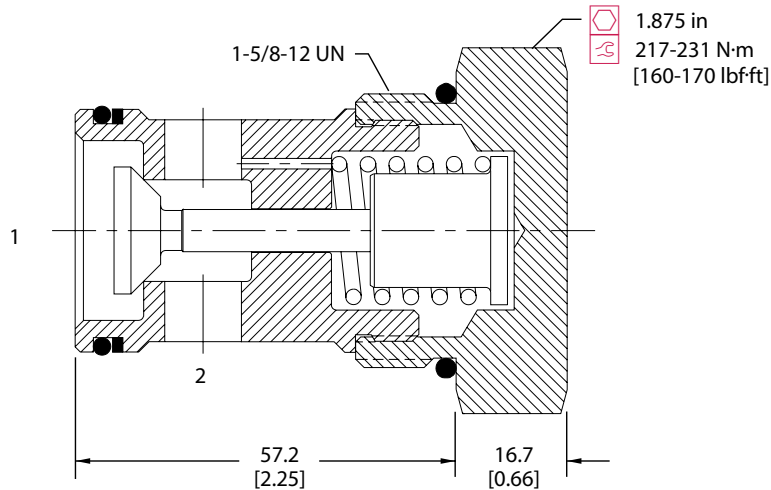

ORDERING INFORMATION

CP103-2-B-20S-005

Housing and ports

- 0 = No Housing
- 8B = Al, 1 BSP
- 10B = Al, 1-1/4 BSP
- 16S = Al, #16 SAE
- 20S = Al, #20 SAE

Other housings available

Housing P/N

- No Housing
- CP20-2-8B
- CP20-2-10B
- CP20-2-16S
- CP20-2-20S

Crack pressure

- 005 = 0.34 bar [5 psi]
- 015 = 1.0 bar [15 psi]
- 030 = 2.1 bar [30 psi]
- 050 = 3.4 bar [50 psi]
- 065 = 4.5 bar [65 psi]
- 100 = 6.9 bar [100 psi]

Seals

Code	Seal kit
B = Buna-N	120011
V = Viton	120012