



Shuttle Valves Technical Information

Load Shuttle Valve - Normal Direction

SV06

OPERATION

This valve senses the higher of two input pressures at 1 and 3, and routes it to the output 2.

Schematic

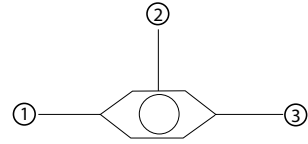

SPECIFICATIONS

Theoretical performance

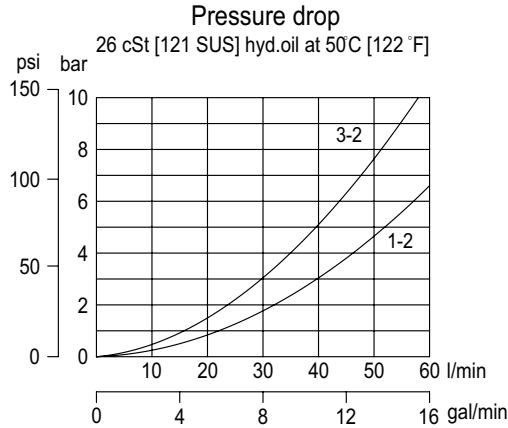

Specifications

Rated pressure*	350 bar [5075 psi]
Rated flow at 7 bar [100 psi]	48 l/min [12.7 US gal/min]
Leakage	6 drops/min @ Rated pressure
Weight	0.11 kg [0.24 lb]
Cavity	NCS06/3

*Rated pressure based on NFPA fatigue test standard (at 1 million cycles)

DIMENSIONS

mm [in]

Cross-sectional view

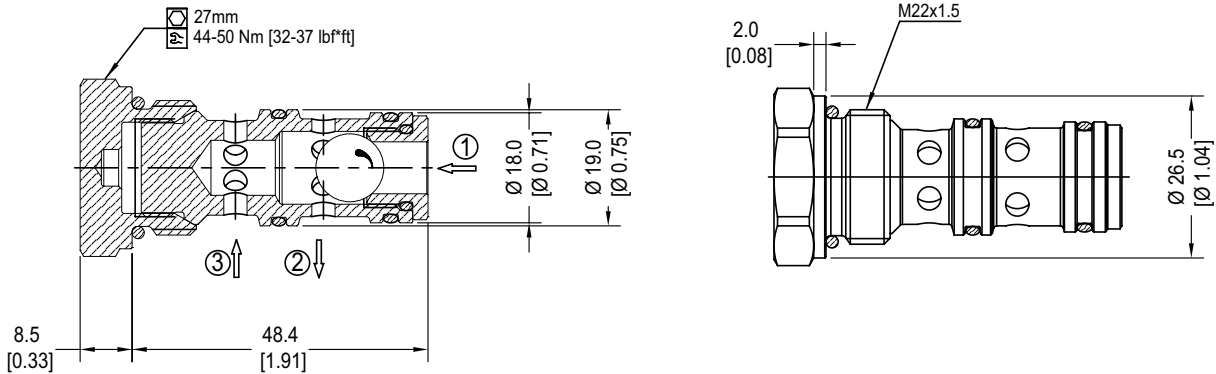

ORDERING INFORMATION

SV06-00-V

Load Shuttle Valve
Normal Direction

Seal Option	Seal kit
Omit = Buna-N	230000070
V = Viton	230000110

Code	Ports & Material	Body Nomenclature
00	00 = Cartridge only	No Body
SE3/8	AL, 3/8 BSP	NCS06/3-SE3/8
SE1/2	AL, 1/2 BSP	NCS06/3-SE1/2
SE6S	AL, #6 SAE	NCS06/3-SE-6S
SE8S	AL, #8 SAE	NCS06/3-SE-6S

**Aluminum bodies are to be used for pressures less than 210 bar (3000 psi)
***Other housings available