



Shuttle Valves Technical Information

Load Shuttle Valve - In-Line

VS 06

OPERATION

This valve senses the higher of the two input pressures and routes it to the output port.

Schematic

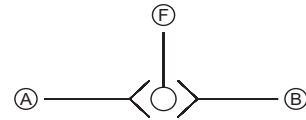

SPECIFICATIONS

Theoretical performance

Pressure drop
26 cSt [121 SUS] hyd.oil at 50°C [122 °F]
Free flow from A → F or B → F

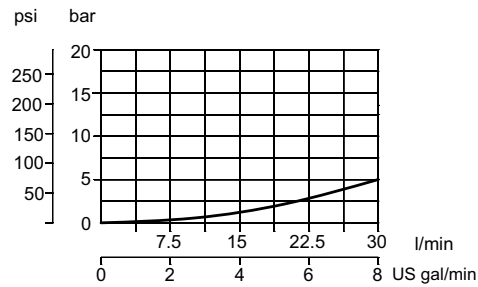

Specifications

Rated pressure	350 bar [5075 psi]
Rated flow at 7 bar [100 psi]	35 l/min [9 US gal/min]
Leakage	6 drops/min @ Rated pressure
Weight	0.22 kg [0.49 lb]
Cavity	none

DIMENSIONS

mm [in]

Cross-sectional view

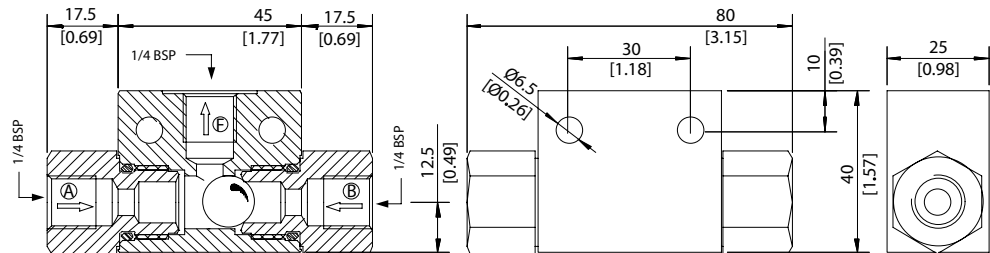

ORDERING INFORMATION

VS 06-G-V

SEALS
Omit = Buna
V = Viton