



Check Valves Technical Information

In-line, Female Port

3C11-01

OPERATION

This valve allows free flow from 1 to 2 and blocks flow from 2 to 1.

SPECIFICATIONS

Theoretical performance

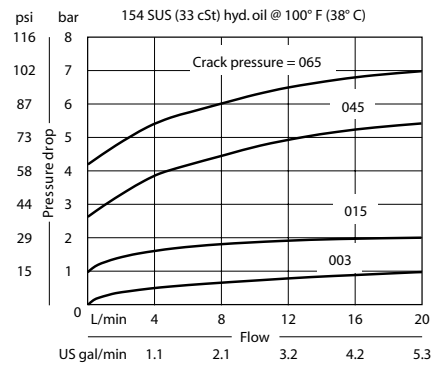

Schematic



Specifications

Rated pressure	350 bar [5075 psi]
Rated flow at 7 bar	20 l/min
100 psi	[5 US gal/min]
Leakage	5 drops/min @ Rated pressure
Weight	0.11 kg [0.24 lb]
Cavity	none

DIMENSIONS

mm in

Cross-sectional view

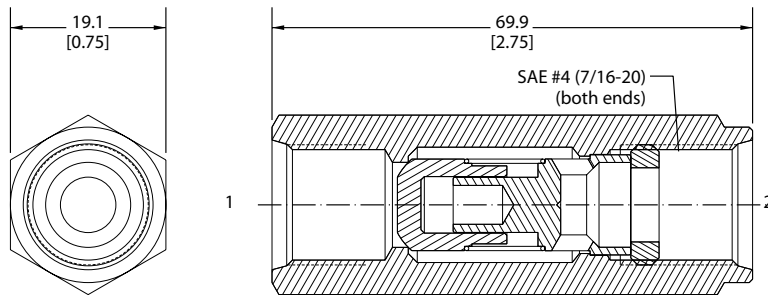

ORDERING INFORMATION

3C11-01-4S-65

Crack pressure

- 3 = 0.2 bar [3 psi]
- 15 = 1.0 bar [15 psi]
- 45 = 3.1 bar [45 psi]
- 65 = 4.5 bar [65 psi]

Port sizes

4S = SAE #4