



Check Valves Technical Information

In-line, Female Port

3C12-01

OPERATION

This valve allows free flow from 1 to 2 and blocks flow from 2 to 1.

SPECIFICATIONS

Theoretical performance

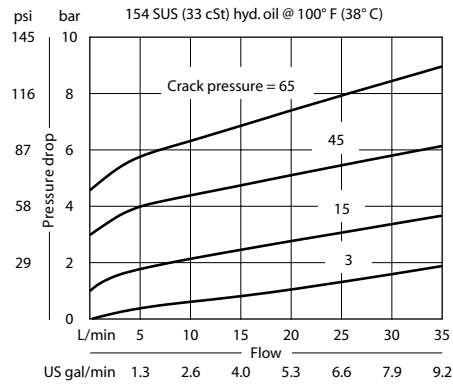

Schematic



Specifications

Rated pressure	350 bar [5075 psi]
Rated flow at 7 bar 100 psi	35 l/min [9 US gal/min]
Leakage	5 drops/min @ Rated pressure
Weight	0.17 kg [0.37 lb]
Cavity	none

DIMENSIONS

mm in

Cross-sectional view

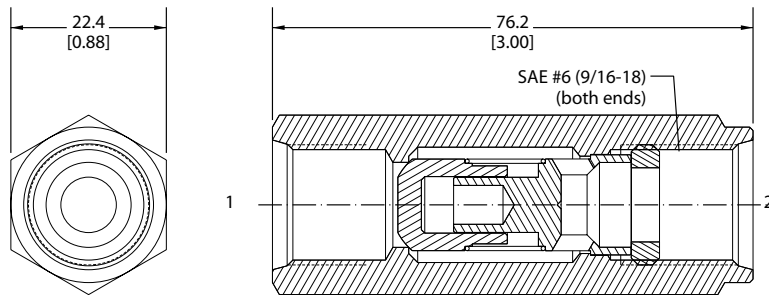

ORDERING INFORMATION

