



Check Valves Technical Information

In-line, Female Port

3C15-01

OPERATION

This valve allows free flow from 1 to 2 and blocks flow from 2 to 1.

SPECIFICATIONS

Theoretical performance

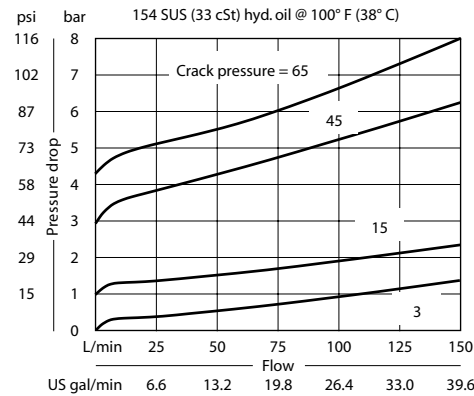

Schematic



Specifications

Rated pressure	350 bar [5075 psi]
Rated flow at 7 bar 100 psi	150 l/min [40 US gal/min]
Leakage	5 drops/min @ Rated pressure
Weight	1.00 kg [2.20 lb]
Cavity	none

DIMENSIONS

mm in

Cross-sectional view

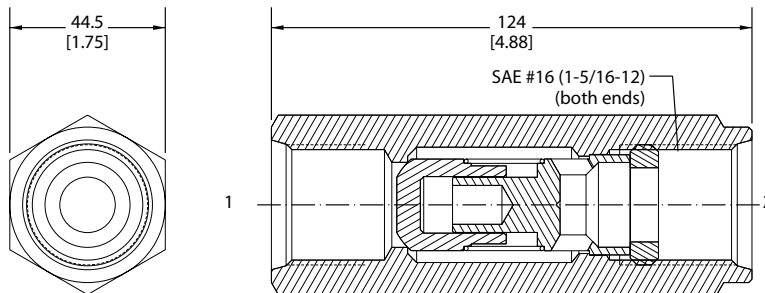

ORDERING INFORMATION

3C15-01-16S-45

Crack pressure

3 = 0.2 bar [3 psi]
15 = 1.0 bar [15 psi]
45 = 3.1 bar [45 psi]
65 = 4.5 bar [65 psi]

Port sizes

16S = SAE #16