



# Check Valves Technical Information

## In-line, Male Port

### 3CM11-01

### OPERATION

This valve allows free flow from 1 to 2 and blocks flow from 2 to 1.

### SPECIFICATIONS

#### Theoretical performance

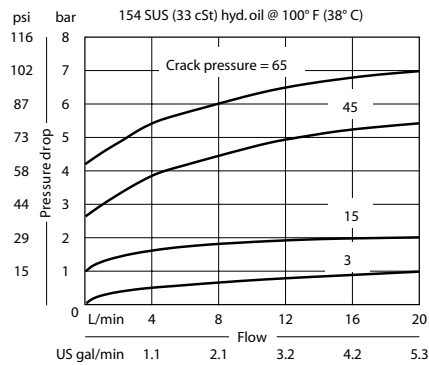

#### Schematic



#### Specifications

Rated pressure	350 bar [5075 psi]
Rated flow at 7 bar	20 l/min
100 psi	[5 US gal/min]
Leakage	5 drops/min @ Rated pressure
Weight	0.09 kg [0.20 lb]
Cavity	none

### DIMENSIONS

mm in

#### Cross-sectional view

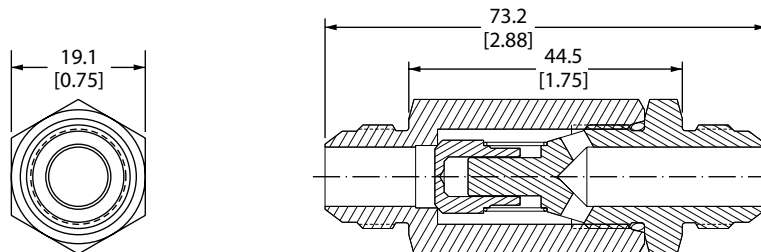

### ORDERING INFORMATION

3CM11-01-B-6F-6F-03

**Crack pressure**  
3 = 0.2 bar [3 psi]  
15 = 1.0 bar [15 psi]  
45 = 3.1 bar [45 psi]  
65 = 4.5 bar [65 psi]

**Guide port**  
6F = SAE #6, 37° flare

**Body port**  
6F = SAE #6, 37° flare

**Seals**  
B = Buna-N  
V = Viton

**Seal kit**  
720063  
720064