

Installation guide

Electric purge valve AKVA 10

Replacement of filter and orifice

UK
CA

The inner parts of AKVA 10 are sensitive to dirt/particles and should only be exposed to a clean environment. Prior to opening the AKVA 10 purge valve it is important to follow these steps (see fig. 1):

1. Close all supply lines from the purge points of the ammonia system (a)
2. Restart the controller to force pump-down
3. Wait for 20 minutes
4. Stop the compressor by turning the compressor switch QM1 to the off position
5. Close the SVA shut-off valve in the drain line (located under the IPS8 (b))
6. Release the remaining system pressure to ambient pressure by opening the SNV drain valve (c). This can also be done by attaching a permanent magnet on the AKVA 10 valve for forced opening

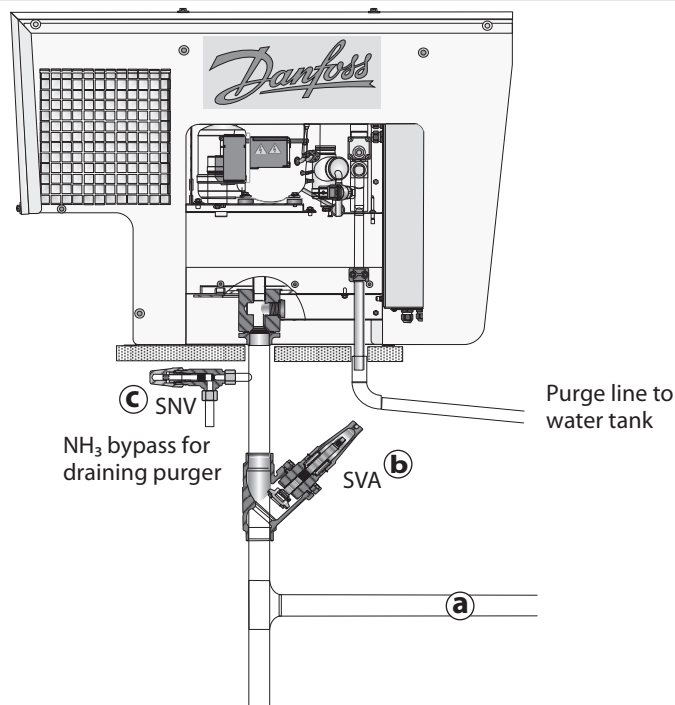

Fig. 1

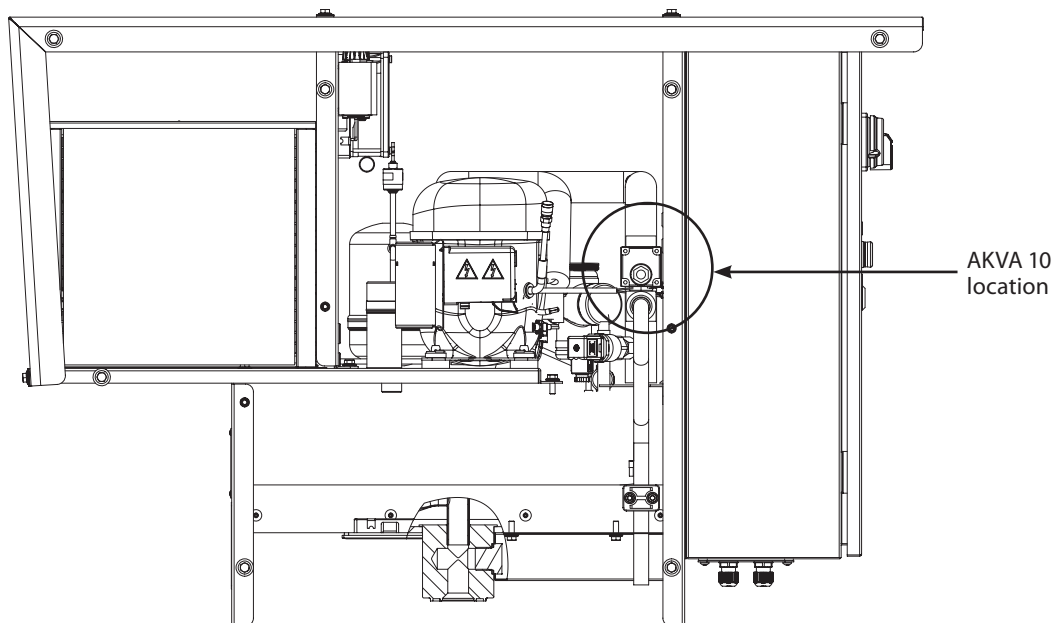

Fig. 2

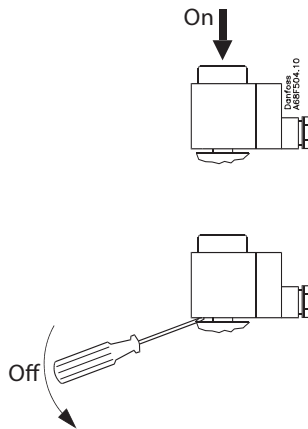

Fig. 3

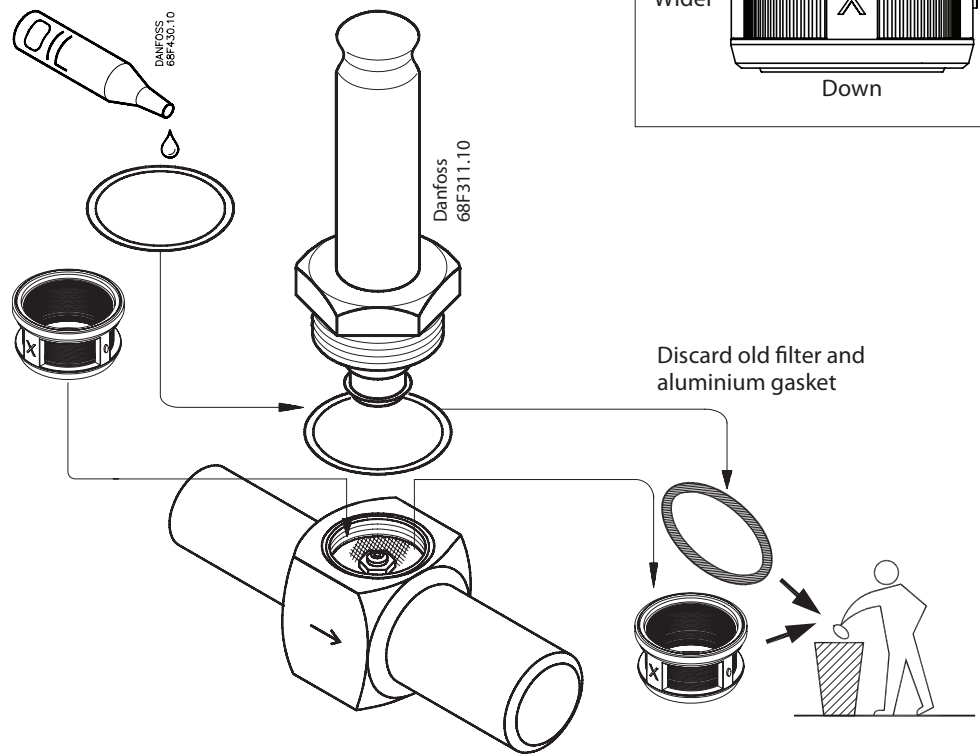

Fig. 4

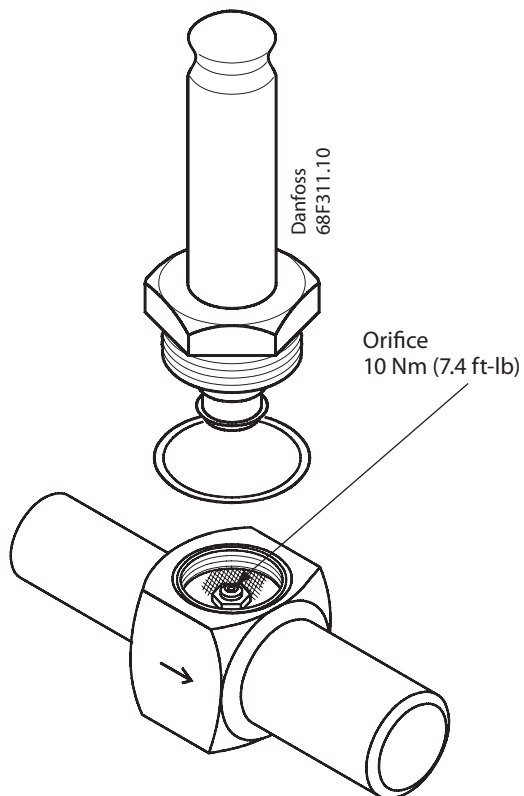

Fig. 5

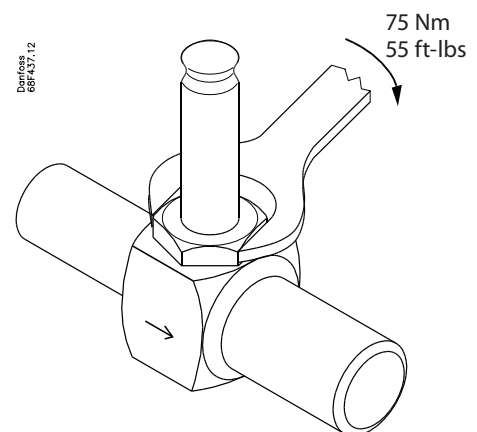

Fig. 6

