

Installation Guide

ikompact

Remote Control

Danfoss does not take responsibility of an incorrect installation, interferences produced by collision of frequencies, nor of the management of the working frequencies in fixed facilities, where several radio remotes systems, share or can share, the same zone or working area.

⚠ Warning

Proceed with caution; the equipment may not be connected correctly which may lead to unforeseeable movements on starting-up. Make sure that the crane is stopped for the entire duration of the assembly process, keep the work area free and wear protective clothing.

To guarantee the specified autonomy it is necessary to use AAA LR03 (x4) alkaline batteries with nominal capacities between 900 and 1155 mAh. It is highly recommended to use brands with + type or similar with nominal capacities close to 1155 mAh. Rechargeable batteries are NOT recommended, as its nominal capacity is lower than the desired one.

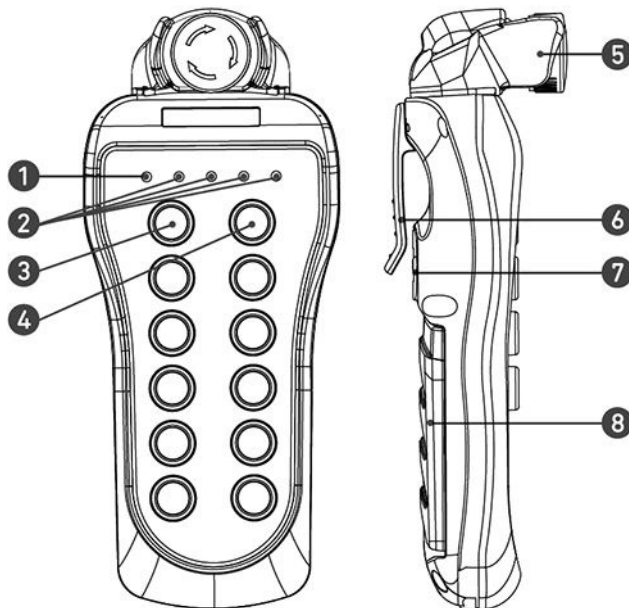
Description**Legend:**

1. Status LED
2. Feedback LEDs
3. START Button
4. STOP Button (if no STOP option)
5. STOP Pushbutton Option
6. Hook attachment
7. Removable EEPROM module
8. Alkaline batteries



1. Proceed to connect the power supply and the outputs according to the connection block diagram provided with the system. The configuration of the radio node can last up to 1 minute.

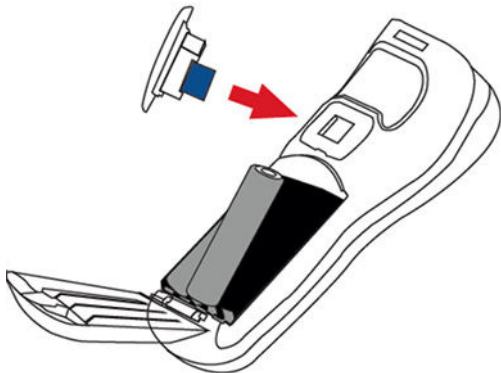

2. Place the EEPROM and the charged alkaline batteries.



3. If the transmitter has the STOP button, press and pull it out. The status LED will blink in blue until the Stand-by mode is reached, then it will turn into fixed blue.



4. If the transmitter does not have the STOP button, press the start button. The status LED will blink in green until the transmitter is linked with the receiver.



5. When the receiver confirms the link, the status LED will turn into fixed green, and will enter working mode. The system will be fully operational in order to action any maneuver.

Receiver User Manuals & Datasheets



Transmitter User Manuals & Datasheets



<https://www.danfoss.com/en/products/dps/electronic-controls/human-machine-interfaces-hmi/plus1-remote-controls/>

Installation Guide
Ikompact Installation Guide

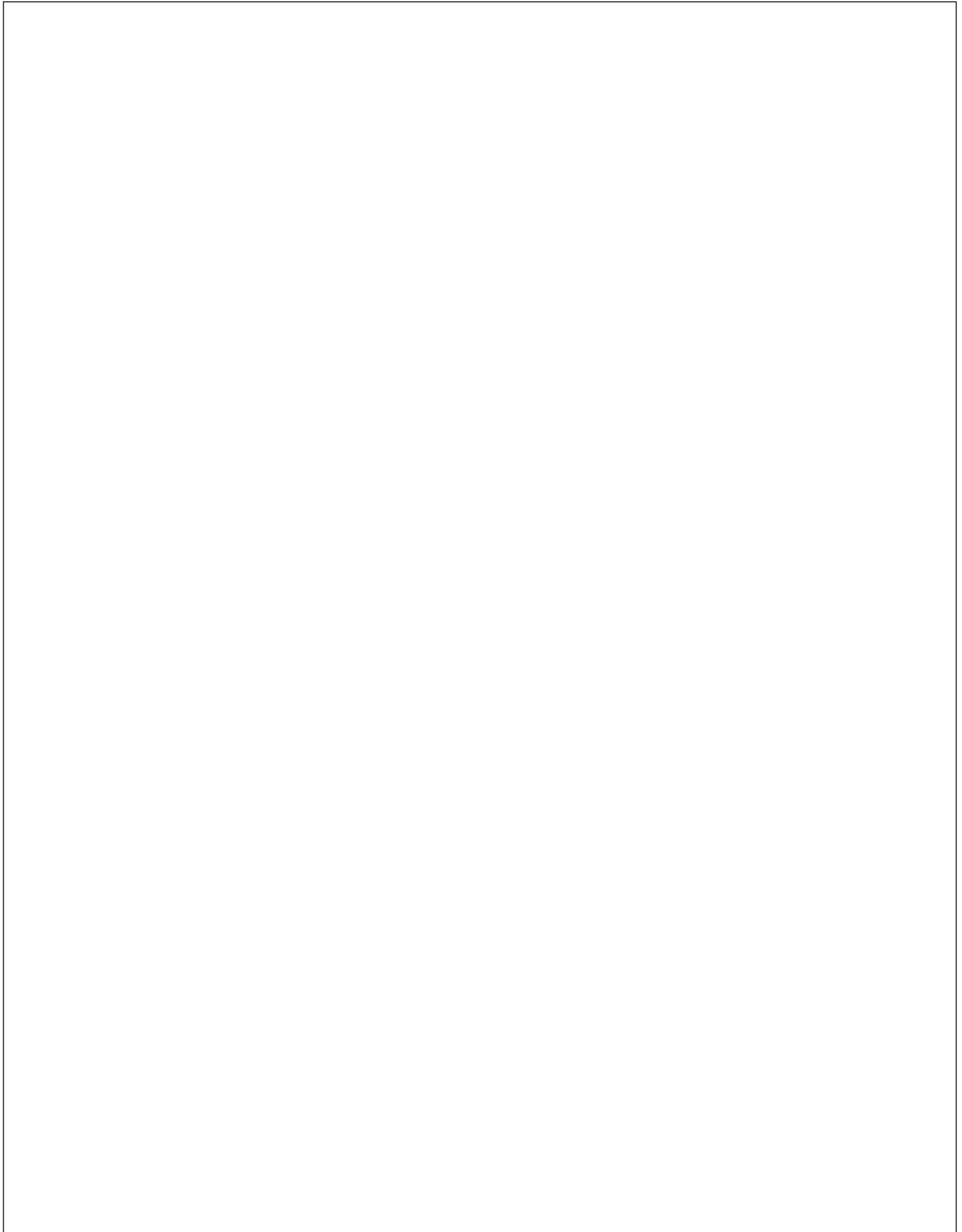

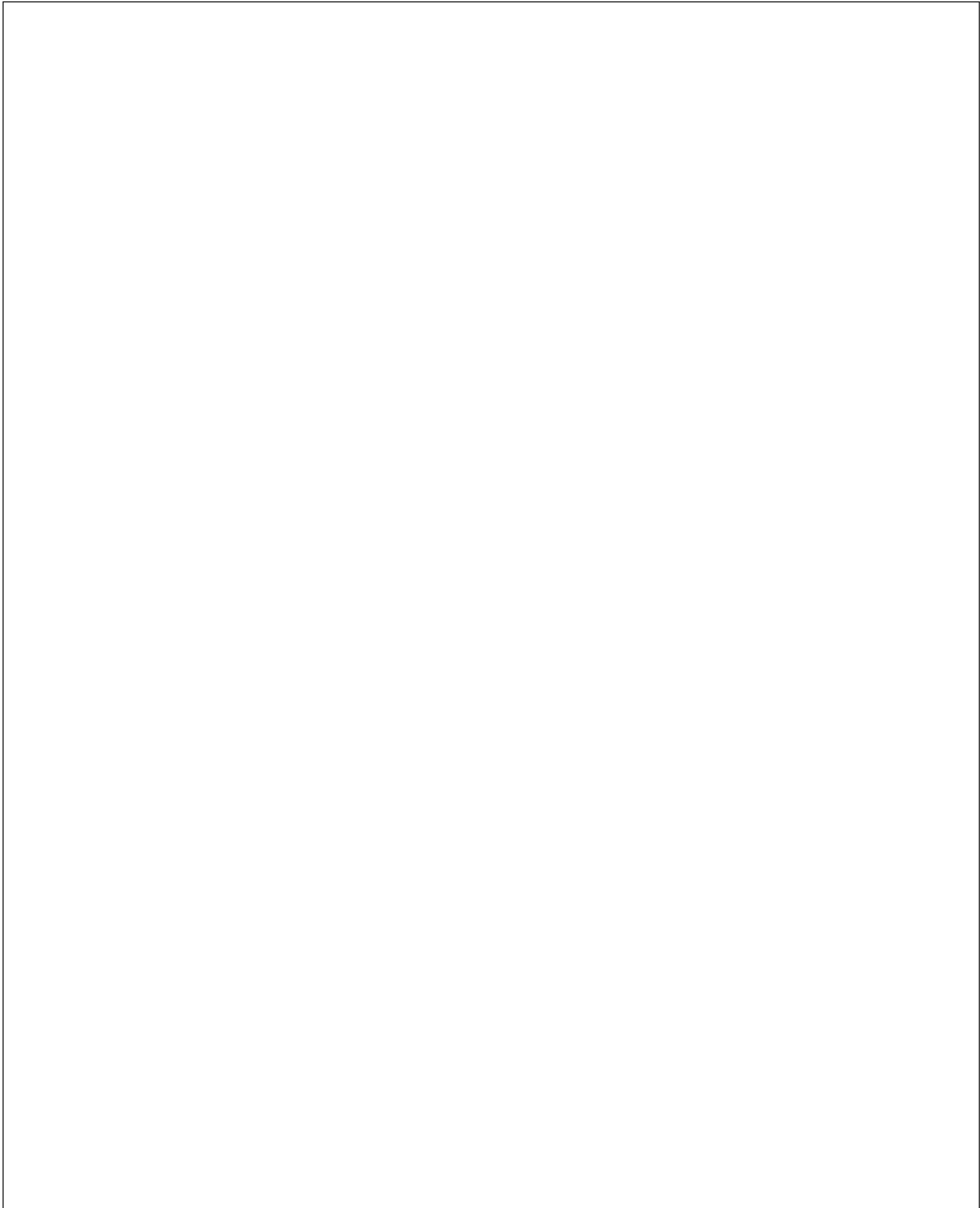

Danfoss can accept no responsibility for possible errors in catalogues, brochures and other printed material. Danfoss reserves the right to alter its products without notice. This also applies to products already on order provided that such alterations can be made without subsequent changes being necessary in specifications already agreed. All trademarks in this material are property of the respective companies. Danfoss and the Danfoss logotype are trademarks of Danfoss A/S. All rights reserved.