

Vickers® by Danfoss Industrial Welded Cylinder Series

Relaunch 2022



Features

- Welded construction
- Industrial market focus
- Robust construction - 3000 PSI
- Configurable port in cap design
- Many bore and rod combinations
- Additional options (electronic switches, rod coatings, stop tubes etc)
- Engineer-to-order available
- Available in online Configurator Dec 2022

Markets/Applications

- Balers
- Waste processing
- Material handling
- Oil & Gas
- Wind turbine (blade pitch axis control)

Why **welded?** Why **now?**

Ideal for the toughest jobs, our welded cylinders are engineered with high-yield-strength steel and a special end-cap welding process to keep systems operating stronger, longer. Featuring an advanced sealing technology that virtually eliminates leaks, welded cylinders also have no tie rods to collect dirt and debris.

Configurable and competitive

New, improved design and manufacturing processes enable the new welded cylinder series to be easily configured with a wide variety of sizes, mounting options, coatings and more. In addition to offering competitive pricing, a domestic supply shortens delivery times.

[Try the Cylinder Configurator!](#)



Features and specifications

Bore Sizes: 1.5" - 8"

Pressure Rating: 3000 psi Hydraulic Service

Iron rod Gland

- Optimal fit between High strength ductile iron gland and cylinder body is achieved by a precision fit body seal and backup on the gland O.D.
- Optional wear bands are available to provide additional side load protection.

Steel Port Boss

- Careful material selection allows for full threads to be machined on bosses and insure pressure-tight porting connections.

Piloted Cast Iron Piston

- Machined to maximum bearing support and wear resistance, the unitized assembly is pilot-fitted into the head on a precision bored diameter to assure true concentricity.
- Positive connection to rod insured by thread locker.

Piston Wear Band

- Side load protection provided through non-metallic wear band.

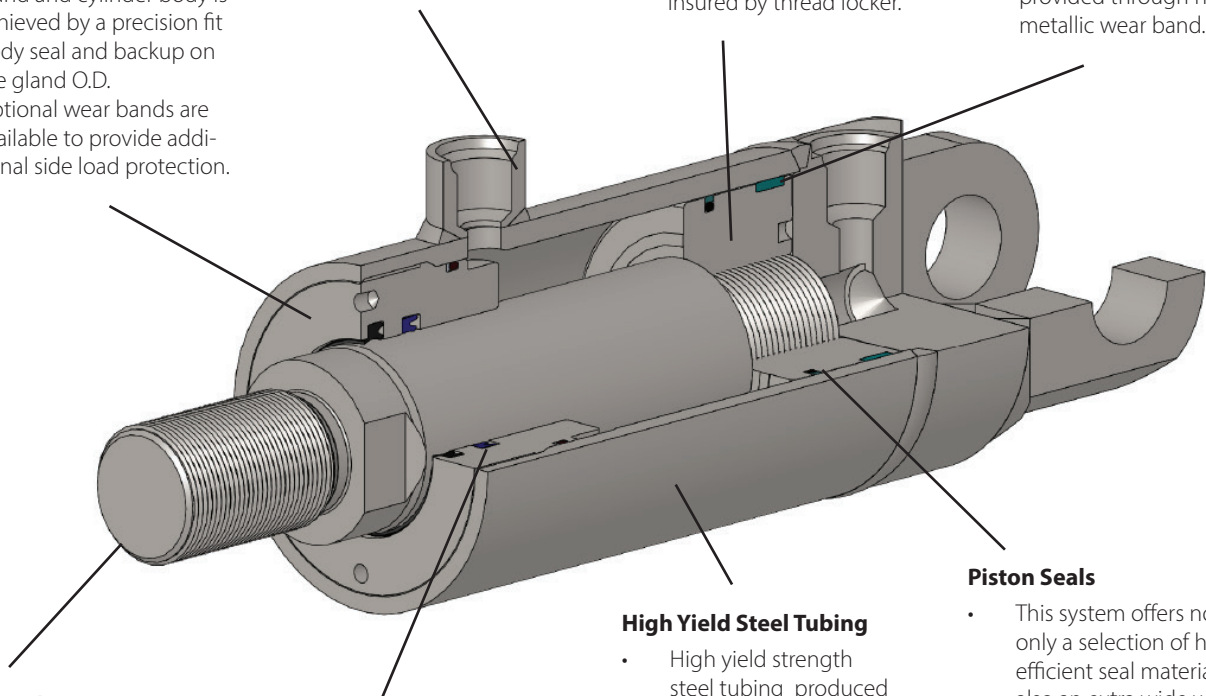

Piston Rod

- Hard chrome plated piston rod in a variety of diameters between 1 and 5 1/2 inches provides maximum durability and extends seal life.

Rod Seal/Wiper

- Carefully selected wiper and seal combinations to deliver exceptional all-around performance and durability.

High Yield Steel Tubing

- High yield strength steel tubing produced to exceed the ASTM-513 specifications. This combination of superb base material and superior processing insures straight, smooth, and long life cylinders.

Piston Seals

- This system offers not only a selection of highly efficient seal materials, but also an extra wide wear band that rides smoothly within the precision-honed cylinder body to provide extended piston seal life.

Available Mounting Styles

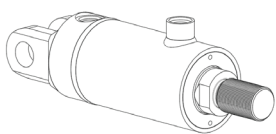

WH10: Cap Fixed Clevis Mount

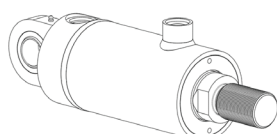

WH11: Cap Spherical Bearing Mount

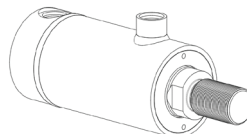

WH24: No Mount

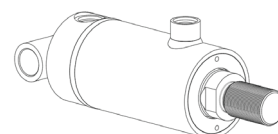

WH46: Cross Tube Mount

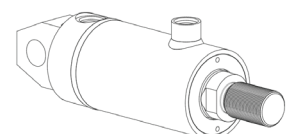

WH47: Cap Fixed Eye Mount

Danfoss can accept no responsibility for possible errors in catalogues, brochures and other printed material. Danfoss reserves the right to alter its products without notice. This also applies to products already on order provided that such alterations can be made without subsequent changes being necessary in specifications already agreed. All trademarks in this material are property of the respective companies. Danfoss and the Danfoss logotype are trademarks of Danfoss A/S. All rights reserved.