

Fact Sheet

VLT® Integrated Servo Drive ISD® 510



VLT® Servo Access Box SAB®

The SAB® generates a 600 V DC power supply and guarantees high power density. It has a removable Local Control Panel (LCP) and is based on the proven quality of a Danfoss frequency converter. The SAB® delivers an output of 7.5 kW and 15 A.

1.5-13 Nm torque

range gives you more design flexibility in your decentralized system plans

VLT® Integrated Servo Drive ISD® 510 is a high-performance decentral servo motion solution, developed specifically for the Food & Beverage and Packaging industries. The servo system comprises a central power supply SAB®, drive modules and cabling infrastructure. The decentralization of the drive unit offers benefits in mounting, installation, and operation. Depending on the application, the SAB® can power up to 64 drives in a servo drive system. The open system supports both EtherCAT® and Ethernet POWER-LINK®.

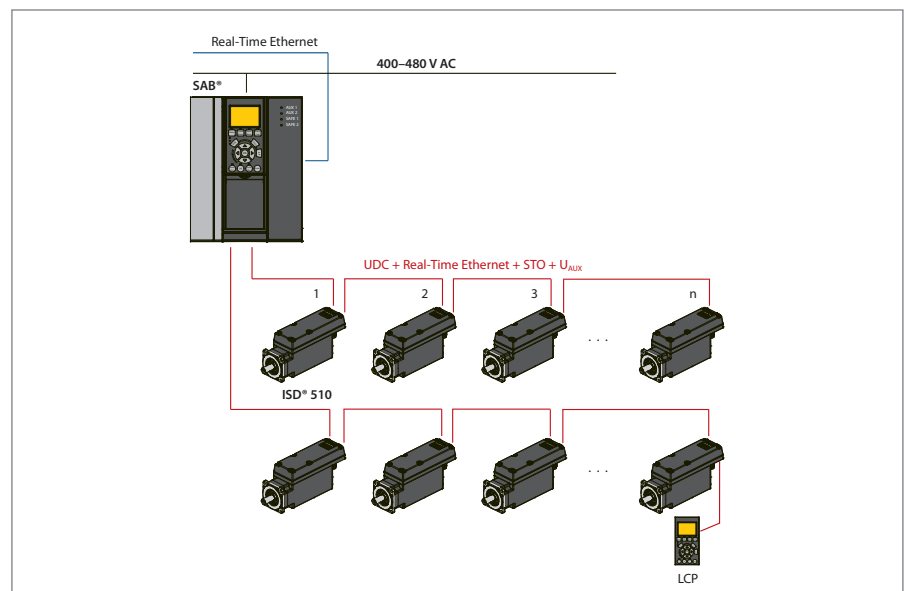

Servo Drive

The motion control is integrated into the drive so that the motion sequences can take place independently. This releases the central PLC and offers a highly flexible drive concept. The master can be programmed via IEC 61131-3 and hybrid cables are used to connect the servo drives, making installation fast and simple.

The perfect solution for:

- Packaging machines
- Food & Beverage machines
- Pharmaceutical machines

| Feature | Benefit |
|---|--|
| Dynamic servo performance | Fast, accurate, and energy-efficient |
| Compact and decentral servo drive | Reduced costs and high flexibility |
| 64 standard servo drive variants in sizes 1 and 2 | Selection of most suitable drive for the application's torque and power requirements |
| Real-time systems EtherCAT® and Ethernet POWERLINK® | Fast process communication |
| Control via IEC 61131-3 | Open system |
| System setup performance | Simple and fast configuration of several drives |
| Hybrid cables in daisy-chain concept | Easy and fast installation, reduced number of cables |
| Removable Local Control Panel (LCP) | Direct connection to the servo drives for fast commissioning, diagnosis, and service |
| LEDs on servo drive and SAB® | Fast and effective monitoring |
| Standard and advanced servo drive variants | Cost-effective solution |

Available Options

- Mechanical holding brake
- Feedback:
 - Resolver
 - Single-turn
 - Multi-turn
- Customized flange on request
- Shaft seal
- Flexible hybrid cable

Specifications

| ISD® 510 | | |
|------------------------------------|-----------------|---|
| Rated voltage | $U_{DC\ link}$ | DC 565 V |
| Rated torque | M_N | 1.5-3.8 Nm |
| Maximum torque | M_{0max} | 6.1-13 Nm |
| Rated current | I_N | 1.4-1.8 A |
| Maximum current | I_{0max_rms} | 5.7-6.4 A |
| Rated speed | n_N | 2400-4600 rpm |
| Rated power | P_N | 0.72-0.94 kW |
| Inertia (without mechanical brake) | J | 0.85 / 1.45 / 2.09 / 2.73 kgcm ² |
| Shaft diameter | | 14/19 mm |
| Protection rating | | IP54/IP67 (shaft IP65) |
| Safety rating | | STO (Safe Torque Off) |

| Servo Access Box | | |
|------------------|-----------|-----------------------------------|
| Input voltage | U_{IN} | 400-480 V AC $\pm 10\%$, 3-phase |
| Input current | I_{IN} | 11.14 A @ 400 V / 9.3 A @ 480 V |
| Output voltage | U_{OUT} | 565-680 V DC $\pm 10\%$ |
| Rated power | P_N | 7.5 kW |
| Rated current | I_N | 15 A |
| Enclosure | | IP20 |

Dimensions

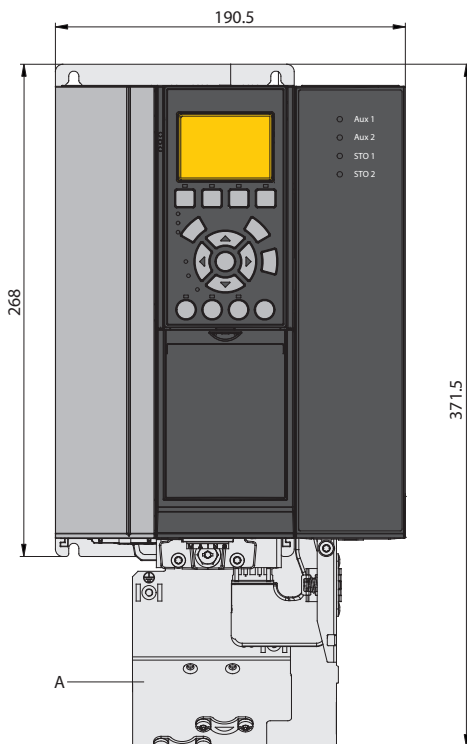

A = decoupling plates

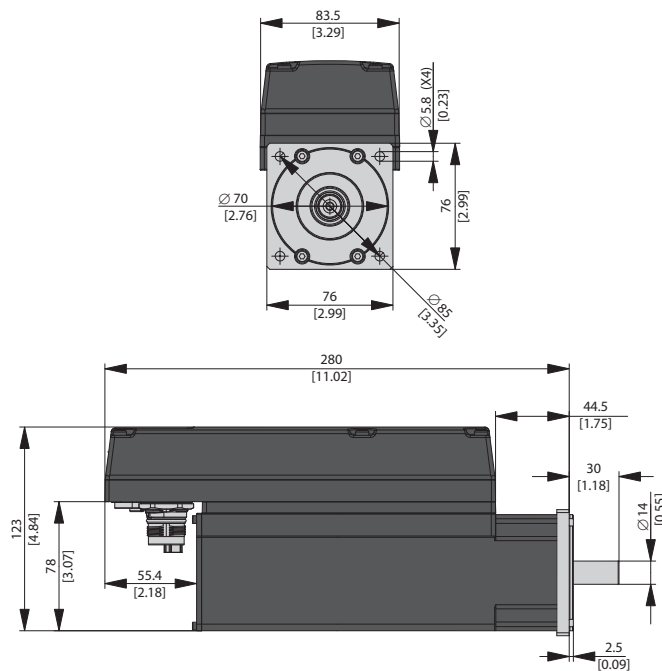

| Servo Drive ISD® 510 | Dimensions [mm] | | | | | | | | | |
|-------------------------|-----------------|----|----|-------|------|----|----|-----|----|-----|
| | A | B | C | D | E | F | G | H | I | J |
| Size 1 (1.5 Nm) | 85 | 70 | 76 | 280 | 39.5 | 30 | 14 | 2.5 | 70 | 115 |
| Size 2 (2.1 Nm) | 100 | 80 | 84 | 252.5 | 15 | 40 | 19 | 3.0 | 84 | 129 |
| Size 2 (2.9 Nm) | 100 | 80 | 84 | 281.5 | 44.5 | 40 | 19 | 3.0 | 84 | 129 |
| Size 2 (3.8 Nm) | 100 | 80 | 84 | 310.5 | 73.5 | 40 | 19 | 3.0 | 84 | 129 |

Danfoss Drives, Ulsnaes 1, DK-6300 Graasten, Denmark, Tel. +45 74 88 22 22, Fax +45 74 65 25 80, www.danfoss.com/drives, E-mail: info@danfoss.com

Danfoss can accept no responsibility for possible errors in catalogues, brochures and other printed material. Danfoss reserves the right to alter its products without notice. This also applies to products already on order provided that such alterations can be made without subsequential changes being necessary in specifications already agreed. All trademarks in this material are property of the respective companies. Danfoss and the Danfoss logotype are trademarks of Danfoss A/S. All rights reserved.