

Installation Guide

Proportional valve

type PVG 100

157R9961

157R9961

Installation an plug orientation

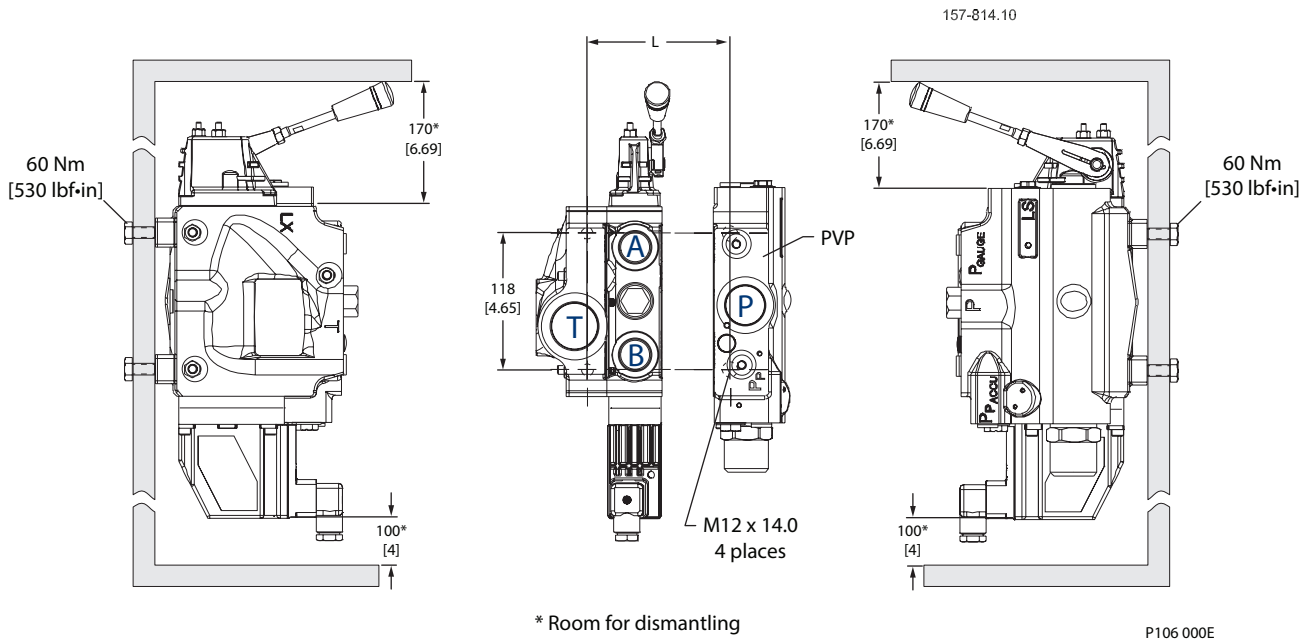
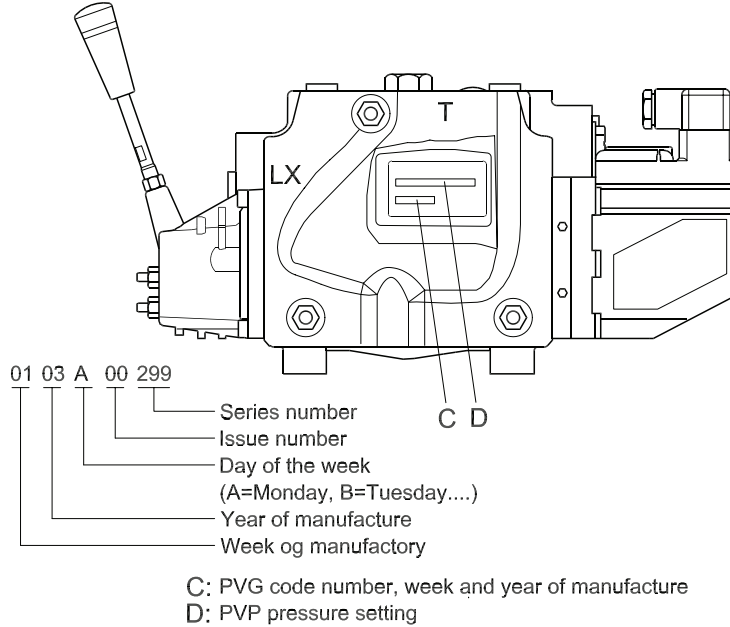

Modul og PVB	1	2	3	4	5	6	7	8
L mm	80.0	128.0	176.0	224.0	272.0	320.0	368.0	416.0
L [in]	[3.15]	[5.04]	[6.93]	[8.82]	[10.71]	[12.60]	[14.49]	[16.38]

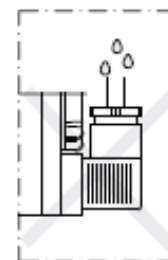

DIN mounting orientation

Standard, Oil flow direction and setting of max flow PVM on the A-port side

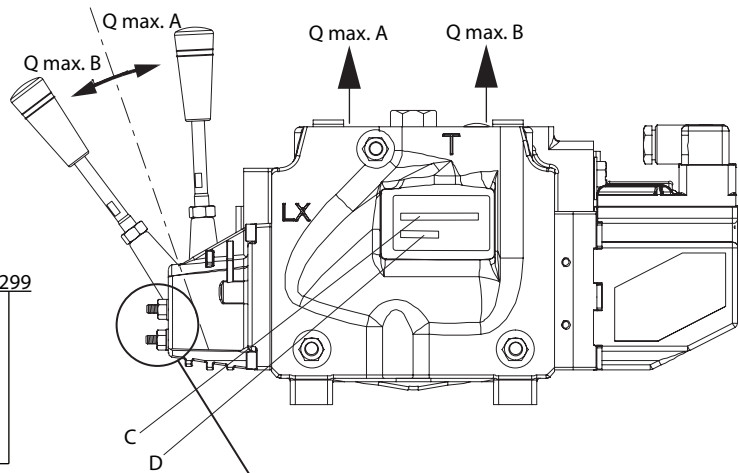
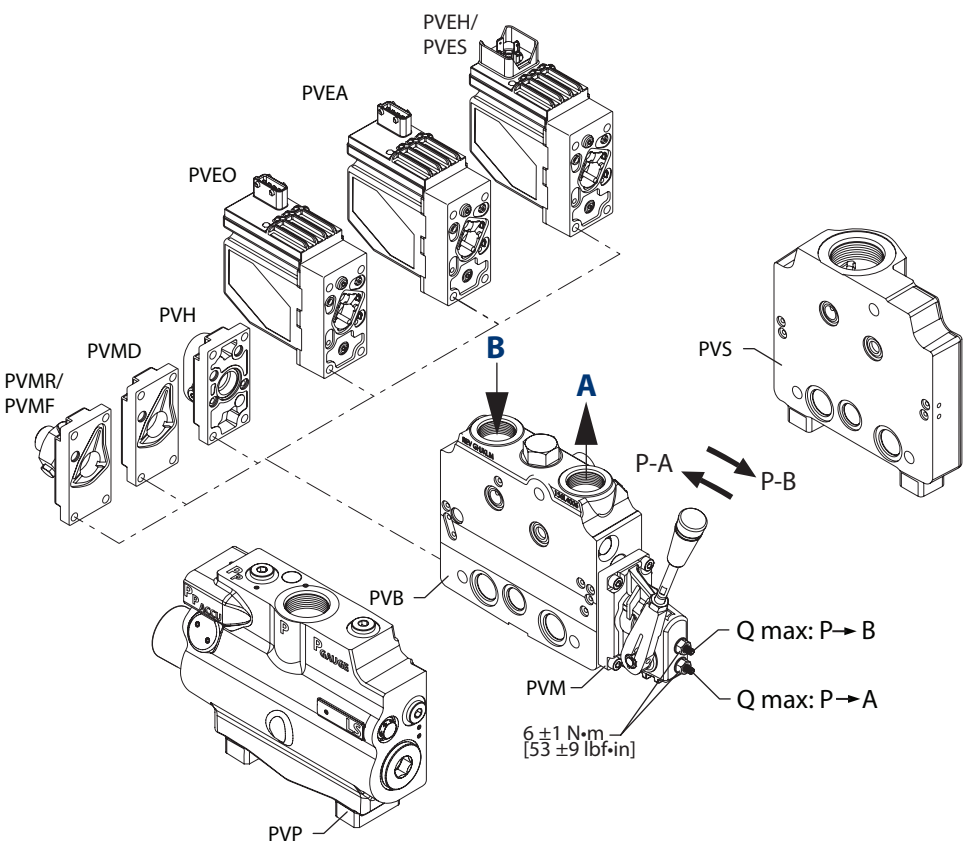

01 03 A 00 0299
 Week of manufacture — 01
 Year of manufacture — 03
 Day of the week — A
 (A = Monday, B = Tuesday ...)
 Issue number — 00
 Series number — 0299

C: PVG code number, week and year of manufacture
 D: PVP pressure setting

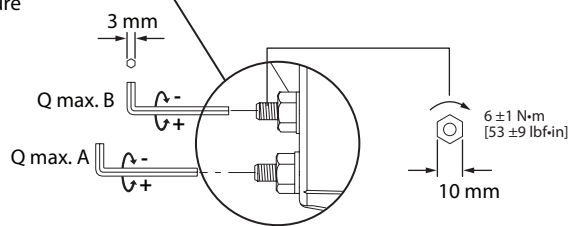

E101 279E

**Connections, pump side modul, PVP
basic module PVB end plate, PVS**

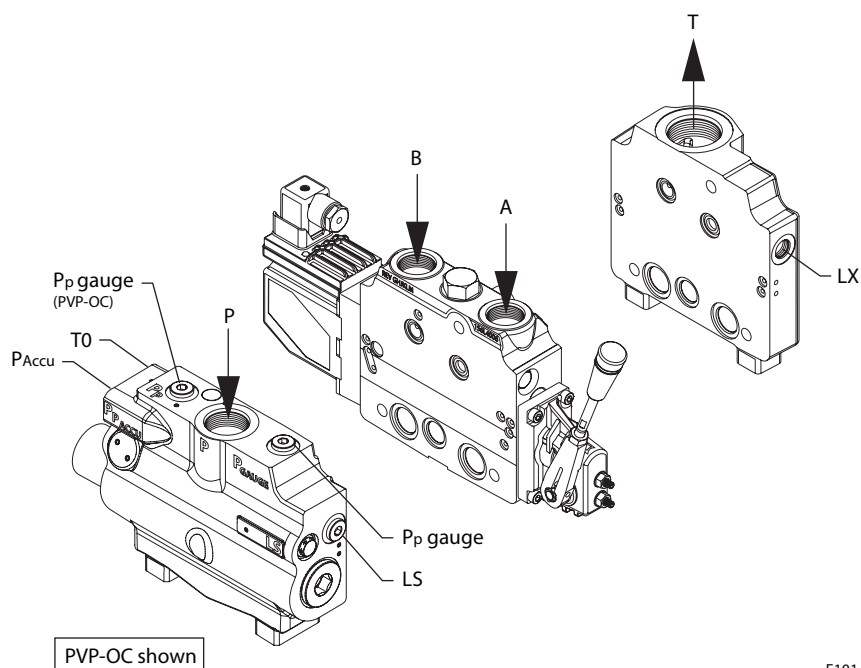

E101 285E

Maximum tightening torque

Connection	P		A/B	LS, LX, T0 Gauge: P, Pp, Pp Accum.	T	
	G 3/4	G 1			G 1	G 1 1/4
BSPP port connection	G 3/4	G 1	G 3/4	G 1/4	G 1	G 1 1/4
With steel washer	210 Nm 1850 lbf-in	330 Nm 2920 lbf-in	210 Nm 1850 lbf-in	40 Nm 350 lbf-in	330 Nm 2920 lbf-in	540 Nm 4780 lbf-in
With copper washer	50 Nm 445 lbf-in	70 Nm 620 lbf-in	50 Nm 445 lbf-in	20 Nm 180 lbf-in	70 Nm 620 lbf-in	100 Nm 885 lbf-in
With aluminum washer	110 Nm 970 lbf-in	150 Nm 1330 lbf-in	110 Nm 970 lbf-in	30 Nm 270 lbf-in	150 Nm 1330 lbf-in	240 Nm 2125 lbf-in
With cutting edge	210 Nm 1850 lbf-in	330 Nm 2920 lbf-in	210 Nm 1850 lbf-in	40 Nm 350 lbf-in	330 Nm 2920 lbf-in	540 Nm 4780 lbf-in
UNF port connection	1 1/16 in-12	1 5/16 in-12	1 1/16 in-12	9/16 in-18	1 5/16 in-12	1 5/8 in-12
With O-ring	120 Nm 1040 lbf-in	160 Nm 1420 lbf-in	120 Nm 1040 lbf-in	40 Nm 350 lbf-in	160 Nm 1420 lbf-in	320 Nm 2830 lbf-in

Rated pressure

Product	Rated pressure
PVG 100	350 bar [5076 psi]
PVG 100 w. HIC steel	350 bar [5076 psi]
PVG 100 w. HIC aluminium	210 bar [3046 psi]
PVG 100/32 w. PVBZ	210 bar [3046 psi]
PVG 100/32 w. PVS	300 bar [4351 psi]
PVG 100/32 w. PVS1	350 bar [5076 psi]

Installation of lever

Base with an angle of 22.5°

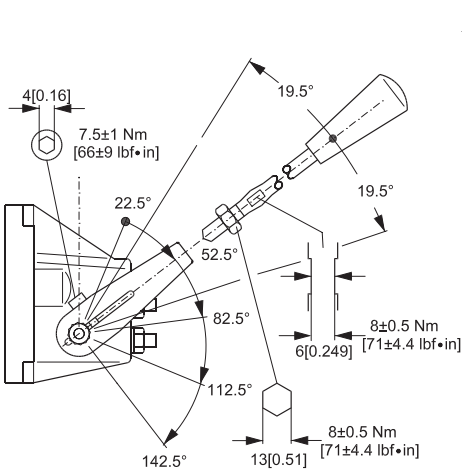

Base with an angle of 37.5°

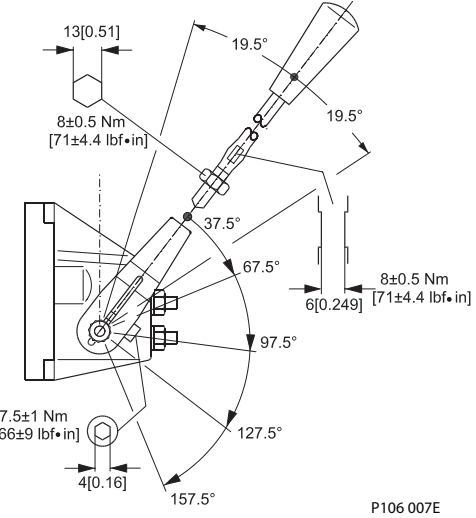

P106 007E

Pressure setting

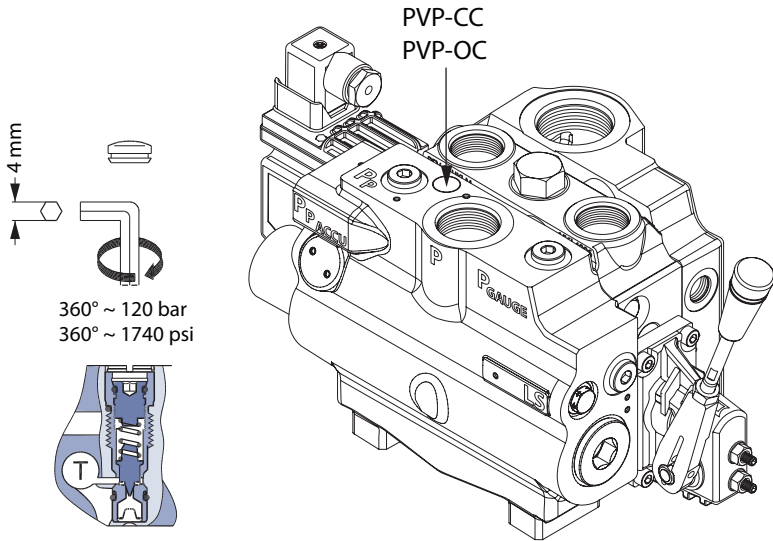

P106 008E

PVEH/PVEM/PVES

Adjustment of PVE when max. lever travel is exceeded (PVE is factory preset)

Check maximum lever travel in neutral position.

1. Make sure the system is supplied with hydraulic power.
2. Connect supply voltage (U_{DC}) (Signal voltage $0.5 \cdot U_{DC}$) or cut off the signal voltage (U_s) on pin 2.

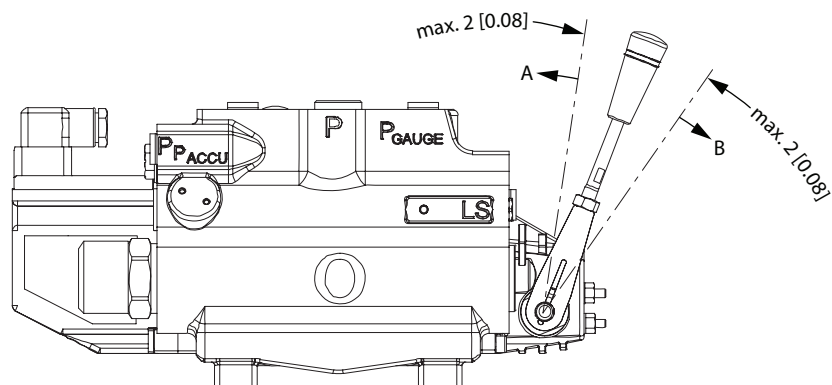

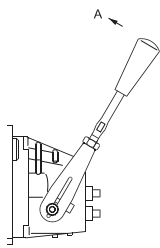
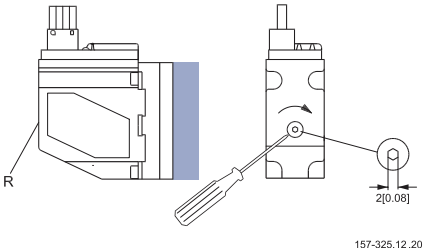
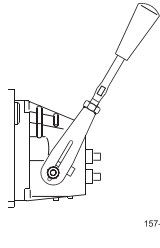
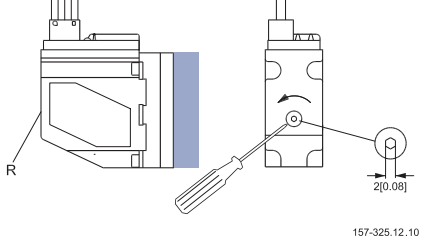
Lever travel exceeded in	PVG 100	Direction of rotation for adjustment of position transducer
Direction A	 <p>157-164.11.10</p>	 <p>157-325.12.20</p>
Direction B	 <p>157-164.10.20</p>	 <p>157-325.12.10</p>

Turn of transducer	Movement of lever
1/4	1.5 mm [0.06 in]
1/2	3.0 mm [0.12 in]
3/4	4.5 mm [0.18 in]

**Installation and technical data for PVPP
(Solenoid operated pilot drain)**

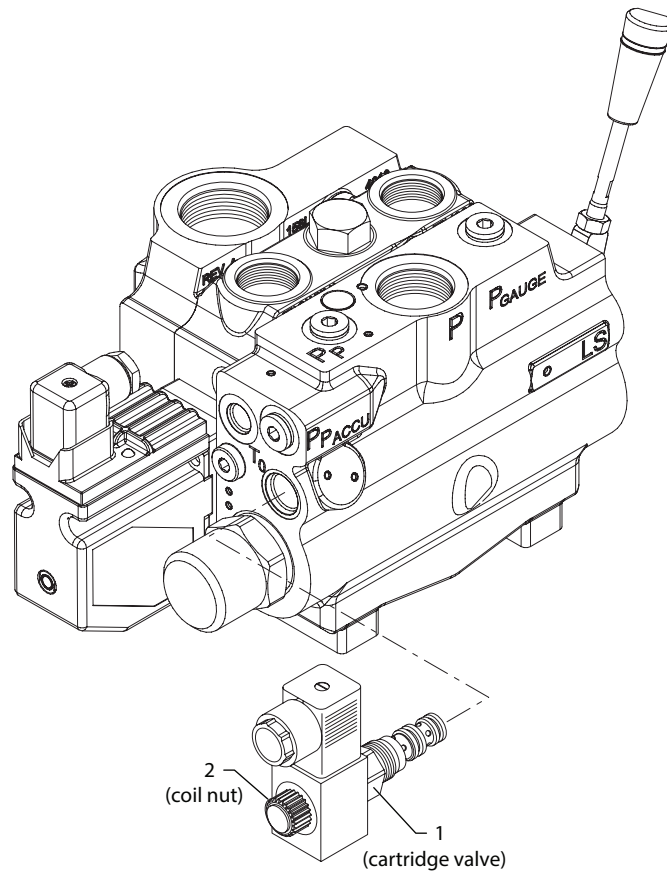

Position	Across flats	Max. tightening torque
1	24 mm [0.94 in]	45 Nm [400 lbf-in]
2	20 mm [0.79 in]	5 Nm [44 lbf-in]

Max. operation pressure	350 bar [5076 bar]		
Max. coil surface temperature	155°C [311°F]		
Rated voltage	12 V \equiv	24 V \equiv	
Current consumption	22°C (71,6°F) coil temperature	1.55 A	0.78 A
	110°C (230°F) coil temperature	1.00 A	0.50 A
Power consumption	22°C (71,6°F) coil temperature	19 W	19 W
	110°C (230°F) coil temperature	12 W	12 W
Max. permissible deviation from rated supply voltage	±10%		

When installing the wire remember to connect the built-in diode to the plug pins.

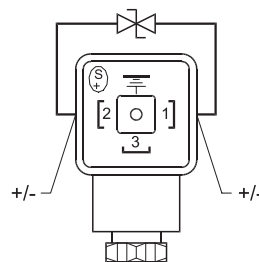

P106 004E

**Installation and technical data for PVPE
(Solenoid relief valve)**

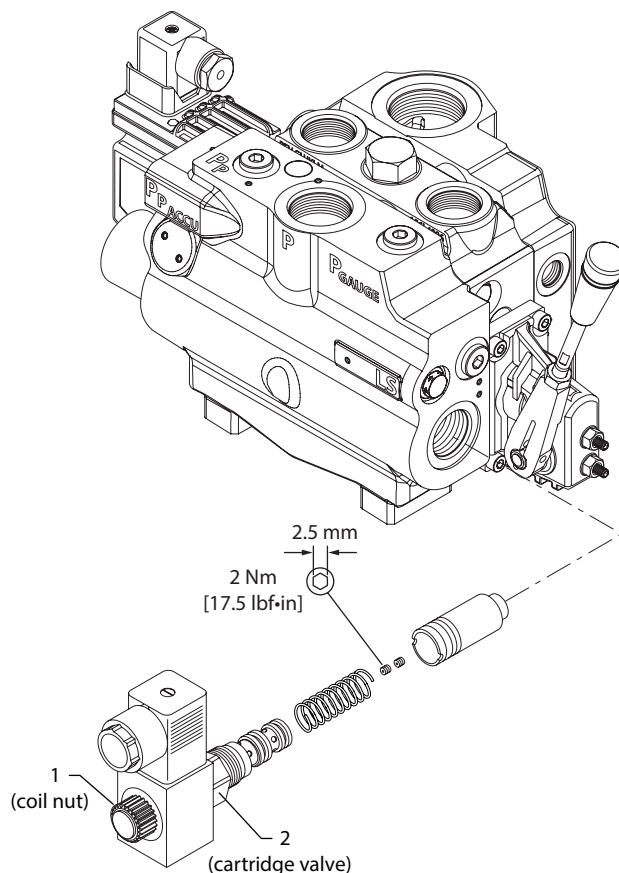

Position	Across flats	Max. tightening torque
1	22 mm [0.87 in]	5 Nm [45 lbf·in]
2	36 mm [1.42 in]	85 Nm [750 lbf·in]

Max. operation pressure	350 bar [5076 bar]		
Max. coil surface temperature	155°C [311°F]		
Rated voltage	12 V \equiv	24 V \equiv	
Current consumption	22°C (71,6°F) coil temperature	1.55 A	0.78 A
	110°C (230°F) coil temperature	1.00 A	0.50 A
Power consumption	22°C (71,6°F) coil temperature	19 W	19 W
	110°C (230°F) coil temperature	12 W	12 W
Max. permissible deviation from rated supply voltage	±10%		

When installing the wire remember to connect the built-in diode to the plug pins.

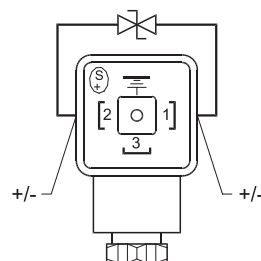

P106 288E

PVMR Disassembly

1.

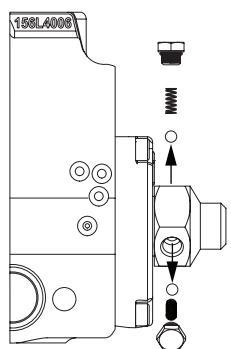

2.

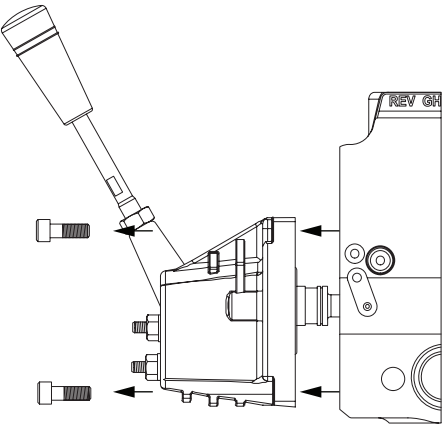

3.

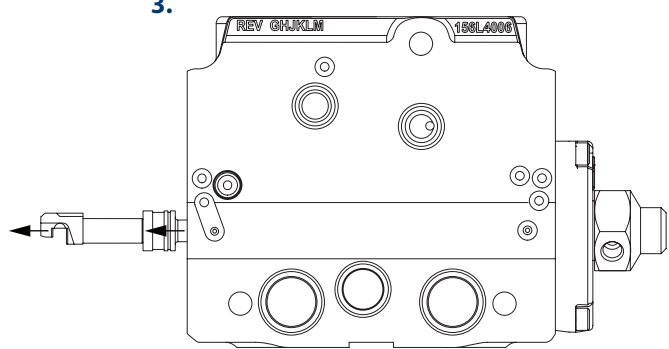

4.

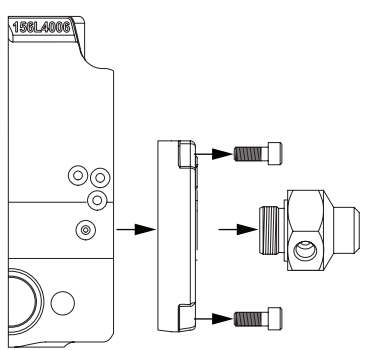

P106 005

PVMR/F Assembly

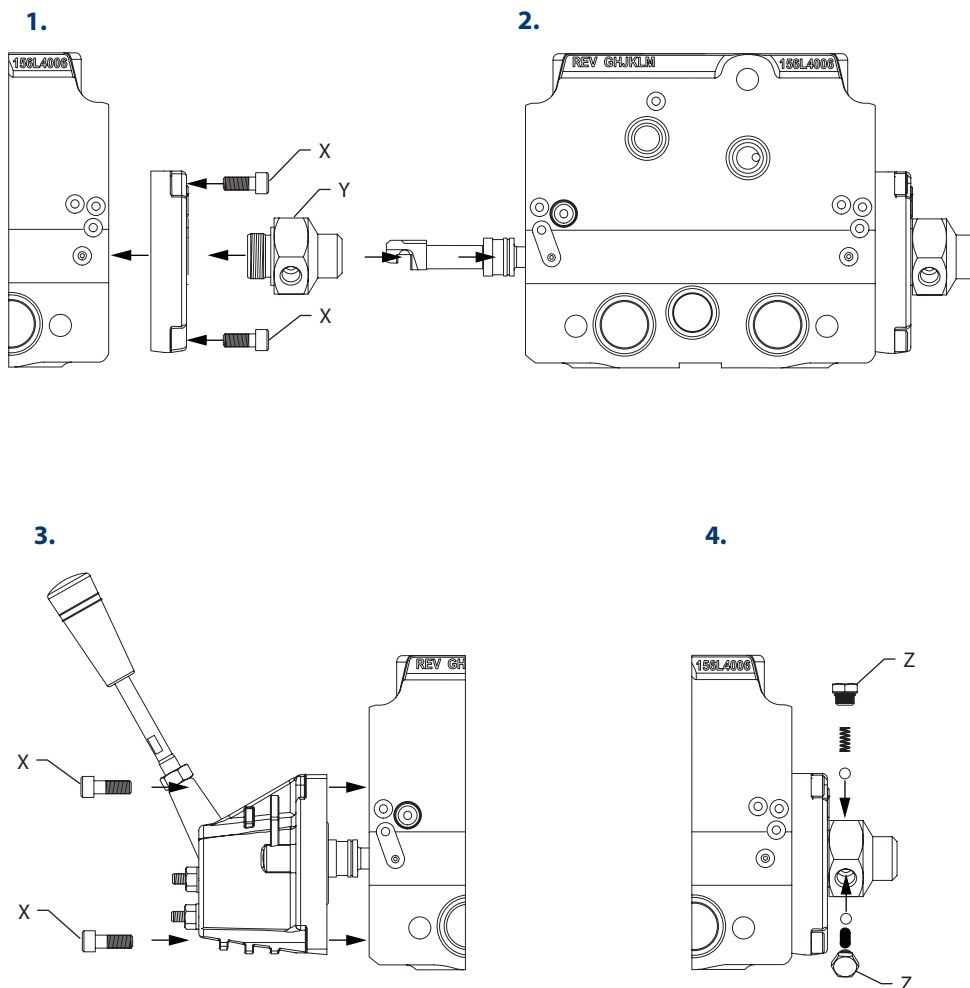

Tightening torques and widths across flats

	X	Y	Z
Width across flats	5 mm	36 mm	11 mm PVMF 19 mm PVMR
Tightening torque	8 ± 0.5 Nm [70 ± 4.5 lbf·in]	15 ± 2 Nm [135 ± 20 lbf·in]	4 ± 1 Nm [35 ± 9 lbf·in]

P106 006

Standard main spool assembly
for PVMR

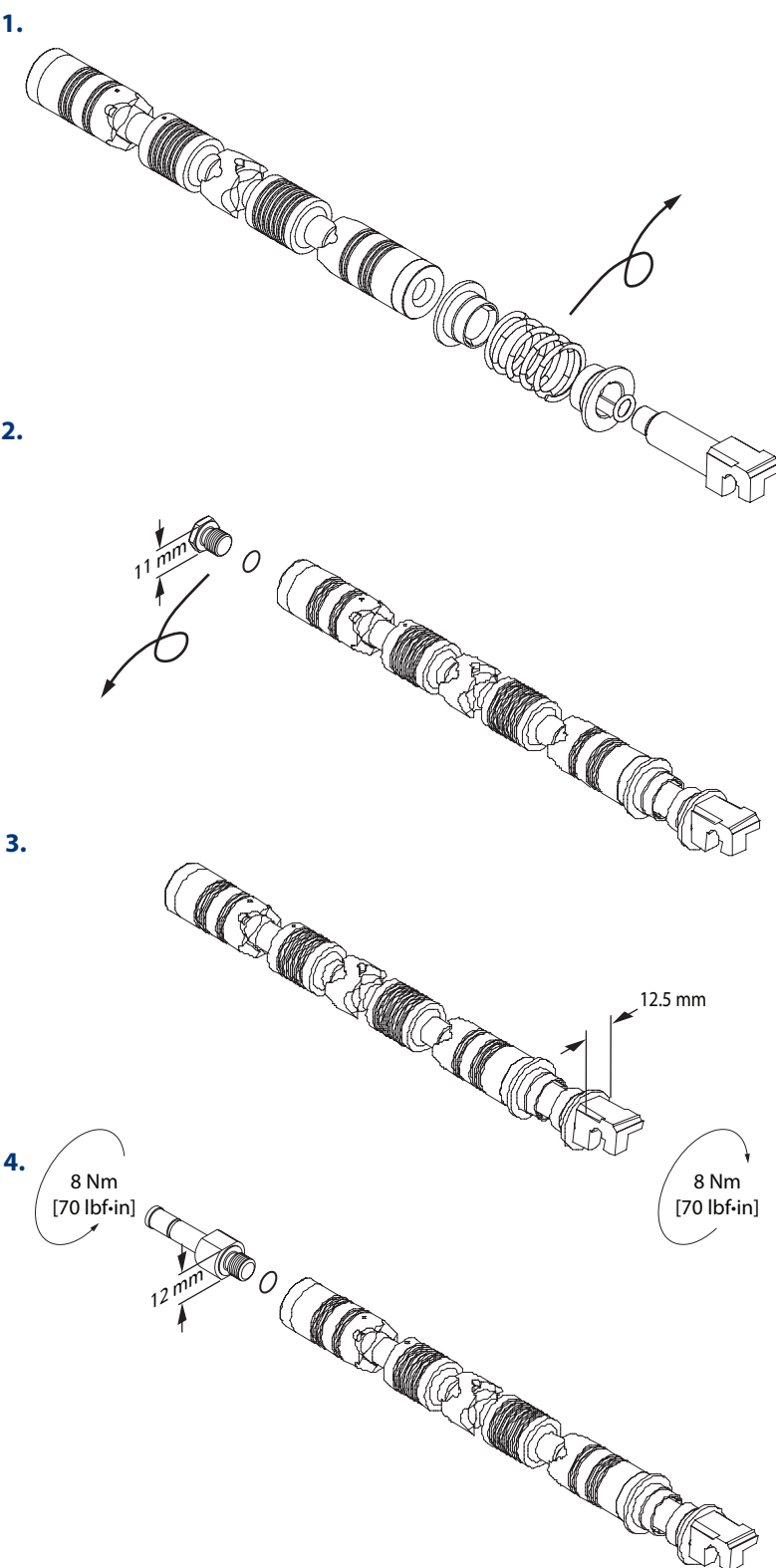

**Standard float spool assembly
for PVMR**

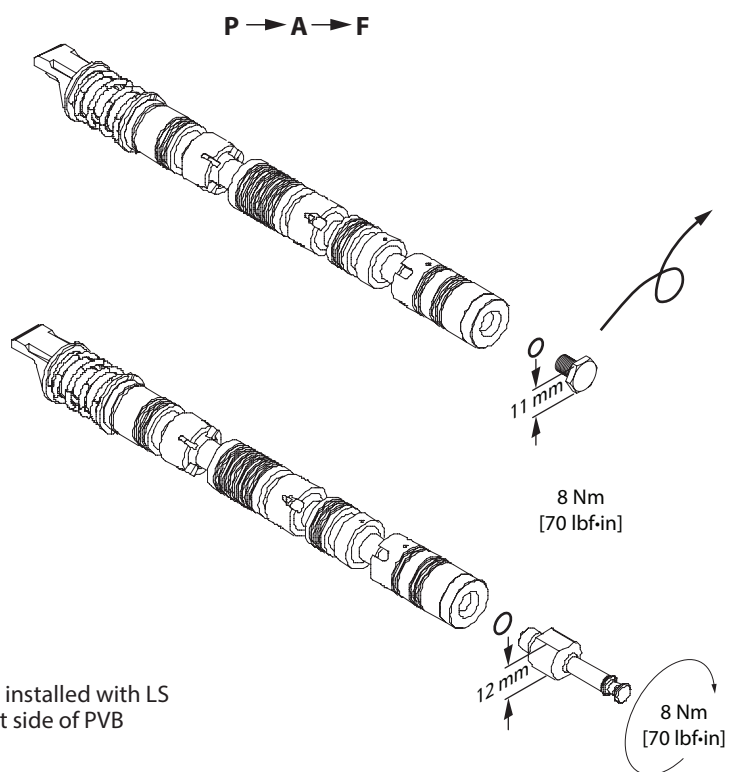

Not:
Spools must be installed with LS
holes on 'B' port side of PVB

E101 290E

