

Installation guide

Service thermostats

Type 077B7

077R0702

077R0702

Service thermostats 077B7060 - Commercial Refrigerators

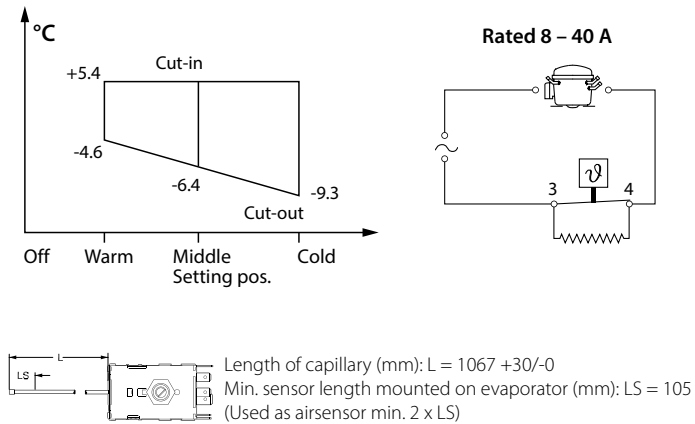

Service thermostats 077B7061 - Commercial Refrigerators

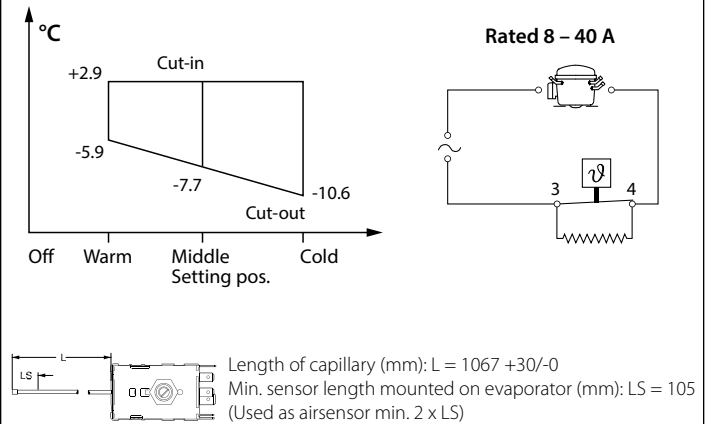

Service thermostats 077B7062 - Commercial Refrigerators

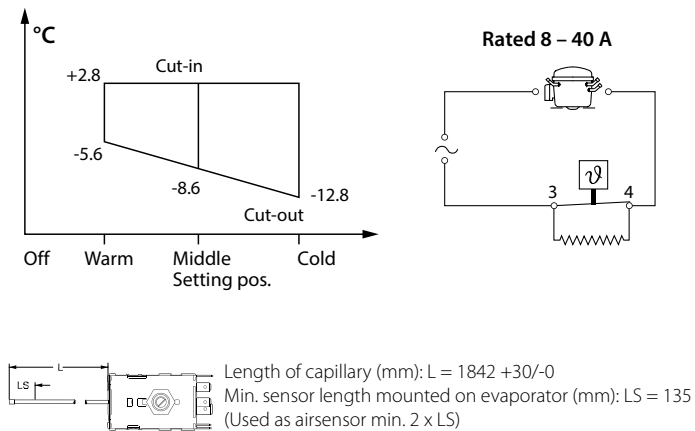

Service thermostats 077B7063 - Commercial Refrigerators

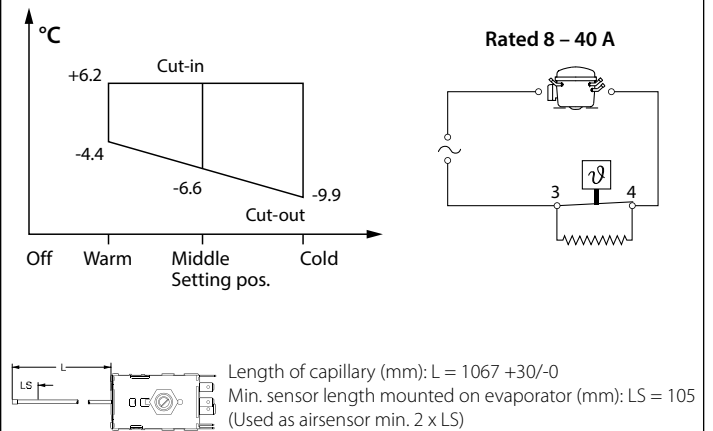

Service thermostats 077B7064 - Commercial Refrigerators

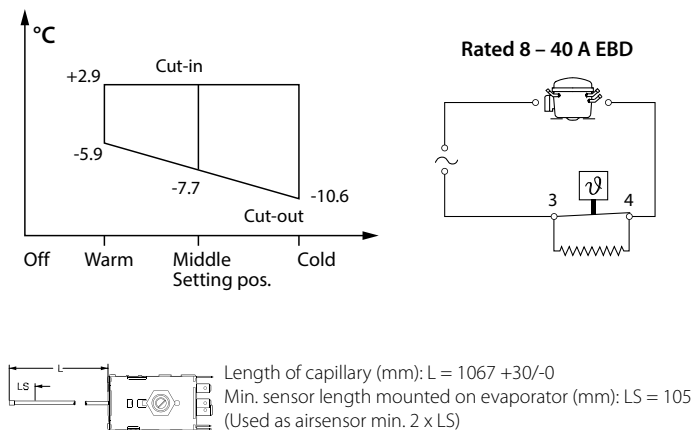

Service thermostats 077B7065 - Commercial Refrigerators

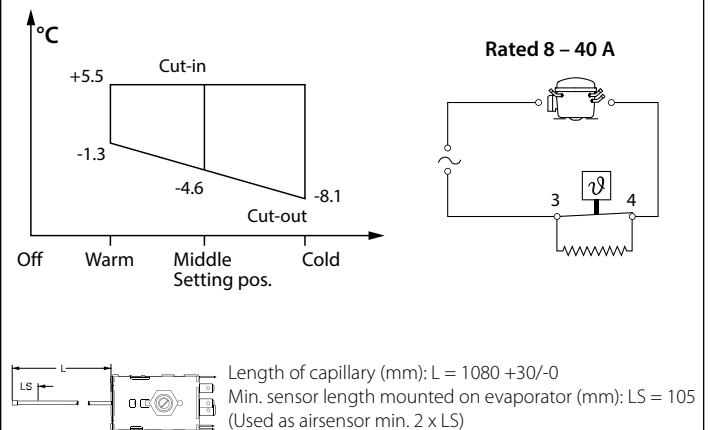

Service thermostats 077B7066 - Ice-cream cabinets and freezers without signal

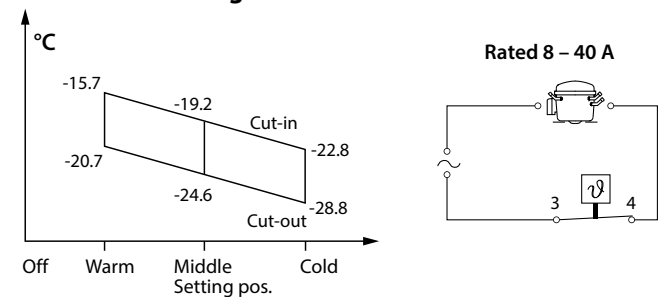

Length of capillary (mm): $L = 622 + 30/-0$
(Airsensor)

Service thermostats 077B7067 - Commercial Refrigerators

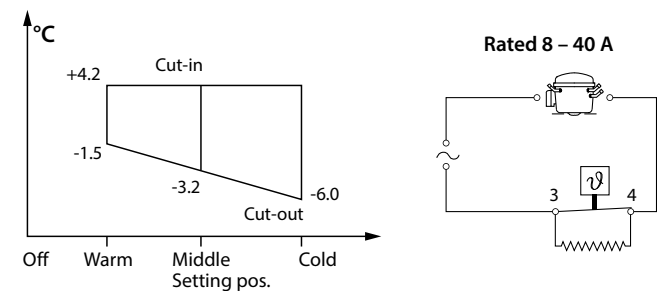

Length of capillary (mm): $L = 1087 + 30/-0$
Min. sensor length mounted on evaporator (mm): $LS = 110$
(Used as airsensor min. $2 \times LS$)

Service thermostats 077B7068 - Ice-cream cabinets and freezers without signal

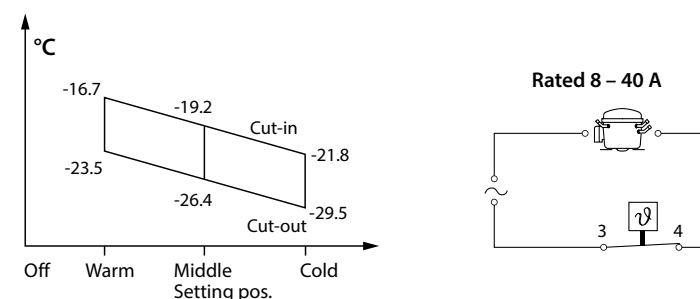

Length of capillary (mm): $L = 623 + 30/-0$
(Airsensor)

Accessories for

077B7060
077B7061
077B7062
077B7063
077B7064
077B7065
077B7067

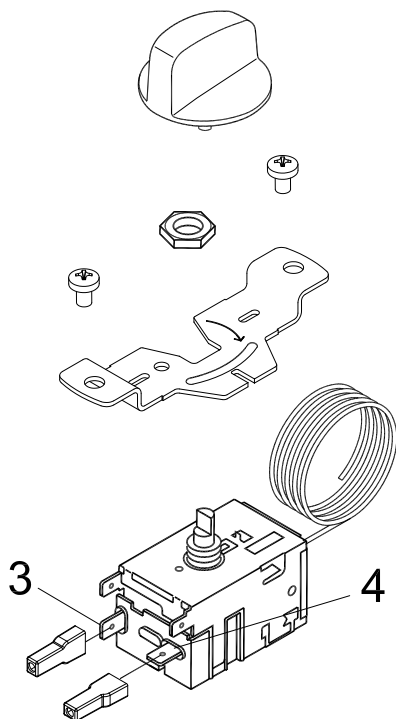

Accessories for

077B7066
077B7068

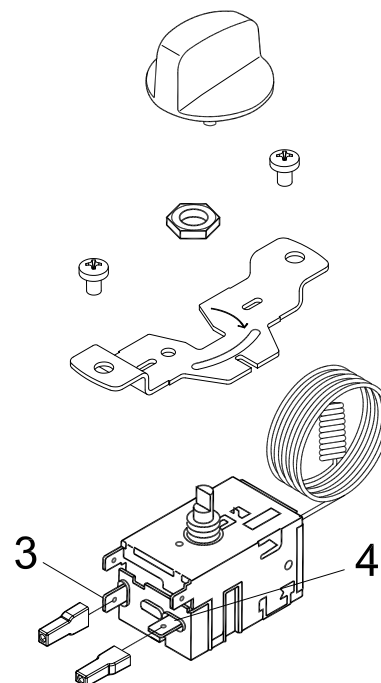

The 077B....EBD, 077B....L EBD can be applied on systems with R290 and R600a as the working fluid.
For countries where safety standards are not an indispensable part of the safety system Danfoss recommend the installer to get a third party approval of the system containing flammable refrigerant.

Note: All temperatures at 760 mm Hg

Danfoss can accept no responsibility for possible errors in catalogues, brochures and other printed material. Danfoss reserves the right to alter its products without notice. This also applies to products already on order provided that such alterations can be made without consequential changes being necessary in specifications already agreed.
All trademarks in this material are property of the respective companies. Danfoss and the Danfoss logotype are trademarks of Danfoss A/S. All rights reserved.