

Installation Guide

Solenoid valves

EVRAT 10, 15, 20

032R9669

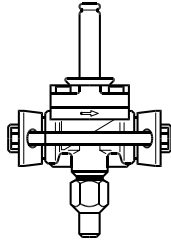

EVRAT 10

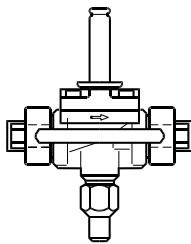

EVRAT 15, 20

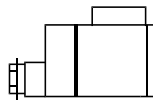

12 V a.c.

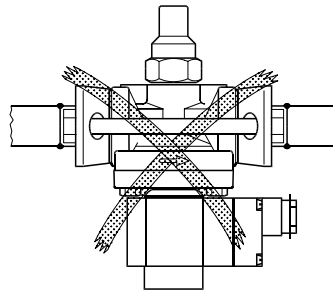
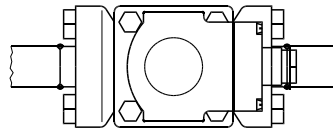
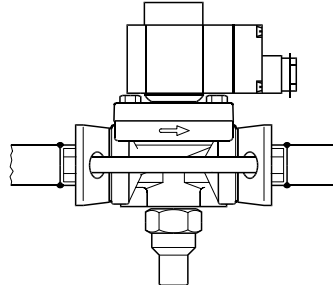

Danfoss
A32F612.10

032R9669

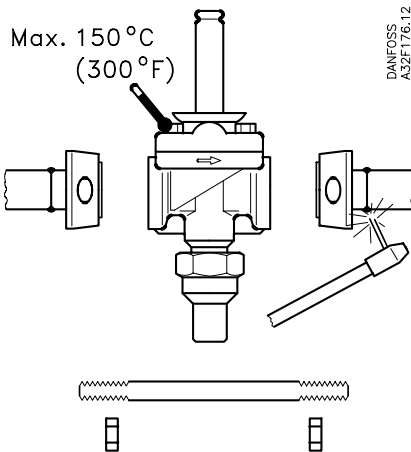

DANFOSS
A32F176.12

12 W d.c.

t max. 50 °C
(120 °F)



t min. -40 °C (-40 °F)

Min. medium temperature: EVRAT -40 °C (-40 °F)

Max. medium temperature: EVRAT 105 °C (221 °F)

Max. working pressure: PB=28 bar/ MWP 405 psig

Max. opening diff. pressure (MOPD): → 21 bar (300psig)

Danfoss
A32F613.10

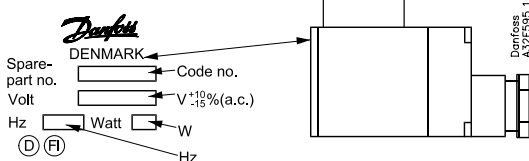

Danfoss
A32F595.10

DANFOSS
A32F176.12

Nm	kpm	ft-lbs
1.4	0.15	1

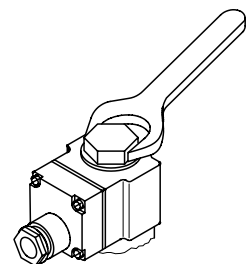
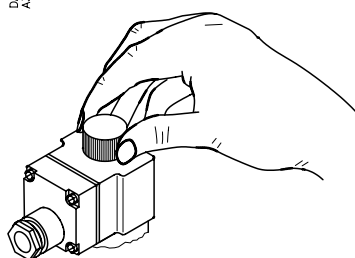

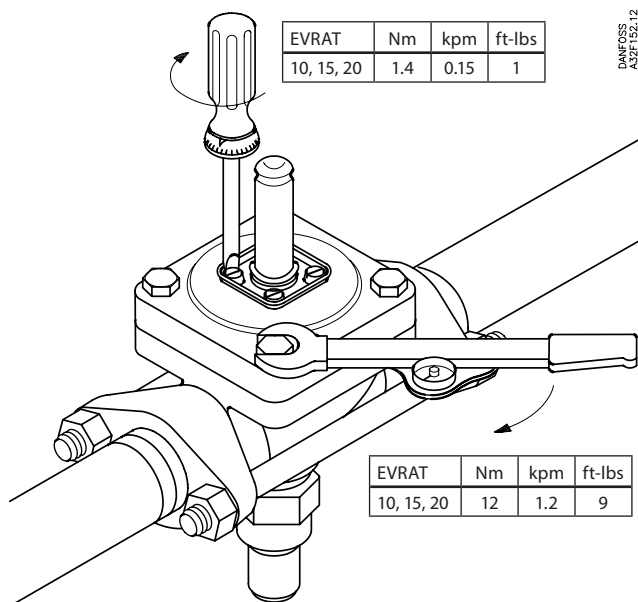

DANFOSS
A3ZF152.12



The manual opener of EVRAT 10, 15 and 20 is intended to be activated only during initial pressure testing of the refrigeration system.

After pressure testing or service-related manual forced opening of the manual opener the spindle **must** be turned fully back to back-seated position to avoid any packing gland leakage.

Furthermore it is essential that the sealing cap is properly reinstalled. This will eliminate any risk of leakage from the manual opener.

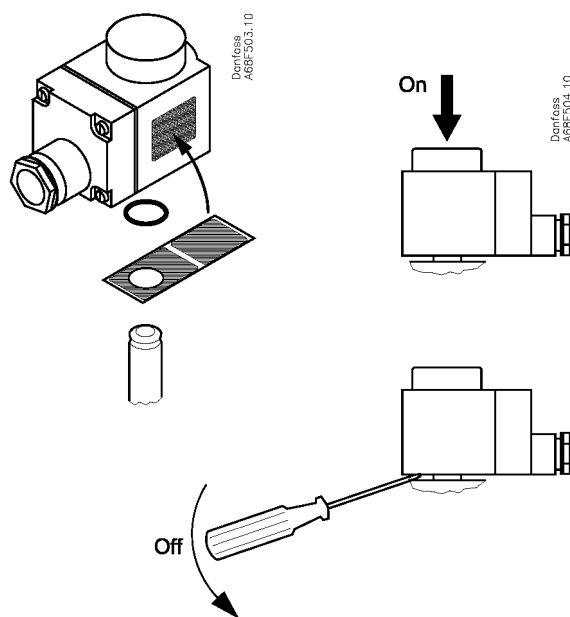

Danfoss
A68F503.10

Danfoss
A68F504.10

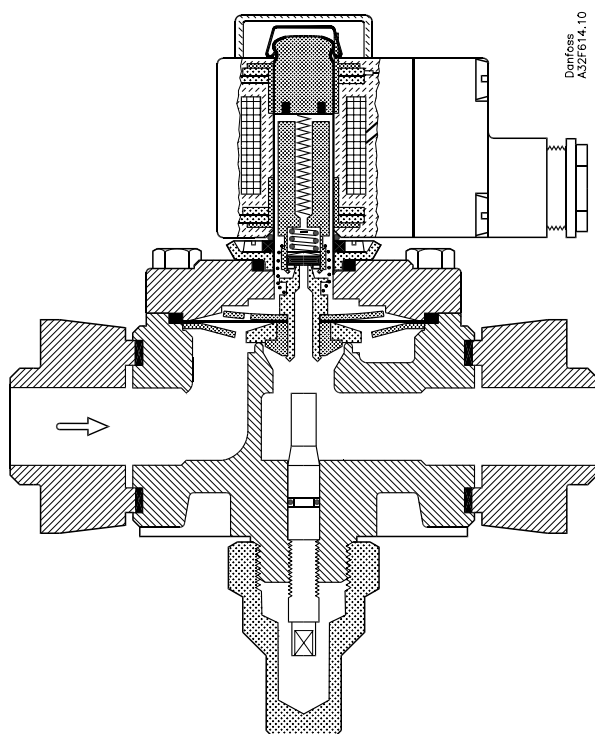

Danfoss
A3ZF614.10

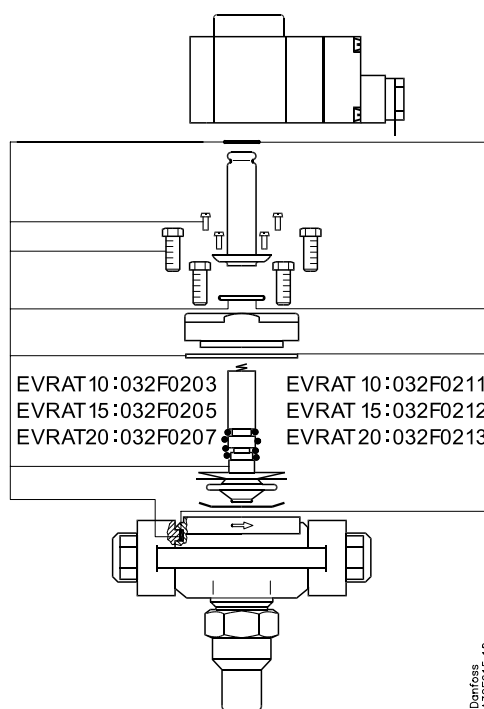

Danfoss
A3ZF615.10