

Installation guide

Solenoid valve

Type EV228BW 15-50 + Coil type BB/BE DC

132R9001

132R9001

≥ 297 Microns

1

2

3

4

5

6

7

8

9

10

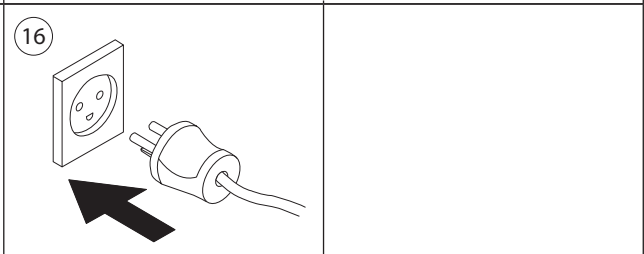
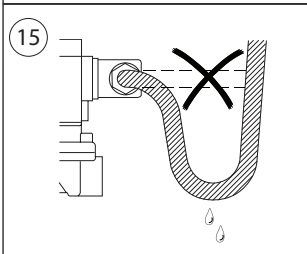
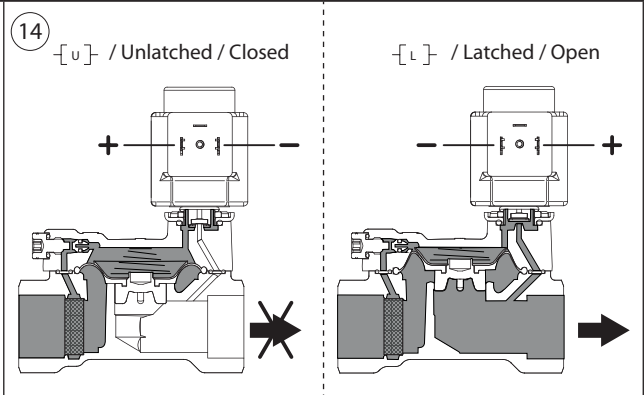
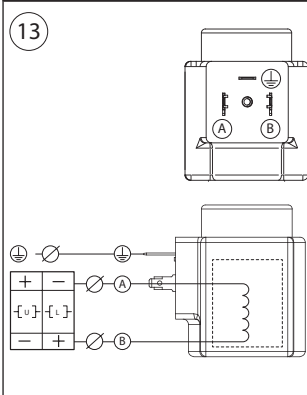
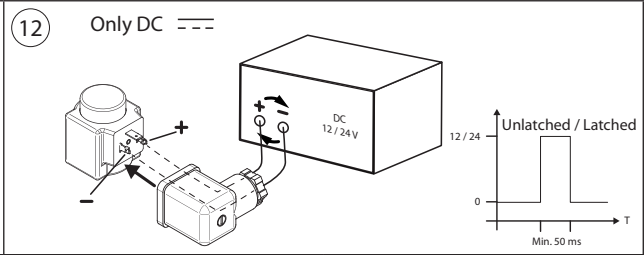
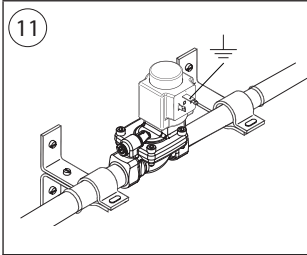

Drinking water approval						
		Valid in	Certificate no.	DN	Max. Working Pressure (MWP)	Max. Test pressure (PT)
					[bar]	[bar]
		DK, SE	SCO155-18 *)	15 - 50	10	25
*) http://publiccert.extweb.sp.se/sv/Product/List/ Wetted parts in accordance with DVGW, 4MS, KTW and W270				EN 60730-2-8		

Besök www.danfoss.se för mer tekniska data. Besøg www.danfoss.dk for flere tekniska data.
 Rendez-vous sur le site www.products.danfoss.fr pour plus de données techniques.
 Visit www.products.danfoss.com for further technical data. Para más información, visite www.products.danfoss.es