

Installation Instructions

Radiator thermostat RA 2000, universal model

Installation, temperature setting, limitation and blocking, theft protection

Installation

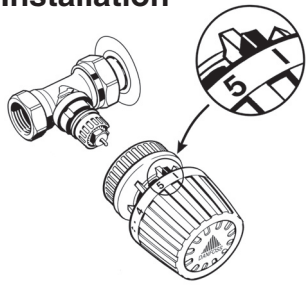

Remove the valve cover.
Check that the thermostat is
set at the factory setting of 5.

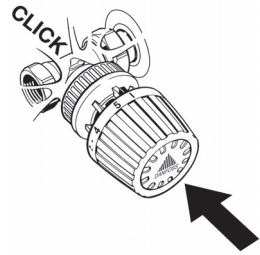

Push the thermostat firmly
onto the valve until an audible
"click" is heard.

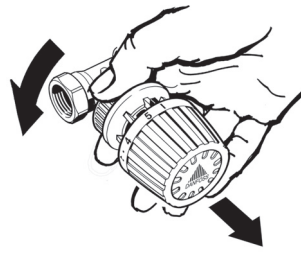

To remove the thermostat turn
the base counter-clockwise.
This will also reset the the
snap-action mechanism when
an audible "click" is heard.

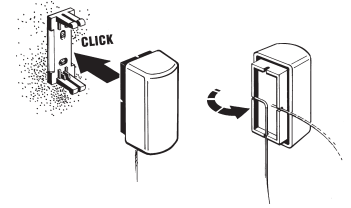

Attach the sensor bracket to
the desired location. Pull out
the required length of capillary
tube and secure to the sensor
as shown. Push the sensor
onto the base.

Mounting Operator with Built-in Sensor

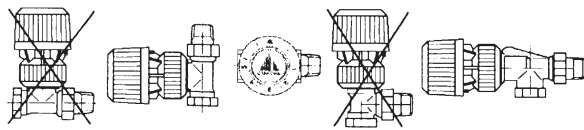

The sensor must not be in a drafty location or be covered. **Do not install above a heat source.**

Mounting Operator with Remote Sensor

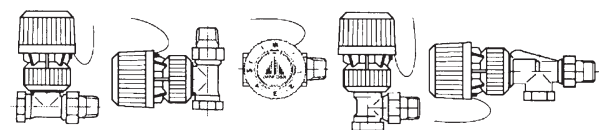

Temperature setting

45	49	57	63	68	73	79	82°F
7	9,5	14	17	20	23	26	28°C
I	*	1	2	• 3 • 4	5	I	

* = Frost protection setting

The required room temperature is
obtained by turning the thermostat
knob. The numbers on the dial cor-
respond to the approximate tem-
peratures of the scale.

The temperatures indicated are guide-
lines only. The actual room tempera-
ture will depend on structural factors
affecting the thermostats, location, etc.

Limiting and blocking the setting range

Spare limit pins (30pcs) 013G1215

Upper limit setting (max. setting)

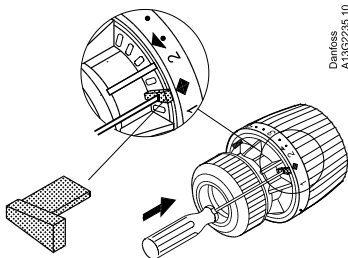

Example: Required max. value = "4"
- Set thermostat at "4"
- Remove a pin from the bottom of the
thermostat with a screwdriver and
mount it under the diamond mark on
the knob (between setting positons 1
and 2).

Lower limit setting (min. setting)

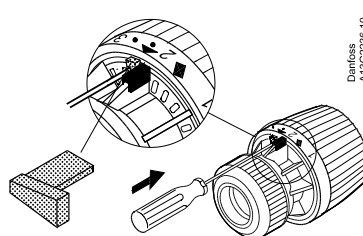

Example: Required min. value = "2"
- Set thermostat at "2"
- Remove a pin from the bottom of the
thermostat with a screwdriver and
mount it under the triangle mark on
the knob (between setting positons 2
and 3).

Locking setting

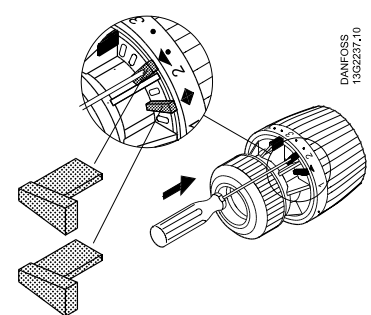

Example: Required locked value = "3"
- Set thermostat at "3"
- Remove both pins from the the ther-
mostat.
- Place one pin under the diamond mark
and the other pin under the triangle
mark.

Theft protection

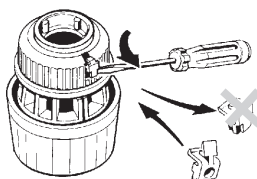

Remove the cover and install the theft
protection button, code 013G5245 (20
pcs) without pushing it all the way in.

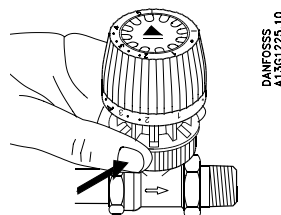

Once the thermostat is mounted on
the valve, push in the theft protection
device. The thermostat cannot be re-
moved.

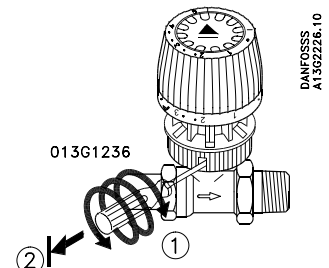

To remove the theft protection use
screwdriver 013G1236 and screw into
the hole (1). Pull out until the stop is
reached (2).