

安装指南

FHPRO-ED 压差旁通尾件

安装概览



图1

零件清单

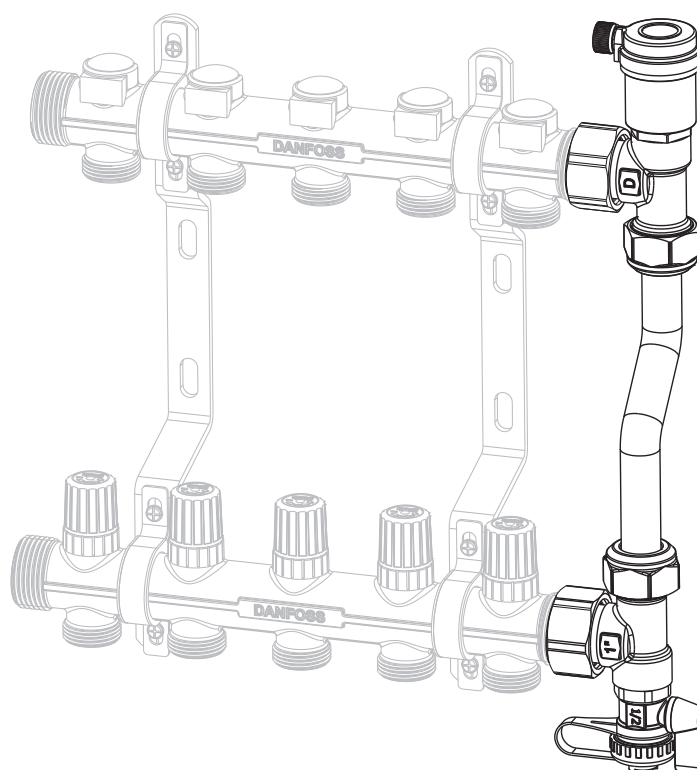
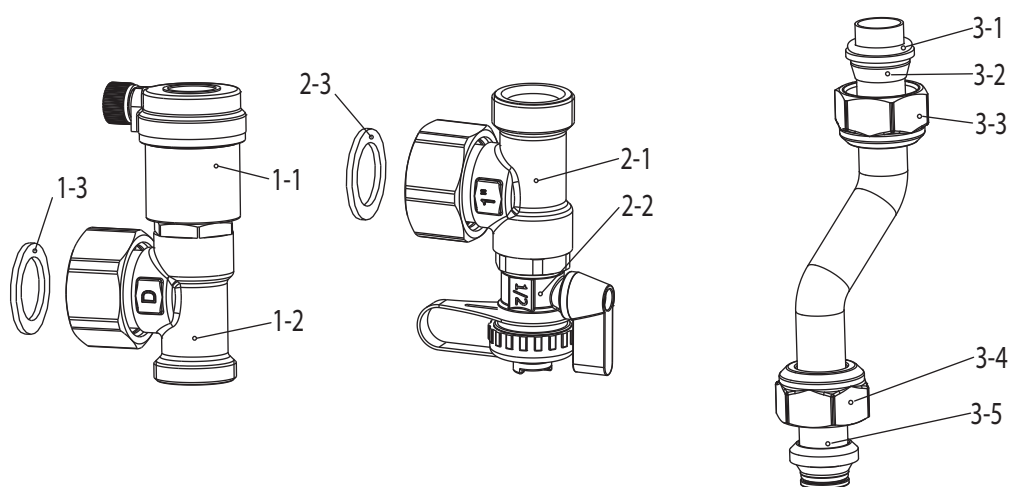

排气组件

泄水组件

连接管组件

图2

零件号	零件名称	安装位置	子零件号	子零件名称
1	排气组件	安装于分水器末端	1-1	排气阀
			1-2	排气组件本体
			1-3	垫片
2	泄水组件	安装于集水器末端	2-1	泄水组件本体
			2-2	泄水阀
			2-3	垫片
3	连接管组件	用于连接排气组件出口及泄水组件入口	3-1	O型圈
			3-2	支撑环
			3-3	螺母
			3-4	螺母
			3-5	连接管本体

注意事项

1. 请按照零件清单核对产品零部件数量。
2. 排气组件1及泄水组件2在出厂前已完成组装, 在产品安装过程中, 请勿拆卸排气阀1-1及泄水球阀2-2。
3. 检查连接管组件3上各零件的位置, 零件位置见图2。
4. 请勿反复拆装铜管组件。

安装步骤

必须按图示要求将FHPR0-ED连接至系统

1. 将排气阀组件1连接于分水器主体, 通过垫片3密封, 进口A和出口B方向见图3。
2. 将泄水阀组件2连接于集水器主体, 通过垫片3密封, 进口C和出口D方向见图3。
3. 将铜管E端插入排气阀组件出口B, 调整铜管位置, 见图3。
4. 将铜管F端插入泄水阀组件入口C, 见图3。
5. 依次拧紧螺母3-3和3-4, 见图1和2。



图3

丹佛斯自动控制管理（上海）有限公司
Heating Segment • heating.danfoss.cn • +86 21 61513000 • 电子邮件: heating@danfoss.com

Danfoss公司对样本、小册子和其他印刷资料里可能出现的错误不负任何责任。恕Danfoss公司有权改变其中产品而不事先通知。这同样适用于已经订了货的产品, 只要 该变更不会造成已商定的必要的技术规格的改变。本材料中所有的商标为相关公司的财产。Danfoss 和所有 Danfoss的标志是Danfoss公司A/S(丹佛斯总部)的商标。丹佛斯公司保留全部所有权。

Installation Guide

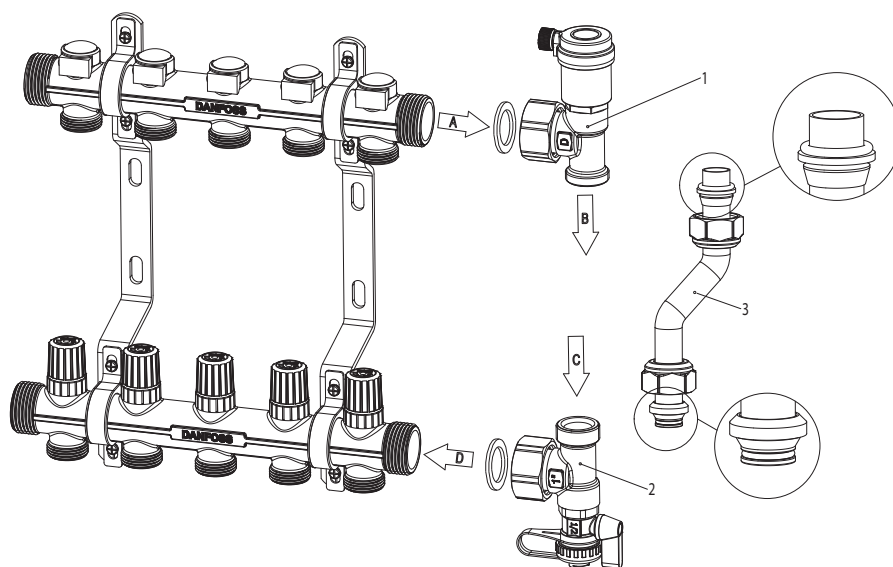
FHPRO-ED DP Bypass End Piece

Installation overview

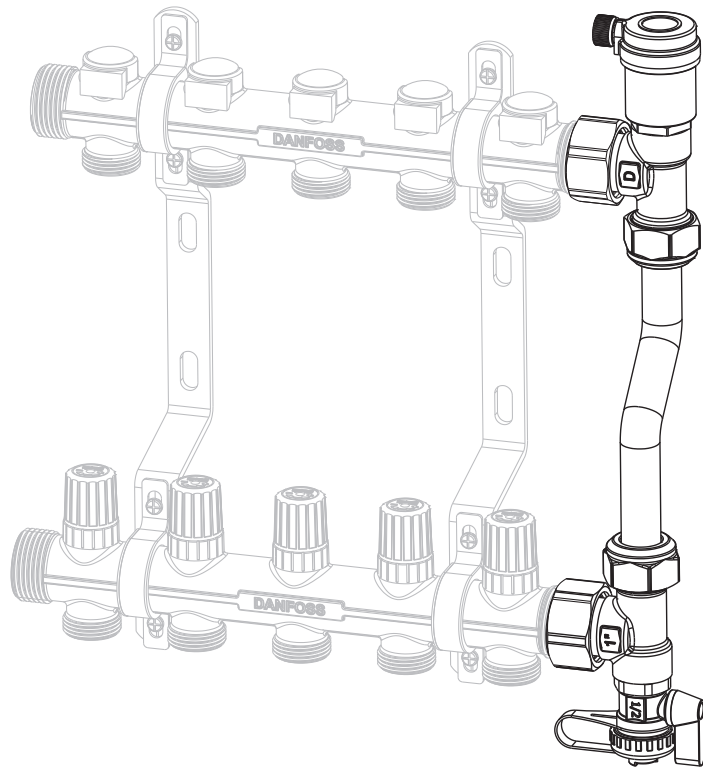

Fig. 1

Part list

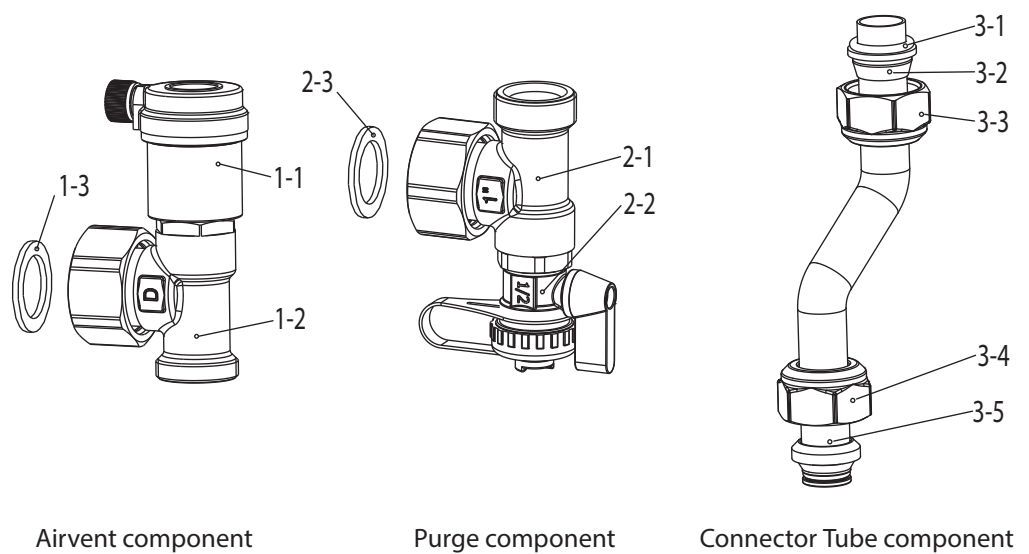

Fig. 2

Part NO.	Part name	Installation position	Sub-part NO.	Sub-part name
1	Airvent component	Mounted on the end of manifold supply pipe	1-1	Airvent valve
			1-2	Body of airvent component
			1-3	Gasket
2	Purge component	Mounted on the end of manifold return pipe	2-1	Body of purge component
			2-2	Purge valve
			2-3	Gasket
3	Connector Tube component	As a connector between outlet of airvent component and inlet purge component	3-1	O-ring
			3-2	Support ring
			3-3	Nut
			3-4	Nut
			3-5	Connector tube

Notice

1. Check the components quantity according to part list.
2. Airvent component 1 and purge component 2 are assembled in factory. Please do not tear down the airvent valve 1-1 and purge valve 2-2 during the product installation.
3. Checked each part position on the connector tube component 3, the parts position shown in fig.2.
4. Please do not assemble and disassemble repeatedly.

Installation procedure

The FHPRO-ED must be connected to a system according to the illustrations.

1. Mounted airvent component 1 on manifold supply pipe, sealing by gasket 3, direction of inlet A and outlet B as shown in figure 3.
2. Mounted purge component 2 on manifold return pipe, sealing by gasket 3, direction of inlet C and outlet D as shown in figure 3.
3. Insert connector tube end E into airvent component outlet B and adjust copper tube position, as shown in figure 3.
4. Insert connector tube end F into purge component inlet C, as shown in figure 3.
5. Tighten nuts 3-3 and 3-4 sequentially, as shown in figure 1 and 2.

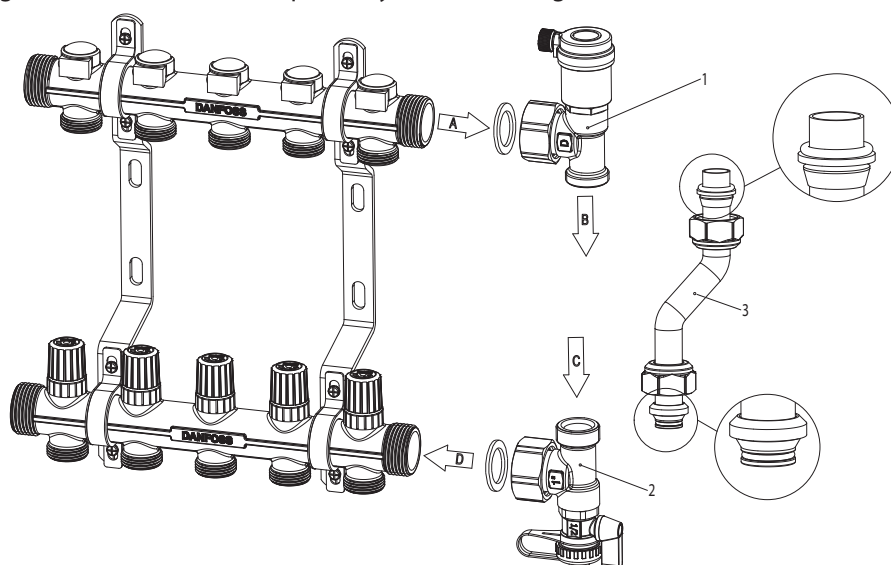

Fig. 3

Danfoss A/S

Heating Segment • heating.danfoss.com • +45 7488 2222 • E-Mail: heating@danfoss.com

Danfoss can accept no responsibility for possible errors in catalogues, brochures and other printed material. Danfoss reserves the right to alter its products without notice. This also applies to products already on order provided that such alterations can be made without consequential changes being necessary in specifications already agreed. All trademarks in this material are property of the respective companies. Danfoss and all Danfoss logotypes are trademarks of Danfoss A/S. All rights reserved.