

Operating Guide

NovoCon® S CO6, Energy, I/O - High Accuracy Actuator

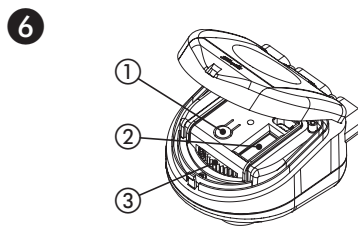

Calibration:
Press button ① until two LED's are turned on
DIP switch: ②
Manual override:
Adjust wheel ③

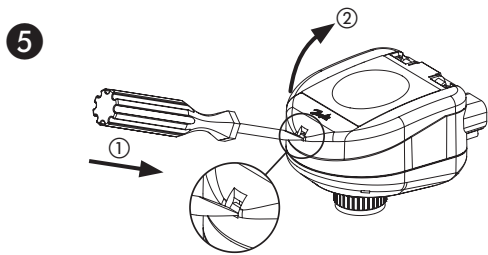
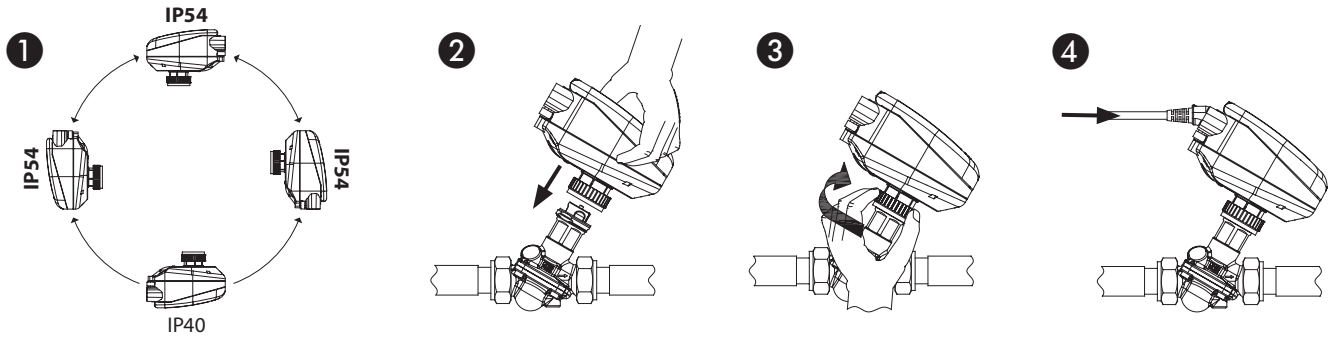
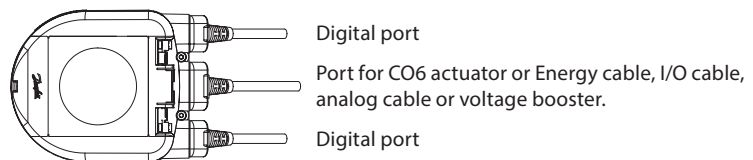

NovoCon® digital cable

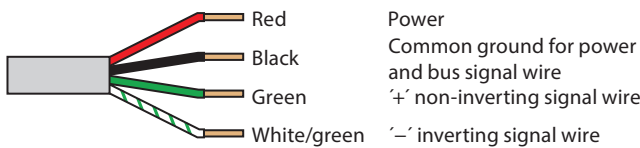

NovoCon® analog cable

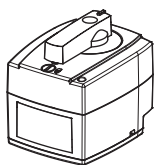

Actuator NovoCon® ChangeOver⁶

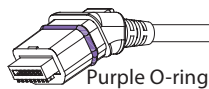

Actuator NovoCon® ChangeOver⁶ Energy

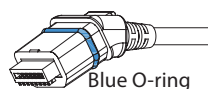

Actuator NovoCon® ChangeOver⁶ Flexible



NovoCon® Energy cable

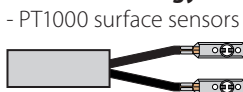

NovoCon® Energy cable



NovoCon® I/O cable

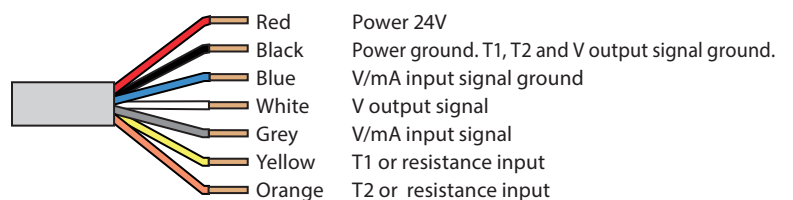

NovoCon® S CO6, Energy, I/O - High Accuracy Actuator

8

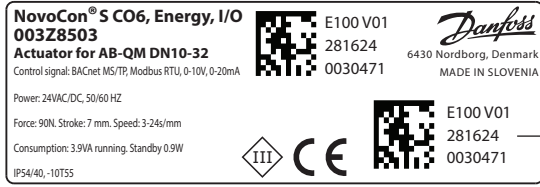

Serial number can be removed from the NovoCon® S and added to installation drawing.



Device Object Instance Number

9

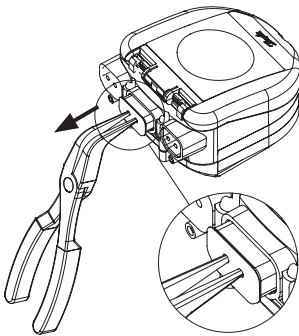

10

DIP Switch

1	2	3	4	5	6	7	8	9	10
							ON		
							OFF		

DIP Switches 1 to 7 are used to assign the MAC address manually. Default MAC address assignment method is Auto MAC addressing for BACnet MS/TP and DIP Switches for Modbus RTU.

For termination of last unit on the field bus, turn DIP Switch 8 ON.

Dip switch 9 is not used.

Dip switch 10 is used to select between BACnet MS/TP (OFF=Default) and Modbus RTU (ON).

When the protocol is changed on DIP Switch 10, a power cycle is required.

11

Presettings

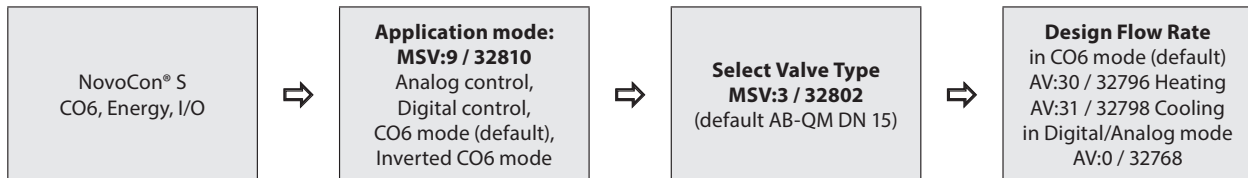

12

Safety Note

To avoid injury and damage to persons and devices, it is absolutely necessary these instructions are carefully read and observed prior to assembly and commissioning. Necessary assembly, start-up, and maintenance work must be performed only by qualified, trained and authorised personnel. Switch off the power line before wiring the actuator.

Safety Note

Connect via safety isolating transformer. Galvanic separations shall be provided for segments crossing buildings.

Safety Note

Always follow the local disposal regulations.