

TLX7KK

High Energy-optimized Compressor

R600a

220-240V 50Hz

Data Sheet (Replaces CG.52.E1.02)

General

| | |
|-------------|----------|
| Compressor | TLX7KK |
| Code number | 102H4746 |

Application

| | | |
|--------------------------------|-------|---------------|
| Application | LBP | |
| Evaporating temperature range | °C | -35 to -10 |
| Voltage range | V/Hz | 198 - 254 /50 |
| Motor type | RSCR* | |
| Max. ambient temperature | °C | 38 |
| Comp. cooling at ambient temp. | 32°C | S |
| | 38°C | S |

* run capacitor 4 µF compulsory

Design

| | | |
|-------------------------------------|-----------------|------|
| Displacement | cm ³ | 6.49 |
| Oil quantity | cm ³ | 180 |
| Maximum refrigerant charge | g | 150 |
| Free gas vol. in compressor | cm ³ | 1790 |
| Weight without electrical equipment | kg | 8.3 |

Motor

| | | |
|---|-----------------------------|-----------|
| Motor size | watt | 65 |
| LRA (rated after 4 sec. UL984) LST | A | 2.3 |
| Cut-in current LST | A | 6.6 |
| Resistance, main and start winding (25°C) | Ω | 30.0/15.0 |
| Approvals | EN 60335-2-34 with Annex AA | |

Dimensions

| | | | |
|-------------------------|------------------|-----|-----------------|
| Height | mm | A | 173 |
| | | B | 169 |
| Suction connector | location/I.D. mm | C | 6.2 ±0.09 |
| Process connector | location/I.D. mm | D | 6.2 ±0.09 |
| Discharge connector | location/I.D. mm | E | 5.0 +0.12/+0.20 |
| Compressors on a pallet | pcs. | 125 | |

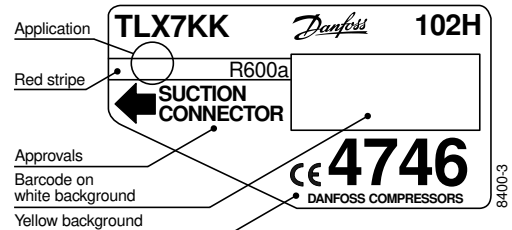

- S = Static cooling normally sufficient
- O = Oil cooling
- F₁ = Fan cooling 1.5 m/s
(compressor compartment temperature equal to ambient temperature)
- F₂ = Fan cooling 3.0 m/s necessary

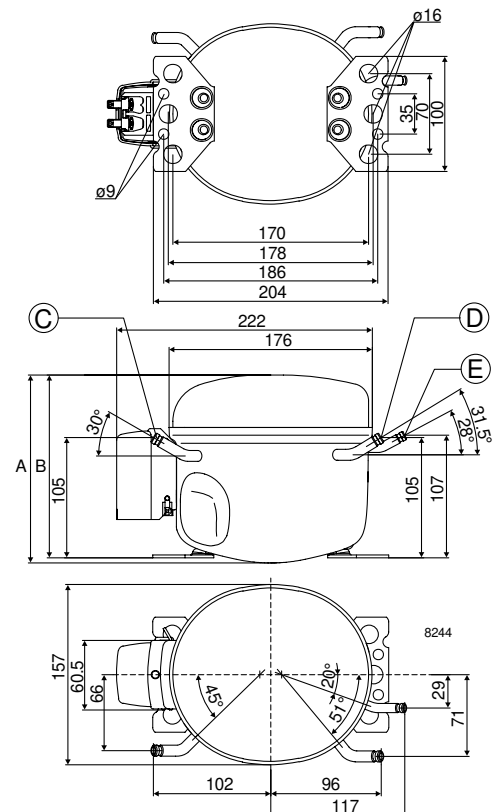

Capacity (EN 12900/CECOMAF)

watt

| | | | | | | | |
|----------|------|------|------|-------|-----|-----|-----|
| Comp. °C | -35 | -30 | -25 | -23.3 | -20 | -15 | -10 |
| TLX7KK | 41.5 | 57.6 | 77.0 | 84.4 | 100 | 128 | 160 |

Capacity (ASHRAE)

watt

| | | | | | | | |
|----------|------|------|------|-------|-----|-----|-----|
| Comp. °C | -35 | -30 | -25 | -23.3 | -20 | -15 | -10 |
| TLX7KK | 50.4 | 70.1 | 93.7 | 103 | 122 | 156 | 195 |

Power consumption

watt

| | | | | | | | |
|----------|------|------|------|-------|------|------|------|
| Comp. °C | -35 | -30 | -25 | -23.3 | -20 | -15 | -10 |
| TLX7KK | 49.7 | 58.7 | 67.0 | 69.8 | 75.2 | 83.8 | 93.5 |

Current consumption

A

| | | | | | | | |
|----------|------|------|------|-------|------|------|------|
| Comp. °C | -35 | -30 | -25 | -23.3 | -20 | -15 | -10 |
| TLX7KK | 0.25 | 0.28 | 0.31 | 0.33 | 0.35 | 0.40 | 0.45 |

COP (EN 12900/CECOMAF)

W/W

| | | | | | | | |
|----------|------|------|------|-------|------|------|------|
| Comp. °C | -35 | -30 | -25 | -23.3 | -20 | -15 | -10 |
| TLX7KK | 0.83 | 0.98 | 1.15 | 1.21 | 1.33 | 1.52 | 1.71 |

COP (ASHRAE)

W/W

| | | | | | | | |
|----------|------|------|------|-------|------|------|------|
| Comp. °C | -35 | -30 | -25 | -23.3 | -20 | -15 | -10 |
| TLX7KK | 1.02 | 1.19 | 1.40 | 1.47 | 1.62 | 1.86 | 2.09 |

Test conditions EN 12900/CECOMAF ASHRAE
 Condensing temperature 55°C 55°C
 Ambient and suction gas temp. 32°C 32°C
 Liquid temperature 55°C 32°C
 Static cooling, with RC 4 µF, 220V 50Hz, PTC consumption incl.

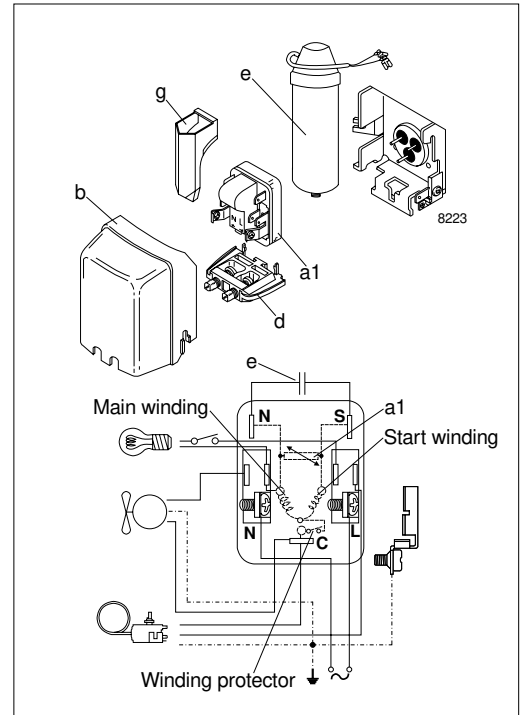

Accessories

| Devices | Fig. | TLX7KK |
|--|------|----------------------------------|
| PTC starting device 6.3 mm spades 4.8 mm spades | a1 | 103N0016 103N0021 |
| Cover | b | 103N2010 |
| Cord relief | d | 103N1010 |
| Run capacitor 4 µF (compulsory) 6.3 mm spades 4.8 mm spades | e | 117-7117 117-7119 |
| Protection screen for PTC | g | 103N0476 |
| Mounting accessories Bolt joint for one compressor Bolt joint in quantities Snap-on in quantities | | 118-1917 118-1918 118-1919 |

Danfoss can accept no responsibility for possible errors in catalogues, brochures and other printed material. Danfoss reserves the right to alter its products without notice. This also applies to products already on order provided that such alterations can be made without subsequential changes being necessary in specifications already agreed. All trademarks in this material are property of the respective companies. Danfoss and the Danfoss logotype are trademarks of Danfoss A/S. All rights reserved.

