

Operating Guide

# NovoCon® S CO6, Energy, I/O - High Accuracy Actuator

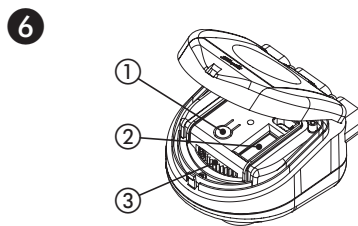

Calibration:  
Press button ① until two LED's are turned on  
DIP switch: ②  
Manual override:  
Adjust wheel ③

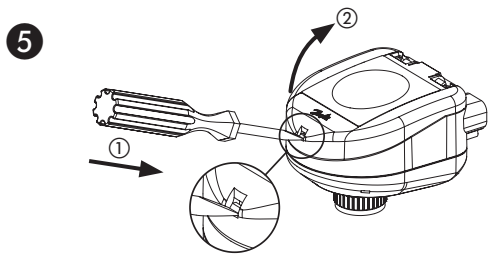
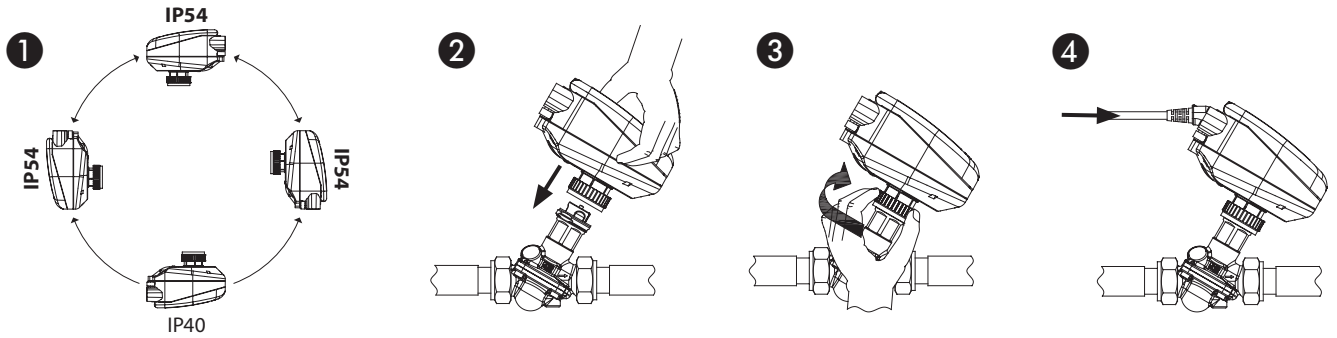
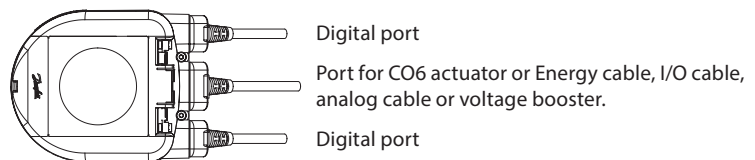

**NovoCon® digital cable**

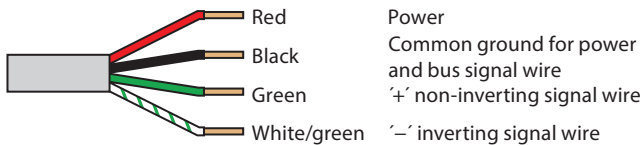

**NovoCon® analog cable**

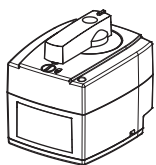

**Actuator NovoCon® ChangeOver<sup>6</sup>**

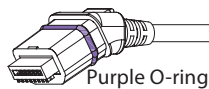

**Actuator NovoCon® ChangeOver<sup>6</sup> Energy**

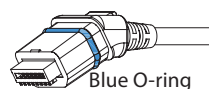

**Actuator NovoCon® ChangeOver<sup>6</sup> Flexible**



**NovoCon® Energy cable**

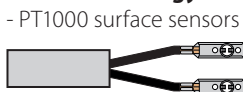

**NovoCon® Energy cable**



**NovoCon® I/O cable**

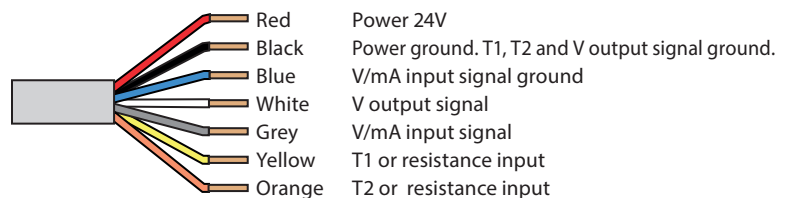

**NovoCon® S CO6, Energy, I/O - High Accuracy Actuator**

8

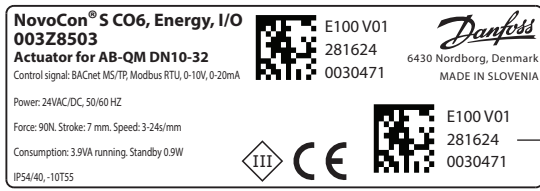

Serial number can be removed from the NovoCon® S and added to installation drawing.

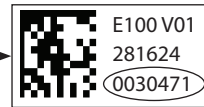

Device Object Instance Number

9

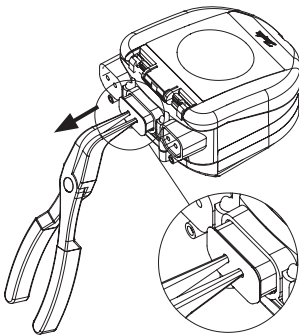

10

**DIP Switch**



DIP Switches 1 to 7 are used to assign the MAC address manually. Default MAC address assignment method is Auto MAC addressing for BACnet MS/TP and DIP Switches for Modbus RTU.

For termination of last unit on the field bus, turn DIP Switch 8 ON.

Dip switch 9 is not used.

Dip switch 10 is used to select between BACnet MS/TP (OFF=Default) and Modbus RTU (ON).

When the protocol is changed on DIP Switch 10, a power cycle is required.

11

**Presettings**

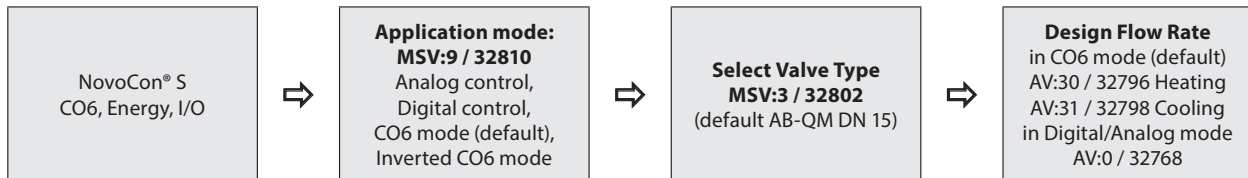

12

**Safety Note**

To avoid injury and damage to persons and devices, it is absolutely necessary these instructions are carefully read and observed prior to assembly and commissioning. Necessary assembly, start-up, and maintenance work must be performed only by qualified, trained and authorised personnel. Switch off the power line before wiring the actuator.

**Safety Note**

Connect via safety isolating transformer. Galvanic separations shall be provided for segments crossing buildings.

**Safety Note**

Always follow the local disposal regulations.