

Operating Guide

# NovoCon® S CO6, Energy, I/O - High Accuracy Actuator

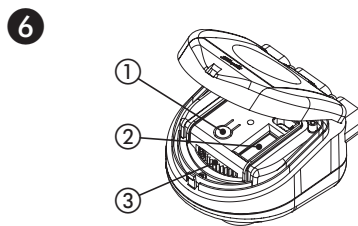

Calibration:  
Press button ① until two LED's are turned on  
DIP switch: ②  
Manual override:  
Adjust wheel ③

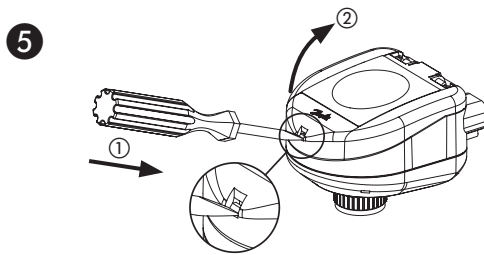
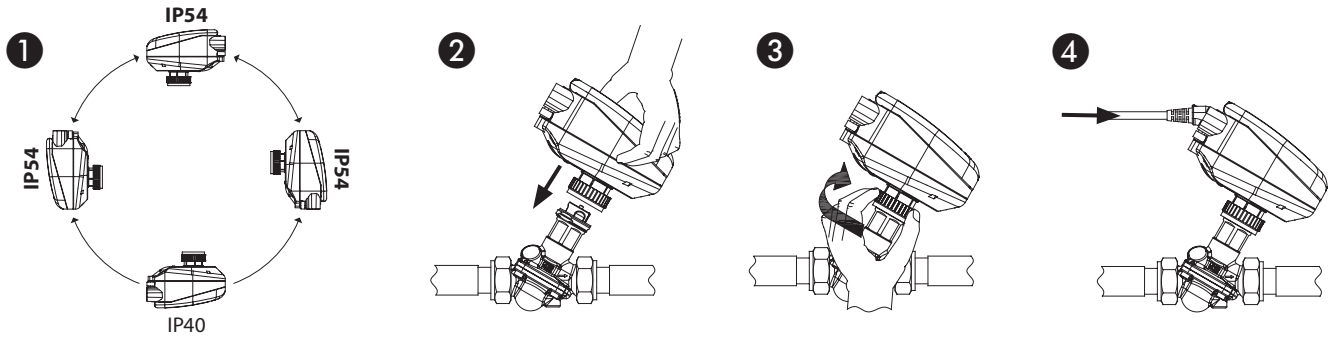
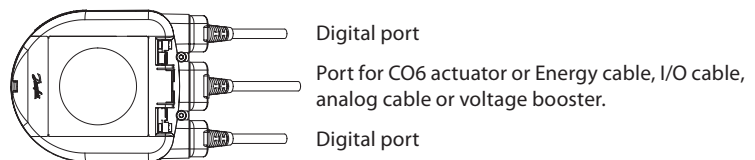

### NovoCon® digital cable

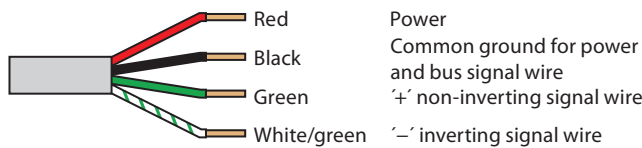

### NovoCon® analog cable

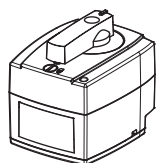

**Actuator NovoCon® ChangeOver<sup>6</sup>**

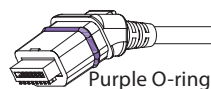

**Actuator NovoCon® ChangeOver<sup>6</sup> Energy**

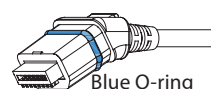

### Actuator NovoCon® ChangeOver<sup>6</sup> Flexible



### NovoCon® Energy cable

- PT1000 surface sensors



### NovoCon® Energy cable

- PT1000 immersed sensors



### NovoCon® I/O cable

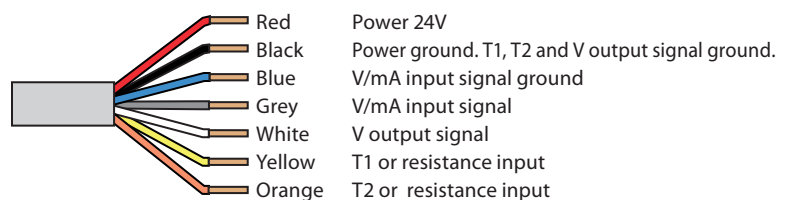

**NovoCon® S CO6, Energy, I/O - High Accuracy Actuator**

8

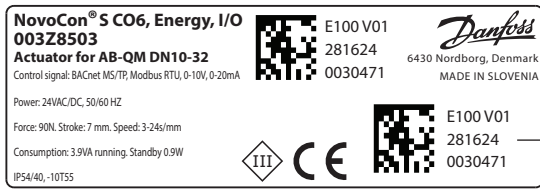

Serial number can be removed from the NovoCon® S and added to installation drawing.



Device Object Instance Number

9

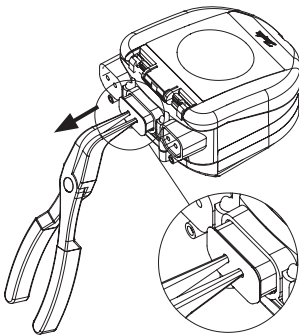

10

**DIP Switch**

| 1 | 2 | 3 | 4 | 5 | 6 | 7 | 8   | 9 | 10 |
|---|---|---|---|---|---|---|-----|---|----|
|   |   |   |   |   |   |   | ON  |   |    |
|   |   |   |   |   |   |   | OFF |   |    |

DIP Switches 1 to 7 are used to assign the MAC address manually. Default MAC address assignment method is Auto MAC addressing for BACnet MS/TP and DIP Switches for Modbus RTU.

For termination of last unit on the field bus, turn DIP Switch 8 ON.

Dip switch 9 is not used.

Dip switch 10 is used to select between BACnet MS/TP (OFF=Default) and Modbus RTU (ON).

When the protocol is changed on DIP Switch 10, a power cycle is required.

11

**Presettings**

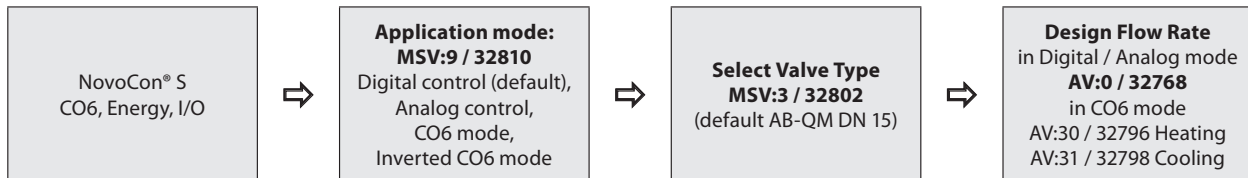

12

**Safety Note**

To avoid injury and damage to persons and devices, it is absolutely necessary these instructions are carefully read and observed prior to assembly and commissioning. Necessary assembly, start-up, and maintenance work must be performed only by qualified, trained and authorised personnel. Switch off the power line before wiring the actuator.

**Safety Note**

If the NovoCon® S network is supplied with two or more AC power boosters, caution must be observed when disconnecting one of the transformers from the high voltage power line. As the NovoCons are connected in a daisy chain, there may be high voltage on the primary side of the disconnected power supply. Disconnect always both the primary and secondary side of the transformer.

**Safety Note**

Connect via safety isolating transformer. Galvanic separations shall be provided for segments crossing buildings.

**Safety Note**

Always follow the local disposal regulations.