



Vane Type Double Pump

3525VQ Series –20 Design

AX438766130841en-000101

4 ● SAE rated capacity (3525VQ **shaft end pump cartridge)

USgpm	● Ring	● STD. cartridge kit	● F3 cartridge kit
21	394961	413420	421582
25	319396	413421	421583
30	319397	413422	421584
35	319398	413418	421585
38	319399	413419	421586

6 SAE rated capacity (3525VQ ** ** cover end pump cartridge)

■ USgpm	■ Ring	■ STD. cartridge kit	■ F3 cartridge Kit
12	326984	421244	421576
14	326985	421235	421577
17	326986	421236	421578
19	326987	421237	421579
21	326988	421238	421580

* NOTE

Install 419673 sealing ring into body, then install cartridge kit.

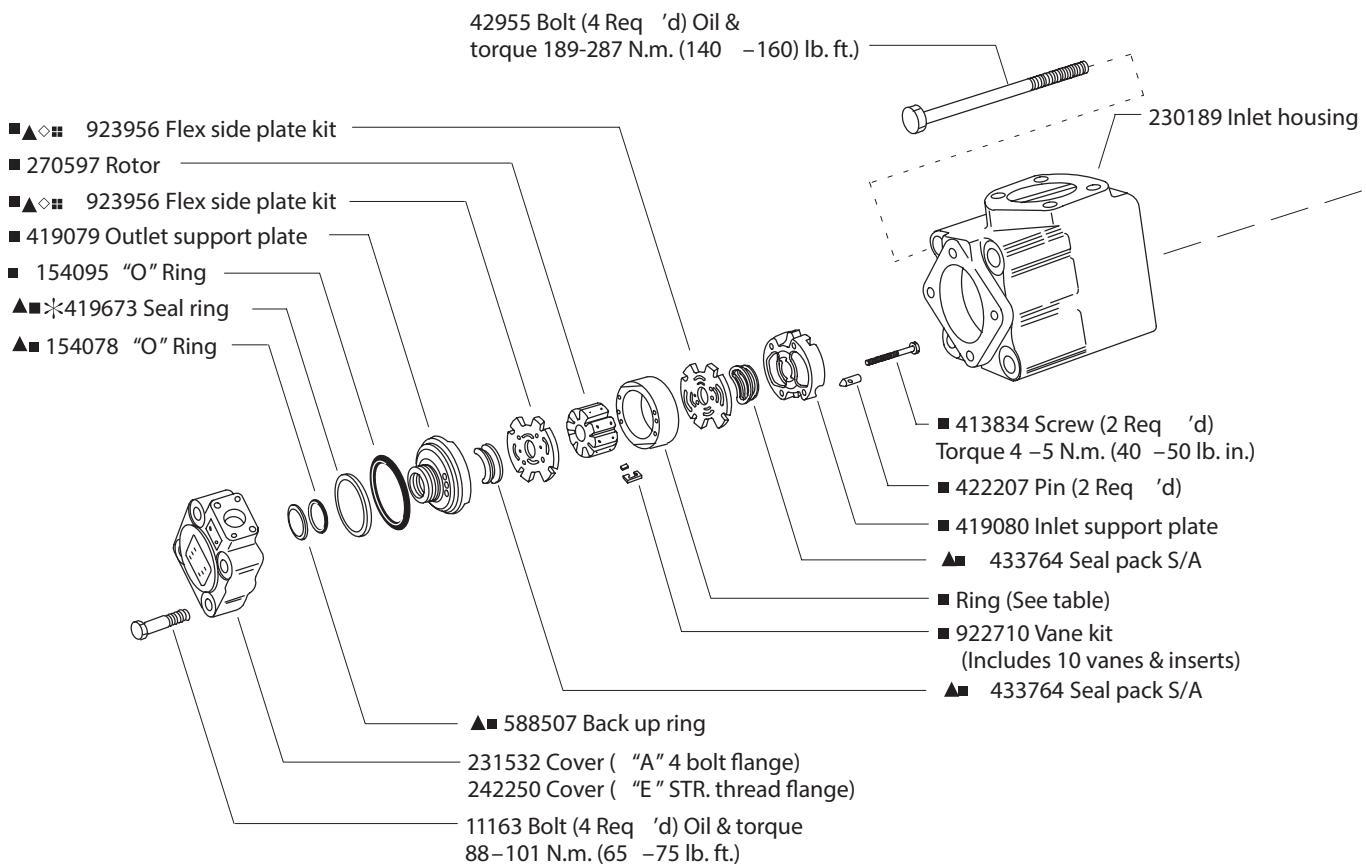

■ NOTE

When ordered individually, flex side plate kit includes (4) F3 seal pak subassemblies.

- Included in 3525VQ shaft end cart. kit.
- Included in 3525VQ cover end cart. kit.
- ▲ Included in single shaft seal kit 920056 F3 equivalent shaft seal kit 920068
- ◆ Included in mounting kit FB -C-10

8 Shaft part number	Key part number	Secondary shaft seal	Shaft number	Shaft type
243448	88678	—	1	STR. keyed standard
243449	—	—	11	Spline
247019	—	—	19	Spline
285417	—	—	33	Spline
394036	393536	429281	86	STR. keyed heavy duty

NOTE
Assemble seal with spring loaded sealing member towards bearing. Seals to be completely wetted with oil prior to assembly.

NOTE
Included in flex side plate kit; bronze face of plate must be installed toward the rotor. Kit contains two flex side plates & four seal packs.

▲□ 394973 Primary shaft seal

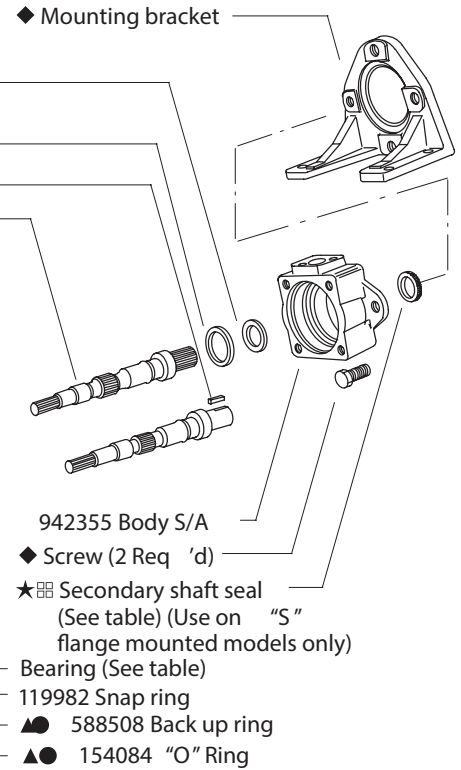
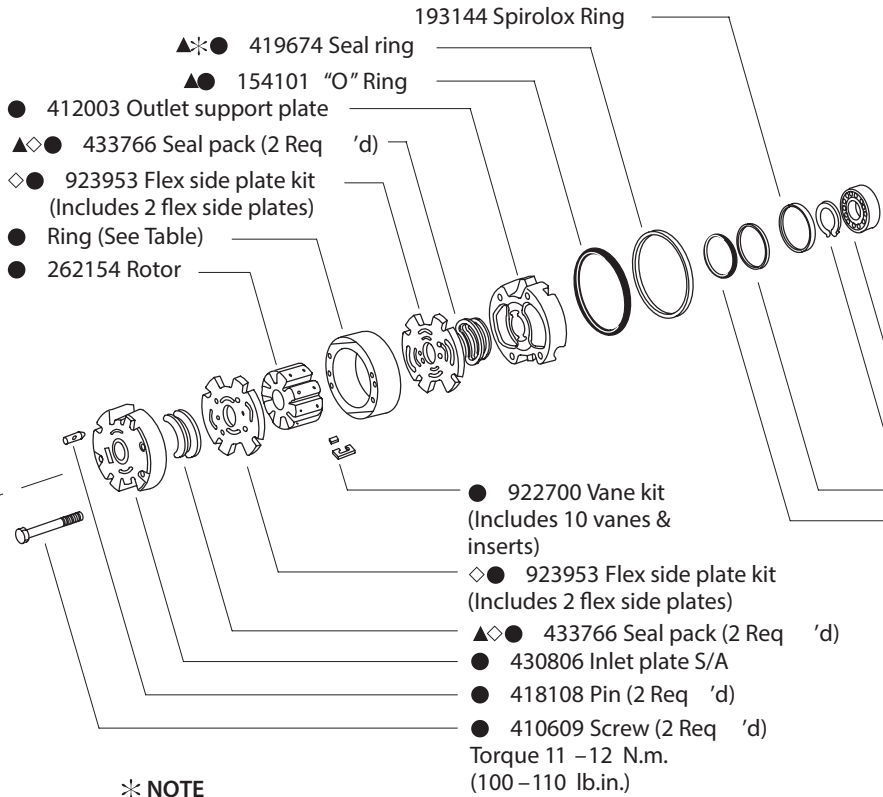

MODEL	TYPE DRIVE	BEARING
3525VQ	Direct	38441
3625VQ	Indirect	239092

*** NOTE**
Install 419674 sealing ring into body, then install cartridge kit.

NOTE
Assemble seal flush with pilot face with spring loaded sealing member facing inward as shown. Seals to be completely wetted with oil prior to assembly.

Typical cutaway view

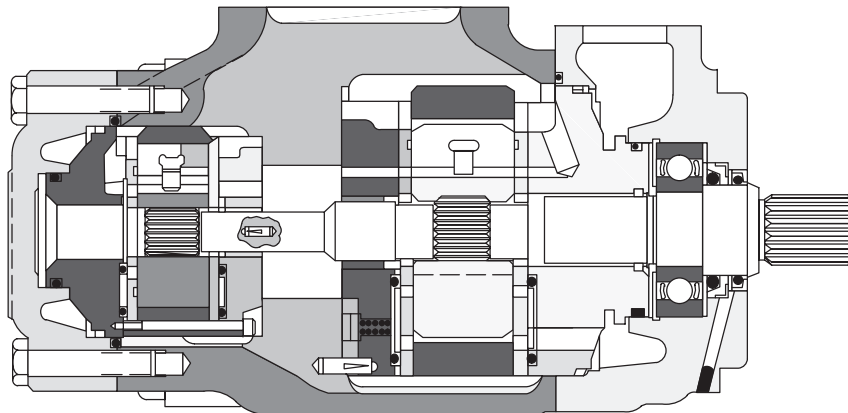

Model Code

(F3) - 3*25 VQ ** A ** -* 1 20 (*) - 28***

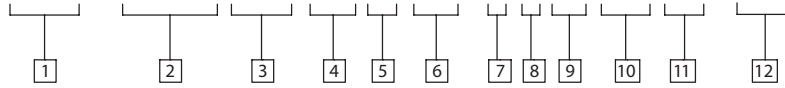

1 Viton seals
(Omit if not required.)

2 Series designation

3525VQ, Double Pump
3625VQ, Double Pump

3 Intra-vane pump

4 US GPM capacity
(Shaft end pump)

SAE rating 1200 rpm -100 psi (7 bar)

21 - 21 USgpm	35 - 35 USgpm
25 - 25 USgpm	38 - 38 USgpm
30 - 30 USgpm	

5 SAE port connections

Code	Inlet	Outlet #1	Outlet #2
A -	4 bolt flange	4 bolt flange	4 bolt flange
E -	4 bolt flange	4 bolt flange	SAE ST. THD.

6 US GPM capacity
(Cover end pump)

SAE rating 1200 rpm -100 psi (7 bar)

12 - 12 USgpm	19 - 19 USgpm
14 - 14 USgpm	21 - 21 USgpm
17 - 17 USgpm	

7 Mounting

F - Foot (Single shaft seal)
S - Flange (Double shaft seal)
Omitted - Flange, single shaft seal
assembly

8 Shaft type

1- Straight with square key standard
11- Splined
19- Splined
33- Splined
86- Straight with square key heavy
duty

9 Outlet port positions
(Viewed from cover end of pump)

With # 1 outlet opposite inlet:
AA - # 2 outlet - 135 ° CCW from inlet
AB - # 2 outlet - 45 ° CCW from inlet
AC - # 2 outlet - 45 ° CW from inlet
AD - # 2 outlet - 135 ° CW from inlet

With # 1 outlet 90 ° CCW from inlet:
BA - # 2 outlet - 135 ° CCW from inlet
BB - # 2 outlet - 45 ° CCW from inlet
BC - # 2 outlet - 45 ° CW from inlet
BD - # 2 outlet - 135 ° CW from inlet

9 Outlet port positions continued
(Viewed from cover end of pump)

With # 1 outlet inline with inlet:
CA - # 2 outlet - 135 ° CCW from inlet
CB - # 2 outlet - 45 ° CCW from inlet
CC - # 2 outlet - 45 ° CW from inlet
CD - # 2 outlet - 135 ° CW from inlet

With # 1 outlet 90 ° CW from inlet:
DA - # 2 outlet - 135 ° CCW from inlet
DB - # 2 outlet - 45 ° CCW from inlet
DC - # 2 outlet - 45 ° CW from inlet
DD - # 2 outlet - 135 ° CW from inlet

10 Design

11 Rotation
(Viewed from shaft end of pump)

L - Left hand (CCW rotation)
Omitted - Right hand rotation

12 Mounting

282 - SAE 2 -bolt mounting
283 - Foot mounting

NOTE

Standard right hand shaft rotation
cartridges shown. Reverse for left hand
rotation; refer to note.

Cover end cartridge R. H. Rotation

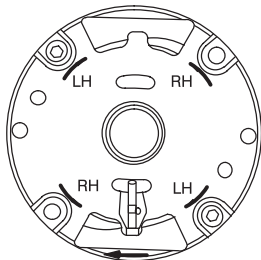

Sharp Edges of Vane Must Lead in
Direction of Rotation

Shaft end cartridge R. H. Rotation

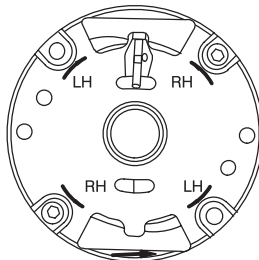

Sharp Edges of Vane Must Lead in
Direction of Rotation

NOTE

To reverse cartridge kit rotation,
remove the two screws and reverse
the location of the inlet support plate
and the outlet support plate. Reinstall
the two screws hand tight. Use pump
cover to align all sections of the
cartridge. Carefully remove the cover
and tighten the screws.

Products we offer:

- Cartridge valves
- DCV directional control valves
- Electric converters
- Electric machines
- Electric motors
- Gear motors
- Gear pumps
- Hydraulic integrated circuits (HICs)
- Hydrostatic motors
- Hydrostatic pumps
- Orbital motors
- PLUS+1® controllers
- PLUS+1® displays
- PLUS+1® joysticks and pedals
- PLUS+1® operator interfaces
- PLUS+1® sensors
- PLUS+1® software
- PLUS+1® software services, support and training
- Position controls and sensors
- PVG proportional valves
- Steering components and systems
- Telematics

Danfoss Power Solutions is a global manufacturer and supplier of high-quality hydraulic and electric components. We specialize in providing state-of-the-art technology and solutions that excel in the harsh operating conditions of the mobile off-highway market as well as the marine sector. Building on our extensive applications expertise, we work closely with you to ensure exceptional performance for a broad range of applications. We help you and other customers around the world speed up system development, reduce costs and bring vehicles and vessels to market faster.

Danfoss Power Solutions – your strongest partner in mobile hydraulics and mobile electrification.

Go to www.danfoss.com for further product information.

We offer you expert worldwide support for ensuring the best possible solutions for outstanding performance. And with an extensive network of Global Service Partners, we also provide you with comprehensive global service for all of our components.

Local address:

Hydro-Gear

www.hydro-gear.com

Daikin-Sauer-Danfoss

www.daikin-sauer-danfoss.com

**Danfoss
Power Solutions (US) Company**
2800 East 13th Street
Ames, IA 50010, USA
Phone: +1 515 239 6000

**Danfoss
Power Solutions GmbH & Co. OHG**
Krokamp 35
D-24539 Neumünster, Germany
Phone: +49 4321 871 0

**Danfoss
Power Solutions ApS**
Nordborgvej 81
DK-6430 Nordborg, Denmark
Phone: +45 7488 2222

**Danfoss
Power Solutions Trading
(Shanghai) Co., Ltd.**
Building #22, No. 1000 Jin Hai Rd
Jin Qiao, Pudong New District
Shanghai, China 201206
Phone: +86 21 2080 6201