

068R9539

R22/R407C
 PB = 28 bar / MWP = 400 psig
 p_{test} = max. 32 bar (460 psig)

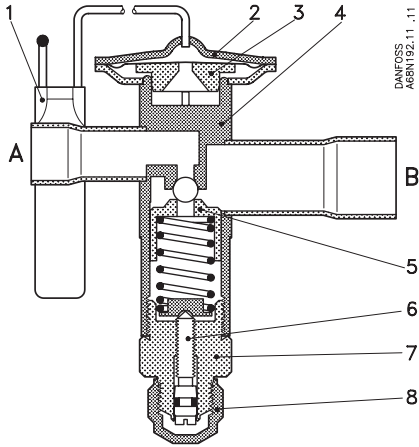

DANFOSS
 A6BN192.11.11

Flow direction:

Normal: A → B

Reverse: B → A

Q_{nom.} A → B [kW] = 100%
 Q_{nom.} B → A [kW] = 80%

Single port design (TDE)

TDE 3 - 7.5 = 3 → 7.5 TR / 10.5 → 26 kW
 TDE 8 - 19 = 8 → 19 TR / 28 → 66.5 kW
 TDEB 8 - 19 = 8 → 19 TR / 28 → 66.5 kW
 TDEB 20 - 40 = 20 → 40 TR / 70 → 140 kW

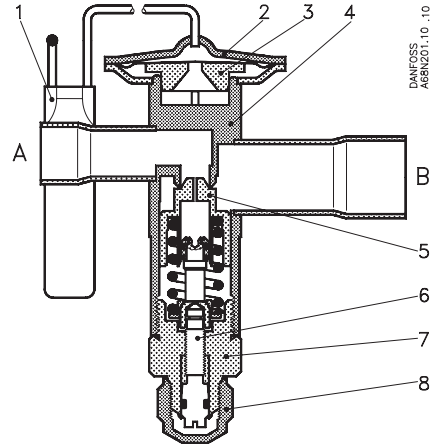

DANFOSS
 A6BN201.10.10

Balanced port design (TDEB)
 (used for biflow)

Range {
 N max. 100°C (210°F)
 K max. 150°C (300°F)
 AC max. 150°C (300°F)

DANFOSS
 A6BN175.12

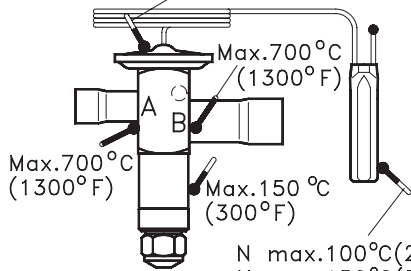

N max. 100°C (210°F)
 K max. 150°C (300°F)
 AC max. 150°C (300°F)

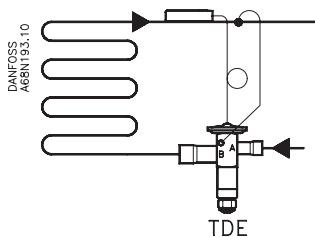
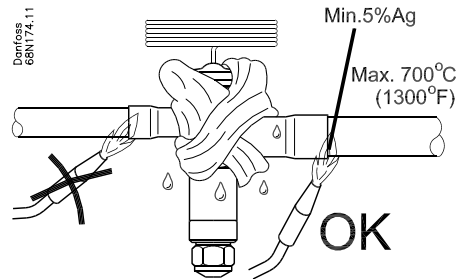

DANFOSS
 A6BN193.10

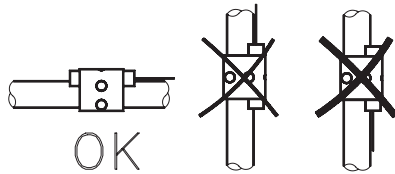

DANFOSS
 A6BN80.11

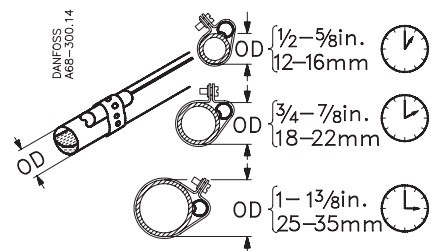

DANFOSS
 A6B-300.14

068R9539

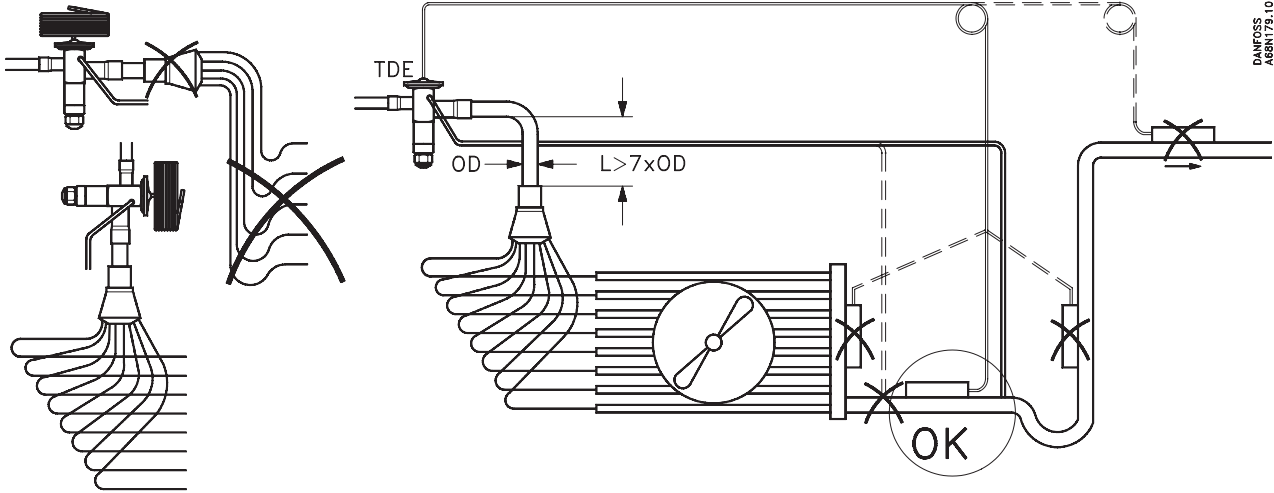

DANFOSS
AGBN179.10

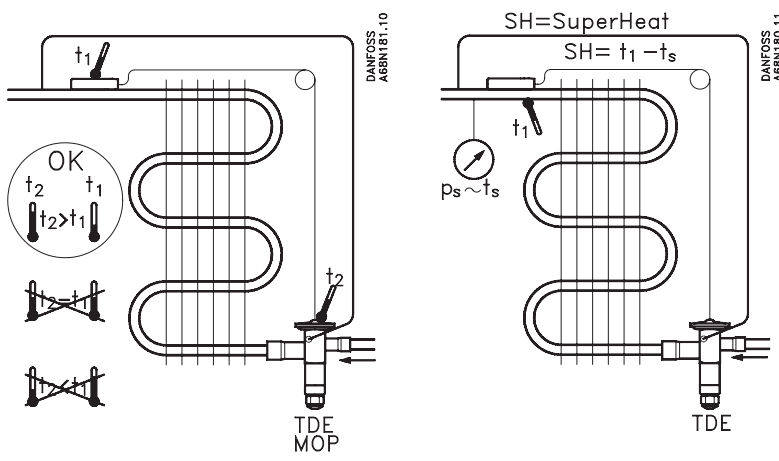

DANFOSS
AGBN181.10

DANFOSS
AGBN180.11

Superheat adjustment

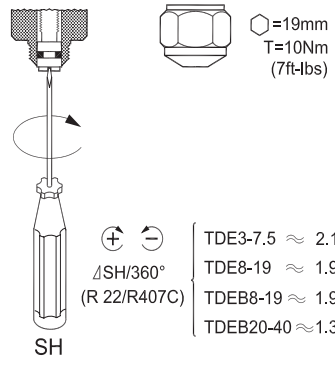

Danfoss
68N104.14

TDE3-7.5	≈ 2.1 °C (3.8°F)
TDE8-19	≈ 1.9 °C (3.4°F)
TDEB8-19	≈ 1.9 °C (3.4°F)
TDEB20-40	≈ 1.3 °C (2.3°F)

Returning superheat to factory setting

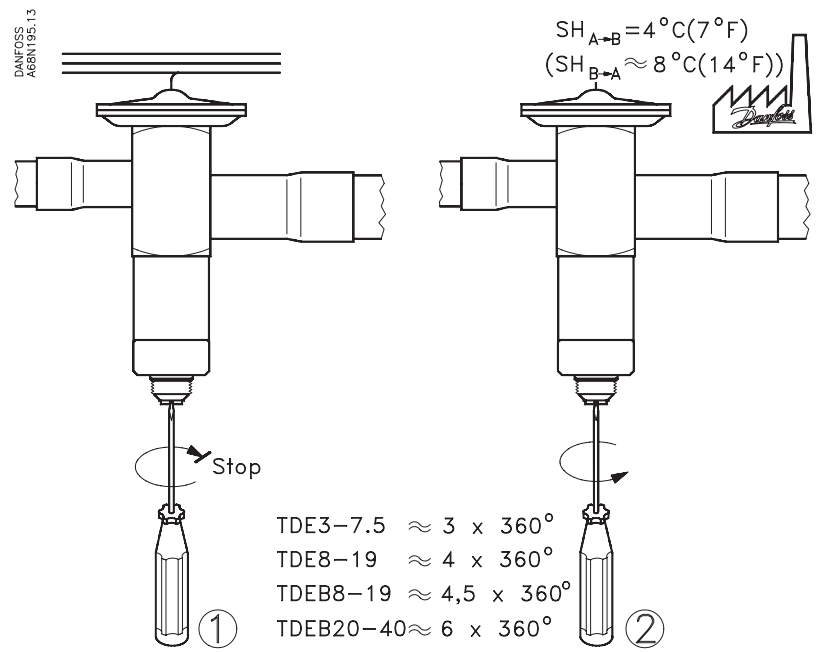

DANFOSS
AGBN195.13

TDE3-7.5	≈ 3 x 360°
TDE8-19	≈ 4 x 360°
TDEB8-19	≈ 4,5 x 360°
TDEB20-40	≈ 6 x 360°