

Check Valves

3CA300

Check Valve, Standard Direction
350 bar [5000 psi] • 300 l/min [80 US gpm]

DESCRIPTION AND OPERATION

This is a check valve where free flow takes place from port 1 to 2 and is blocked from port 2 to 1.

SCHEMATIC



DIMENSIONS

mm [in]

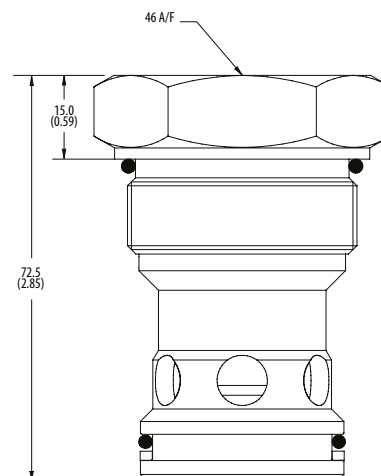

Installation torque
 150 Nm [110 ft. lbs]

PERFORMANCE DATA

Rated pressure	350 bar [5000 psi]
Rated flow	300 l/min [80 US gpm]
Leakage	0.2 ml/min nominal
Weight	0.48 kg [1.06 lbs.]
Cavity	SDC20-2

PERFORMANCE CURVES

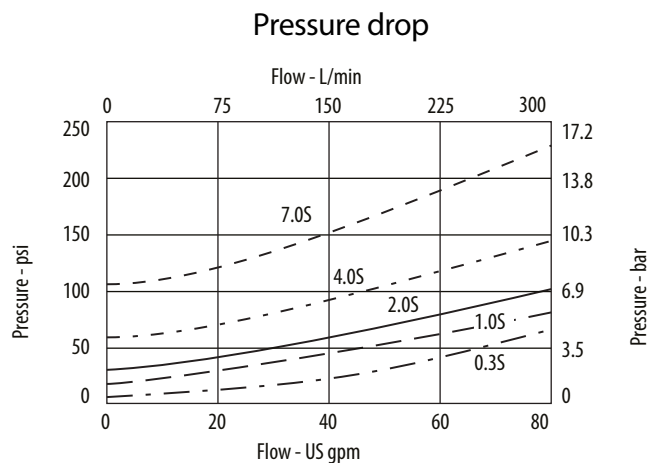

MODEL CODE

3CA350 - 10W - 1.0 - S - 377

Function

300-No Housing
 350-Cartridge and Housing

Housing

Code	Ports	Housing Model Code	
		Aluminum	Steel
Omit	No Housing		
10W	1 1/4" BSP	C24005	C24006
20T	1 1/4" SAE	C24011	C24012

* Aluminum bodies are to be used for pressures less than 210 bar [3000 psi].
 * Additional housings available

Housing Material

Omit-Aluminum/No housing
 377-Steel

Seal Option

Code	Seal Kit
S-Buna-N	SK1341
SV-Viton	SK1341V

Crack Pressure

Code	Bar	Psi
0.3	0.3	[4.4]
1.0	1.0	[14.5]
2.0	2.0	[29]
4.0	4.0	[58]
7.0	7.0	[100]