

Check Valves

RS 10

Check Valve, In-line, Female Port
350 bar [5000 psi] • 60 l/min [16 US gpm]

DESCRIPTION AND OPERATION

This is an in-line check valve where free flow takes place from port 1 to 2 and is blocked from port 2 to 1.

SCHEMATIC



DIMENSIONS

mm [in]

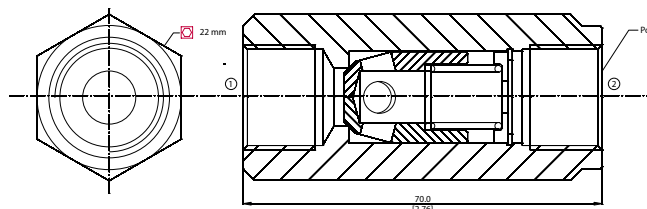

PERFORMANCE DATA

Rated pressure	350 bar [5000 psi]
Rated flow at 7 bar [100 psi]	60 l/min [16 US gpm]
Weight	0.13 kg [0.29 lb]

PERFORMANCE CURVES

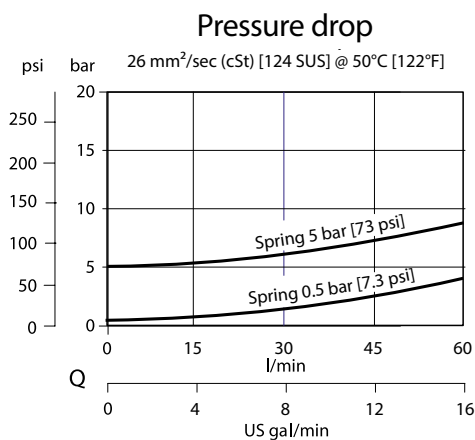

MODEL CODE

RS10 - 5 - G

Crack Pressure

Code	Bar	Psi
0.5	0.5	[7.3]
5	5	[73]

Ports

G-3/8 BSP