

Installation instructions

WP35 Weatherproof Enclosures for 1½" & 2" AB-QM Valves

The WP35 weatherproof enclosure is designed specifically for 1½" and 2" AB-QM valve bodies mounted with either the AME15QM or AME435QM motorized actuators.

Enclosed:

- (1) Black rubberized collar
- (1) Size 40 hose clamp
- (1) Size 32 hose clamp

Required:

- (1) Weather tight ½" electrical conduit



Step 1

Confirm the proper flow percentage setting is correct. (Refer to the AB-QM valve instructions for the proper methods to set the valve flow percentage.)

If any necessary valve adapters are required for the mounting of the motor actuator, installed the adapter to the valve. (Refer to adapter installation instructions)

Actuator	Code No.	Valve	Required Adapter
AME 15QM	082H3075	003Z0780 003Z0781	065Z0311 
AME 435QM	082H0171		None
AMV 435	082H0162		

Step 2

Remove the smaller (size 32) hose clamp from the collar and install the collar into the bottom of the enclosure. Slide the collar until it rests with the bottom of the enclosure.

Install a weather tight ½" electrical conduit to the pre-drilled hole on the side of the enclosure.



Step 3

Fully seat the collar by pushing down the collar to the AB-QM valve body. Tighten the hose clamp.

Slide the smaller clamp onto the collar and tighten the clamp.



For AME 15QM



For AME 435QM / AMV 435

Step 4

Wire the actuator based upon the actuator's installation instructions. Provide enough wire slack to allow for the removal of the actuator from the weatherproof enclosure.

Step 5

Slide the actuator onto the valve with the longer portion of the actuator pointing towards the electrical conduit. Follow the installation procedures to mount the actuator to the valve.

AME 15QM

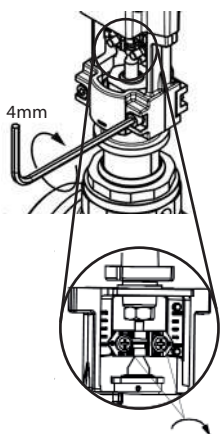

Step 7

Align the enclosure's cover and tighten the 6 screws of the enclosure. Make sure the cover makes contact to the silicone gasket when tightening.



AME 435QM

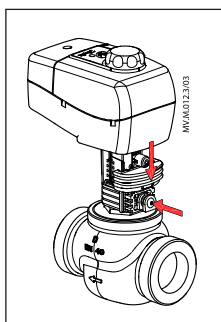

Step 6

Power the actuator and confirm the initial commissioning of the actuator to the valve. The actuator will cycle full open to close as it learns the required stem travel distance.