



# Differential pressure switch

## MP54 / MP55 / MP55A

MP54 and MP55 are used in refrigerating systems using HCFC and non-flammable HFC refrigerants

## Description

MP54 and MP55 oil differential pressure switches are used as safety switches to protect refrigeration compressors against low lubricating oil pressure. If the oil pressure fails, the oil differential pressure switch stops the compressor after a certain time period. MP54 and MP55 are used in refrigerating systems using HCFC and non-flammable HFC refrigerants. MP55A is used in refrigerating systems with R717. MP55A can also be used in systems with HCFC and non-flammable HFC refrigerants. MP54 has a fixed differential pressure setting. It also incorporates a thermal time relay with a fixed release time setting. MP55 and MP55A have adjustable differential pressure and are available both with and without thermal time relay.

## Features & benefits

- Wide regulating range
- Can be used for HCFC and non-flammable HFC refrigerants
- Electrical connection at the front of the unit
- Suitable for both alternating and direct current (AC and DC)
- Screwed cable entry for cables from 6 – 14 mm diameter
- Can be used for deep freeze, refrigeration and air conditioning plant
- Small contact differential



Ordering

Product code numbers

Figure: MP55E

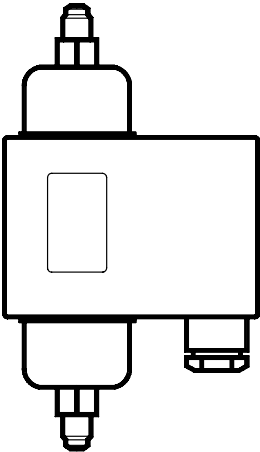

Table: For R22, R134a, R404A, R407A, R407C, R407F, R422B, R422D, R448A, R449A, R450A, R452A, R507A, R513A

Type	Differential $\Delta p$ [bar]	Operation range, LP side [bar]	Relay release time [s]	Code no.		
				Connection		
				¼ in Flare	1 m cap.tube ¼ in ODF solder	M12 x 1.5 with 6 mm cutting ring
MP54	0.65	-1 – 12	0 <sup>(1)</sup>	060B029791	–	–
	0.65	-1 – 12	45	060B016691	–	–
	0.9	-1 – 12	60	060B016791	–	–
	0.65	-1 – 12	90	060B016891	–	–
	0.65	-1 – 12	120	060B016991	–	–
MP55	0.3 – 4.5	-1 – 12	45	060B017091	060B013391	–
	0.3 – 4.5	-1 – 12	60	060B017191	–	–
	0.3 – 4.5	-1 – 12	60	060B017891 <sup>(2)</sup>	–	–
	0.3 – 4.5	-1 – 12	90	060B017291	–	–
	0.3 – 4.5	-1 – 12	120	060B017391	–	–
	0.3 – 4.5	-1 – 12	0 <sup>(1)</sup>	060B029991	–	–

<sup>(1)</sup> MP without time relay is for applications where an external time relay is required – perhaps with a different release time than the one specified

<sup>(2)</sup> With glow lamp that remains on during normal operation.

**Table: For R22, R134a, R404A, R407A, R407C, R407F, R422B, R422D, R448A, R449A, R450A, R452A, R507A, R513A, R717<sup>\*)</sup>**

Type	Differential $\Delta p$ [bar]	Operation range, LP side [bar]	Relay release time [s]	Code no.	
				Connection	
				G $\frac{3}{8}$ a supplied with $\varnothing 6.5$ / $\varnothing 10$ mm weld nipple	M12 $\times$ 1.5 with 6 mm cutting ring
MP55A	0.3 – 4.5	-1 – 12	45	060B017491	060B018291
	0.3 – 4.5	-1 – 12	60	060B017591	060B018391
	0.3 – 4.5	-1 – 12	60	060B017991 <sup>(3)</sup>	–
	0.3 – 4.5	-1 – 12	90	060B017691	060B018491
	0.3 – 4.5	-1 – 12	120	060B017791	060B018591
	0.3 – 4.5	-1 – 12	0 <sup>(4)</sup>	060B029891 <sup>(5)</sup>	060B029691

<sup>(3)</sup> With glow lamp that remains on during normal operation<sup>(4)</sup> MP without time relay. Versions without time relay are for applications where an external time relay is required – perhaps with a different release time than the one specified<sup>(5)</sup> MP without time relay. Versions without time relay are for applications where an external time relay is required – perhaps with a different release time than the one specified<sup>\*)</sup> only for MP55A

For a complete list of approved refrigerants, please visit <https://store.danfoss.com> there, you can search for individual code numbers to find the refrigerants listed as part of the technical data.

**NOTE:** If the operational light goes out, the compressor should not run longer than the release time.

## Functions

**Figure: Electrical diagram**

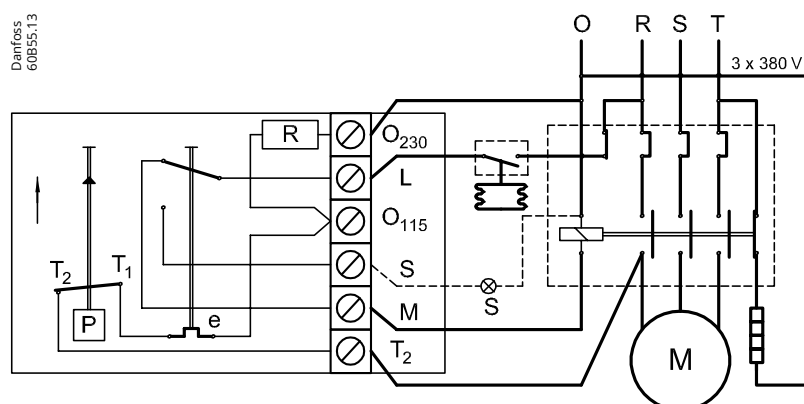

If there is no oil pressure on starting, or if the oil pressure falls below the set pressure during operation, the compressor will stop after the release time has elapsed.

The electrical circuit is divided into two completely separate circuits: a safety circuit and an operational circuit.

The timer (e) in the safety circuit is activated when the effective lubricating oil pressure, the oil differential pressure (the difference between the oil pump pressure and suction pressure), is lower than the set value.

The timer is deactivated when the oil differential pressure is more than the set value plus the contact differential.

**Figure: Functions for During start**

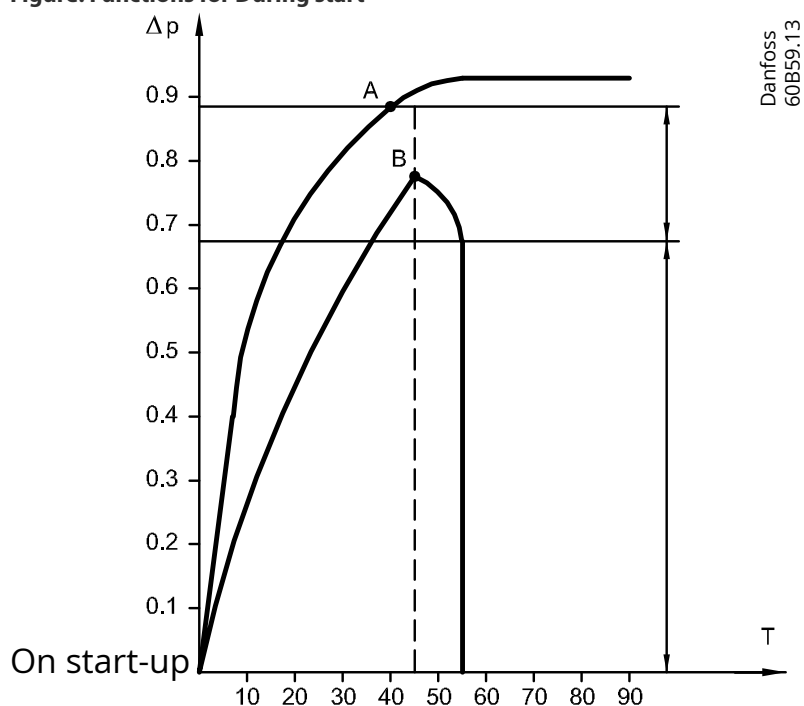

The two diagrams below explain the terms "oil differential pressure" and "contact differential". Both have to be considered when using oil differential pressure switches.

The first diagram shows the function of the differential switch during start; the second shows the function of the switch during operation.

**Position A: (Normal start-up)**

The lubricating oil pressure is built up during start to the set/fixed differential plus the contact differential, before the timer cuts out (in this example, after 45 seconds).

At point A contacts T1-T2 open and timer (e) is stopped, i.e. normal lubricating oil conditions for the compressor have been established.

**Position B:**

The lubricating oil pressure does not reach the set/fixed differential plus the contact differential before the timer period elapses. At point B the timer cuts out operational circuit L-M and the compressor stops. If a signal source is connected to terminal S, it will be activated. Restart can only be performed after about 2 minutes by activation of the reset button, provided the cause of the fault has been determined.

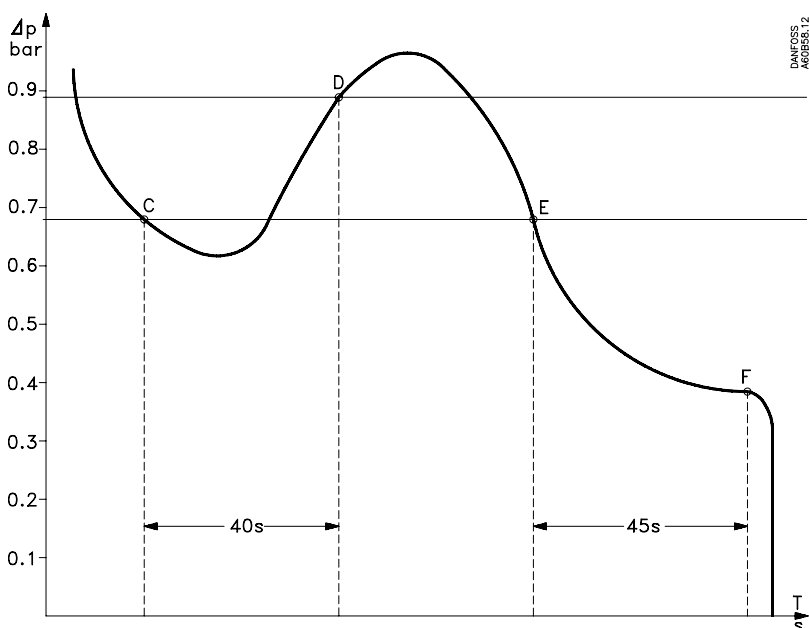
**Figure: Functions for during operation****Position C:**

The lubricating oil pressure falls during operation to a value lower than the set/fixed differential. At point C, safety circuit T1-T2 cuts in and the timer is activated.

**Position D:**

The lubricating oil pressure reaches the set/fixed differential plus the contact differential before the timer period elapses. At point D, safety circuit T1-T2 cuts out, and the timer is stopped, i.e. normal lubricating oil conditions for the compressor have been established.

**Position E:**

The lubricating oil pressure falls to a value lower than the set/fixed differential during operation. At point E, safety circuit T1-T2 cuts in and the timer is activated.

**Position F:**

The lubricating oil pressure remains lower than the set/fixed differential. At point F the timer cuts out operational circuit L-M and the compressor stops. If a signal source is connected to terminal S, it will be activated. Restart can only be performed after about 2 minutes by activation of the reset button, provided the cause of the fault has been determined.

**After start-up**

It is important that a function check should be made to ensure that the differential pressure control is operating as it should.

This check can be made by pressing the test device (inside the unit on the left-hand side).

When the test device is pressed down and held in this position, the compressor motor should stop after the release time determined by the time relay has elapsed.

## Product details

### General data

**Table: Materials in contact with the medium**

Unit type	Material
MP54 MP55	Stainless steel 19/11, no. 1.4306 to EN 10088 Cold forming steel, no. 1.0338, EN 10139 Free cutting steel, no. 1.0718, EN 10277
MP55A	Stainless steel 19/11, no. 1.4306 to EN 10088 Cold forming steel, no. 1.0338, EN 10139 Free cutting steel, no. 1.0401, EN 10277-2

**Table: Technical data for MP 54, MP 55 and MP 55A**

Features		Specifications
Control voltage		230 V or 115 V AC or DC
Permissible voltage variation		-15 – 10%
Max. working pressure		PS/MWP = 17 bar
Max. test pressure		P <sub>e</sub> = 22 bar
Ambient temperature The time relay is temperature-compensated in the range		-40 – 60 °C
Screwed cable entry		P <sub>g</sub> 13.5
Cable diameter		6 – 14 mm
Max. bellows temperature		100 °C
Switch differential max. Δp [bar]		0.2
Enclosure		IP20 to EN 60529 / IEC 60529
Contact loads	MP with time relay (contacts M–S)	AC15 = 2 A, 250 V
		DC13 = 0.2 A, 250 V
	MP without time relay	AC15 = 0.1 A, 250 V
		DC13 = 12 W, 125 V
Wire dimensions	solid / stranded	0.2 – 1.5 mm <sup>2</sup>
	flexible, without ferrules	0.2 – 1.5 mm <sup>2</sup>
	flexible, with ferrules	0.2 – 1 mm <sup>2</sup>
Tightening torque		Max. 1.2 Nm
Rated impulse voltage		4 kV
Pollution degree		3
Short circuit protection, fuse		2 A
Insulation		250 V

### Terminology

**Differential range:** The pressure difference between LP and OIL connections within which the switch can be set to operate.

**Scale reading:** The differential between the oil pump pressure and the pressure in the crankcase that exists at the moment the contact system cuts in current to the time relay on falling oil pressure.

**Operating range:** The pressure range on the LP connection within which the switch can operate.

**Contact differential:** The pressure rise above the set differential pressure (scale reading) necessary to cut off current to the time relay.

**Release time:** The period for which the differential pressure switch allows the compressor to run with too low an oil pressure during start-up and operation.

## Dimensions and weight

**Figure: Dimensions and weight for type MP54, MP55 and MP55A**

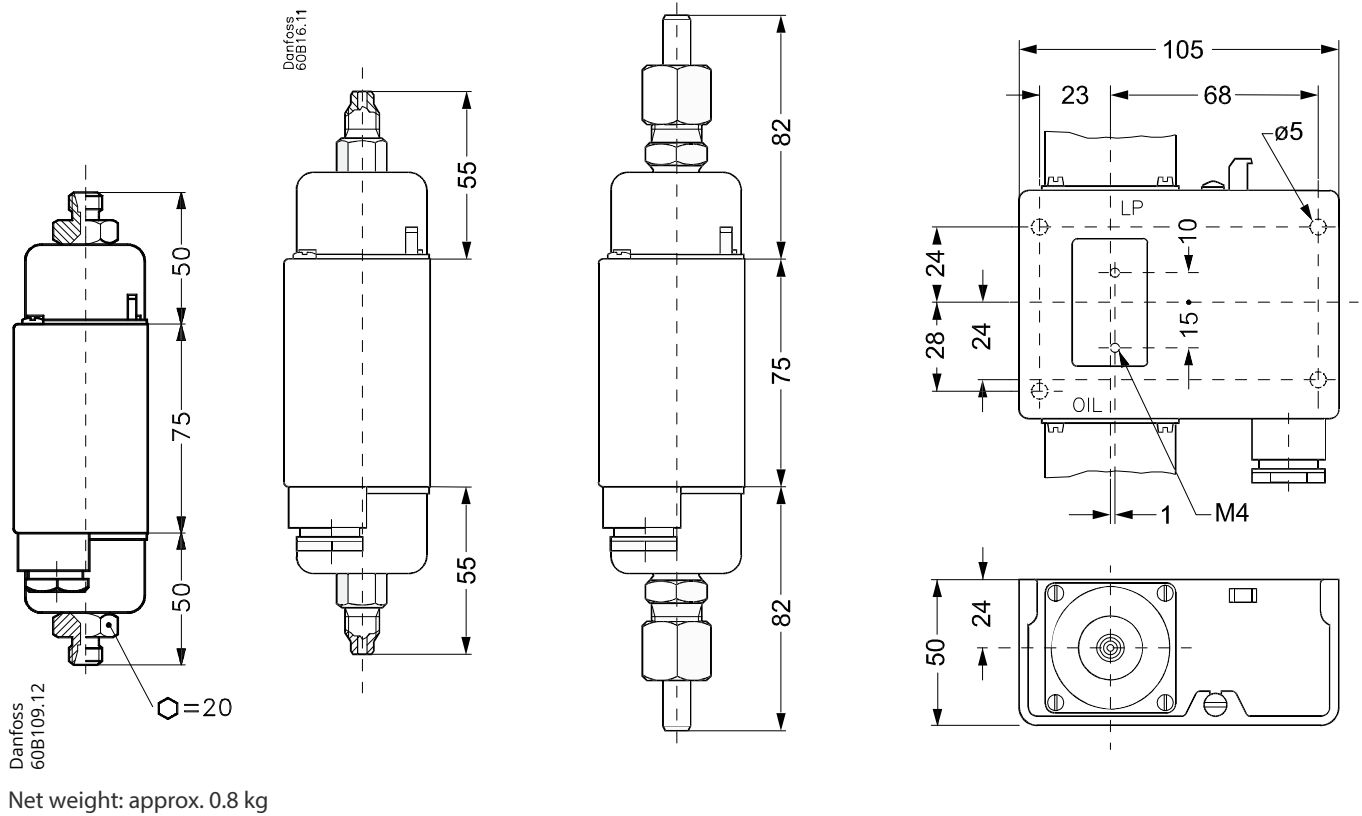



## Design

**Figure: Design for MP54, MP55 and MP55A**

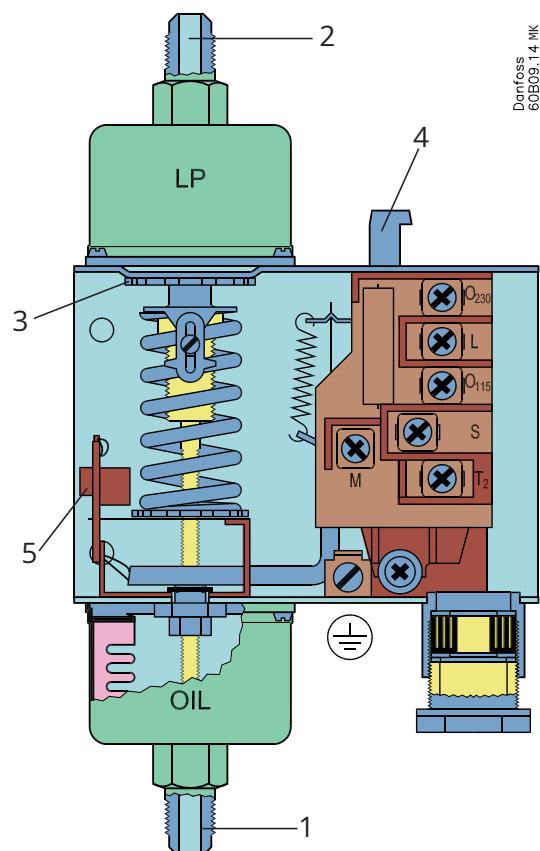

1	Connection to pressure side of lubrication system, OIL
2	Connection to suction side of refrigeration plant, LP
3	Setting disk (MP55 and MP55A)
4	Reset button
5	Test device

The operation of the pressure switch relies only on the differential pressure, i.e. the difference in pressure between the two-counteracting bellows, whereas it is independent of the absolute pressure acting on both bellows.

The MP55 and 55A can be set for different differential pressures by the setting disc (3).

The set differential pressure can be read from the internal scale.

The MP54 has a fixed differential and has no pressure setting disc.

The factory-set differential pressure is stamped on the front plate of the switch.

## Certificates, declarations and approvals

The list contains all certificates, declarations, and approvals for this product type. Individual code number may have some or all of these approvals, and certain local approvals may not appear on the list.

When you click on the link you will be directed to the latest version of the 'Declaration of Conformity'. Products developed and sold before this date of issue conform to the directives/standards in force at the time of their sale.

Approval type	Title	Certification body	Approval topic
EU Declaration	<a href="#">Danfoss EU 060-9680.AC</a>	Danfoss	LVD
CCC Declaration	<a href="#">Danfoss CCC 2020000305000027</a>	Danfoss	
Manufacturer's Declaration	<a href="#">Danfoss MD 060-9639.AB</a>	Danfoss	China RoHS
CCC Declaration	<a href="#">Danfoss CCC 2024010305686627</a>	CCC - China Compulsory Certification	CCC
Electrical Safety Certificate	<a href="#">UL E31024</a>	UL - Underwriters Laboratories inc.	
UA Declaration	<a href="#">Danfoss UA 2024-07-25 cooling sensors</a>	Danfoss	LVD
Pressure Safety Certificate	<a href="#">LLC CDC EURO-TYSK UA.TR.089.1015.05-22</a>	LLC CDC EURO TYSK - Ukraine	Pressure
UA Declaration	<a href="#">Danfoss UA 2023-01-10 Regulators PL01 PL04</a>	Danfoss	PED
Export Control Declaration	<a href="#">Pressure switches &amp; Thermostats</a>	Danfoss	
Marine Safety Certificate	<a href="#">DNV GL TAA0000182 Rev. 2</a>	DNV GL	Marine
Marine Safety Certificate	<a href="#">RINA ELE086320XG-006</a>	RINA - Registro Italiano Navale	

## Contact details

### Online support

Danfoss offers a wide range of support along with our products, including digital information, software, mobile apps and expert guidance. See the possibilities below.



#### The Danfoss Design center

Discover the Design Center, our advanced digital platform that streamlines product selection. With integrated tools and enhanced type pages, it's simpler than ever to access product information and documentation, and to select the right products. Check the availability of Danfoss products at partner locations and enjoy seamless transitions from selection to purchase with our basket-to-basket functionality. Whether you're buying from our distributors or directly from the Product Store, the Design Center simplifies your experience. Learn more at: [designcenter.danfoss.com](https://designcenter.danfoss.com).



#### The Danfoss product store

The Danfoss Product Store is a one-stop shop available 24/7 for our customers, no matter where you are in the world or what area of industry you work in. Browse our catalog, check product details and documentation, view your prices and product availability, and quickly finalize your purchase. Start browsing at: [store.danfoss.com](https://store.danfoss.com).



#### Danfoss Partner Portal/Product Data tool

Designed to support you with easy access to product data extracts, essential resources, tools, and information. The Partner Portal provides a centralized hub for product documentation, training materials, marketing assets, and technical support, ensuring you have everything you need to succeed and grow your business with Danfoss. The Partner Portal is available 24/7 at: [partner.danfoss.com](https://partner.danfoss.com) and is ready to support your business.



#### Find technical documentation

Find technical documentation you need to get your project up running. Get direct access to our official collection of data sheets, certificates and declarations, manuals and guides, 3D models and drawings, case stories, brochures, and much more. Start searching now at: [documentation.danfoss.com](https://documentation.danfoss.com).



#### Danfoss Learning

Danfoss Learning is a free online learning platform. It features courses and materials specifically designed to help engineers, installers, service technicians, and wholesalers better understand the products, applications industry topics, and trends that will help you do your job better. Find your local Danfoss website here: [learning.danfoss.com](https://learning.danfoss.com).



#### Get local information and support

Local Danfoss websites are the main sources for help and information about our company and products. Find product availability, get the latest regional news, or connect with a nearby expert - all in your own language. Find your local Danfoss website here: [danfoss.com](https://danfoss.com).

#### Danfoss A/S

Climate Solutions . danfoss.com . +45 7488 2222

---

Any information, including, but not limited to information on selection of product, its application or use, product design, weight, dimensions, capacity or any other technical data in product manuals, catalogues description, advertisements, etc. and whether made available in writing, orally, electronically, online or via download, shall be considered informative, and is only binding if and to the extent, explicit reference is made in a quotation or order confirmation. Danfoss cannot accept any responsibility for possible errors in catalogues, brochures, videos and other material. Danfoss reserves the right to alter its products without notice. This also applies to products ordered but not delivered provided that such alterations can be made without changes to form, fit or function of the products. All trademarks in this material are property of Danfoss A/S or Danfoss group companies. Danfoss and the Danfoss logo are trademarks of Danfoss A/S. All rights reserved.

---