

Shut Off Ball Valve

Type OFB

Refrigerants:

R134a, R513A, R515B, R1234ze(E)

For a complete list of approved refrigerants, visit <http://store.danfoss.com/> and search for individual code numbers, where refrigerants are listed as part of product details.

Oil: OFB valve is designed for an oil-free environment

Media Temperature:

Min. -40 °C / -40 °F

Max. 100 °C / 212 °F

Max. Working Pressure:

PS/MWP = 23 bar / 334 psig

Accessories delivered with OFB:

- Bolts M16×55 (4 pcs)
- M16 plain washer (4 pcs)
- M16 spring washer (4 pcs)
- O-ring compatible for Turbocor compressor (1 pc)
- M8×20 tensilock bolts (4 pcs)
- O-ring lubrication (2 gram)
- Manual kit

Accessories delivered with flange:

- Bolts M16×90 (4 pcs)
- M16 plain washer (8 pcs)
- M16 spring washer (8 pcs)
- M16 nuts (4 pcs)
- O-ring compatible with OFB (1 pc)
- O-ring lubrication (2 gram)

Interface connection:

Install the valve directly onto the Danfoss Turbocor compressor, as illustrated with a suction side ball valve featuring a 4 ANSI flange. Ensure that all fasteners and bolts are made of stainless steel, with bolts meeting a minimum class of A2-70.



Note: Protection of entire valve including steel flange is recommended after installation for outdoor use.



Installation steps:

Figure 1: Ensure the pipe is connected to the flange in accordance with the specific requirements of the connection application, welding or soldering etc.

Figure 2: Position the lubricated O-ring in the O-ring groove. Carefully remove the O-ring for reuse.

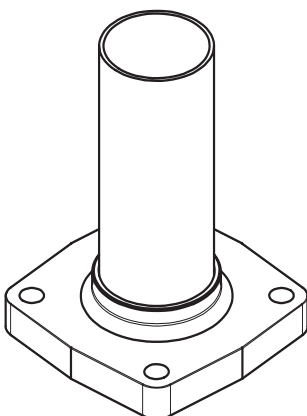

Figure 1

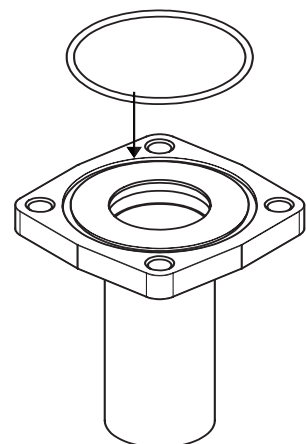

Figure 2



Note: Never solder the flange when it is connected on OFB valve.

Installation steps:

Figure 3: Attach the flange to the ball valve



Note: The surface of steel flange needs to be guarded against corrosion with a suitable protective coating before installation.

The spring-loaded ball seal assembly will be securely positioned once the flange is placed on top.

Bolt size – M16x90
Torque: 80 Nm \pm 10 Nm

Don't scratch the sealing surface of the ball valve

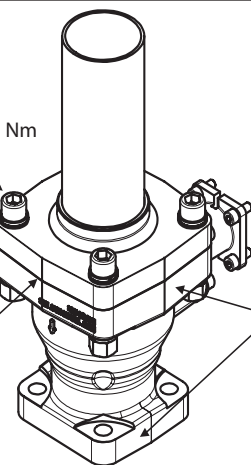

Figure 3

Installation steps:

Figure 4: Attach the ball valve directly to the Turbocor compressor
Place lubricated O-ring in the O-ring groove of Turbocor compressor suction flange



Note: Don't lubricate spindle and bonnet, mineral oil may damage the O-rings.

Bolt size – M16x55
Torque: Reference to the specific compressor requirements

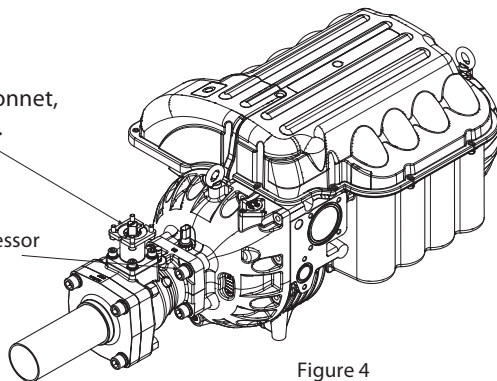
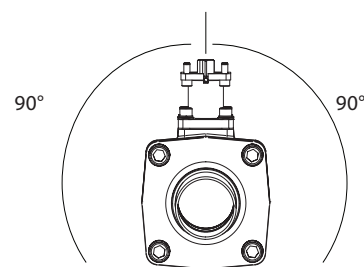
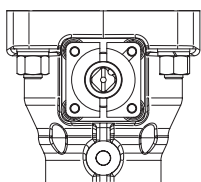

Figure 4

Mounting angle:



Option 1: Electrical actuation - Mount the actuator on ball valve (keep the valve close before mounting)



Open

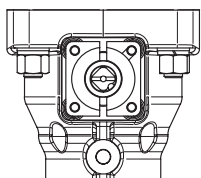

Close

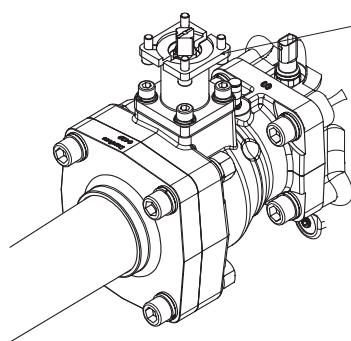

Actuator mounting flange

ISO 5211 - F07

Stem dimension: square 17 mm

Manual open/close
Clockwise: close
Anti-clockwise: open

Yellow: open
Red: close

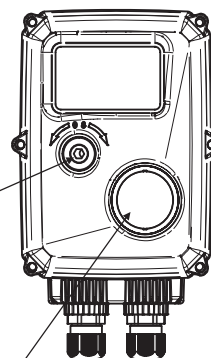

Use four tensilock screws to mount the actuator onto the actuator mounting flange, tighten the screws with torque 15 \pm 3 Nm

Option 2: Manual actuation - Mount the manual kit on the ball valve

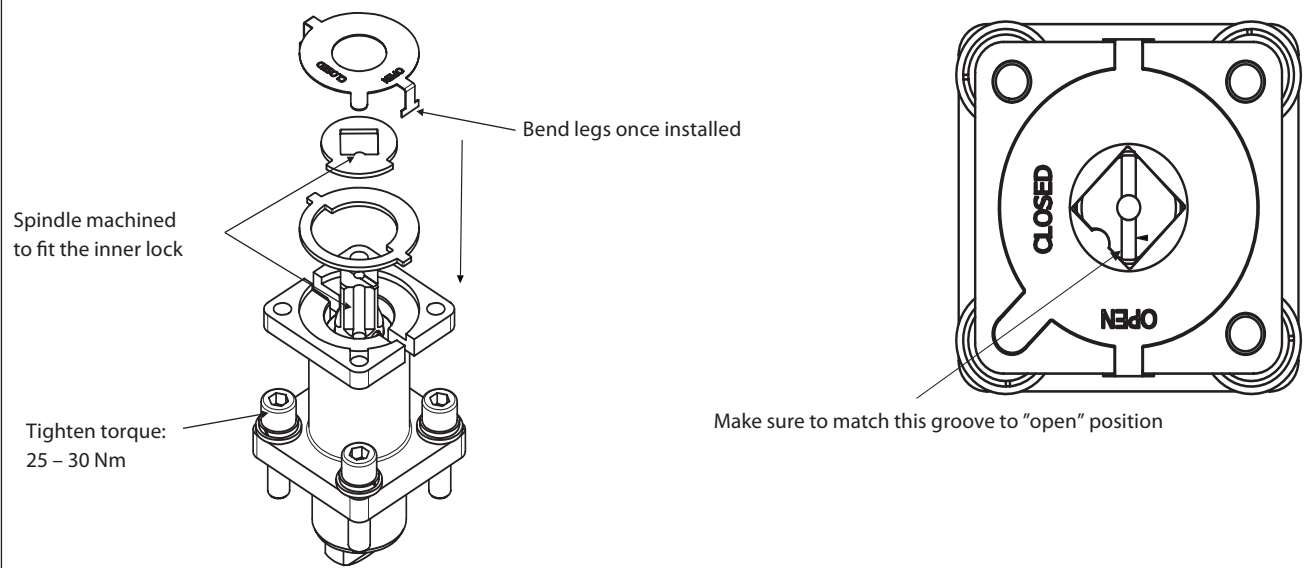

Danfoss A/S
Climate Solutions • danfoss.com • +45 7488 2222

Any information, including, but not limited to information on selection of product, its application or use, product design, weight, dimensions, capacity or any other technical data in product manuals, catalogues descriptions, advertisements, etc. and whether made available in writing, orally, electronically, online or via download, shall be considered informative, and is only binding if and to the extent, explicit reference is made in a quotation or order confirmation. Danfoss cannot accept any responsibility for possible errors in catalogues, brochures, videos and other material. Danfoss reserves the right to alter its products without notice. This also applies to products ordered but not delivered provided that such alterations can be made without changes to form, fit or function of the product.

All trademarks in this material are property of Danfoss A/S or Danfoss group companies. Danfoss and the Danfoss logo are trademarks of Danfoss A/S. All rights reserved.