



# Gear actuators

## AME 435 QM

## Description

AME 435 QM actuator for modulating control is used with pressure independent balancing and control valve type AB-QM from DN 40 to DN 100.

## Features & benefits

- It automatically adapts its stroke to the valve end positions which reduces commissioning time
- Valve flow adjustment feature; flow can be variably-adjusted from linear to logarithmic or opposite
- The advanced design incorporates load related 'switch-off' to ensure that actuators and valves are not exposed to overload

## Ordering

### Product code numbers

Type	Supply voltage [V]	Code number	VVS DK
AME 435 QM	24 V AC/DC	082H0171	460946435

### Accessories code numbers

#### Accessories-Adapter

Type	for valve's DN	for Actuator	Code number	Only for Danish market VVS-nr.
AB-QM adapter (2 <sup>st</sup> generation)	40-100	AME 15 QM	<b>003Z0694</b>	40 6847.932
AB-QM adapter (1 <sup>st</sup> generation)		AME 435 QM	<b>065Z0313</b>	46 0946.910

## Overview

### Product portfolio

#### Actuator - valve combinations

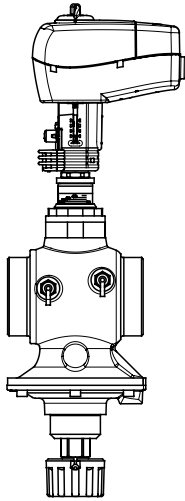

AME 435 QM +  
AB-QM (DN 40/50)

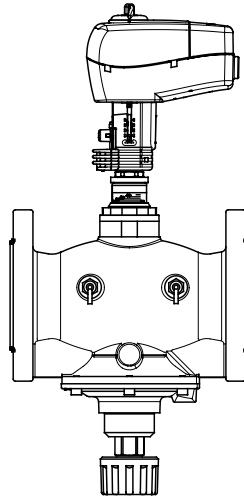

AME 435 QM +  
AB-QM (DN 50)

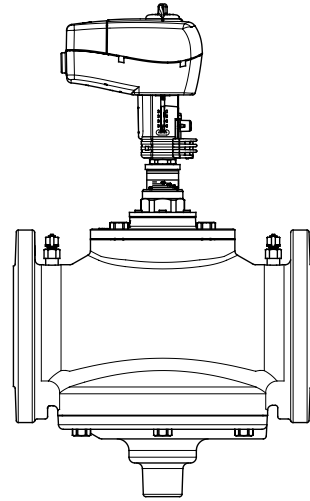

AME 435 QM +  
AB-QM (DN 65-100)

## Functions

### Operation

#### Commissioning

Complete the mechanical and electrical installation, set DIP-switches, then perform the necessary checks and tests:

- Apply power  
Note that the actuator will now perform automatic Calibrating function
- Apply the appropriate control signal and check:
  - SW7 setting
  - the actuator drives the valve over the entire stroke length

The unit is now fully commissioned.

#### Automatic Calibrating feature

The actuator automatically adapts its stroke to the valve end positions :

- when power is applied for the first time or
- afterwards by pressing the STAND BY/RESET button 6-9 seconds (LED blinks green twice)

#### Testing entire valve stroke length

The actuator can be driven to the fully-open or closed positions by connecting SN to terminals 1 or 3.

## Led signalling/ Actuator operating modes

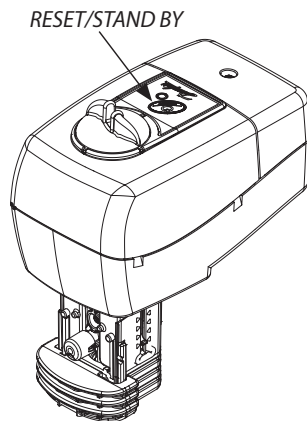

Flashing <b>green</b> LED: Calibrating mode (period is every second)	
Constant <b>green</b> LED: Positioning mode	
Flashing <b>green</b> LED: Normal mode (period is every 6 seconds)	
Flashing <b>red</b> LED: STAND BY mode (period is every two seconds)	
Constant <b>red</b> LED: ERROR MODE	

### STAND-BY, RESET and LOCK MODE on actuator AME 435 QM

#### Starting from NORMAL MODE

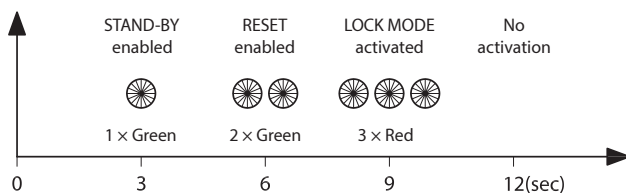

#### Starting from LOCK MODE

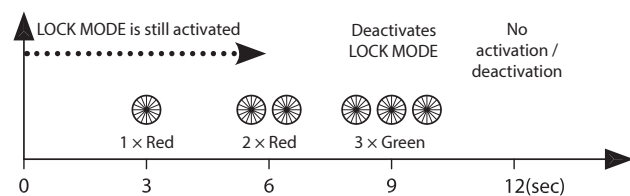

#### LED function indicator

The bi-colour (green/red) LED function indicator is located on the actuator cover. It indicates the operating modes.

#### External button

Actuator has external RESET-button which is located next to LED indicator. By pressing on this button in different ways different operating modes are initiated:

#### • CALIBRATION MODE

Pressing the RESET-button for 6-9 sec. and releasing it after 2x green LED blinks causes the actuator to start the calibration: The bi-colour LED flashes green at 1 sec. intervals during calibration procedure, which begins by extracting the stem. When the maximum force is detected (at the end valve position), the actuator then retracts the stem, until the maximum force is once again detected (on the other valve end position). The actuator will then enter to normal mode and respond to the control signal.

#### • NORMAL MODE

When the positioning of the actuator is finished the LED flashes green every 6 seconds.

#### • STAND BY MODE

Pressing the RESET-button for 3-6 sec. and releasing it after 1x green LED blink causes the actuator to activate STAND-BY MODE. The actuator keeps its last position in this mode and does not react to any control signal. This mode can be used for manual operation during the commissioning of other equipment, or for service purposes.

The bi-colour LED flashes red at 2 sec. intervals.

After pressing the STAND-BY/RESET-button again actuator switches to normal mode.

#### • LOCK MODE

Pressing the RESET-button for 9-12 sec. and releasing it after 3x red LED blinks causes the actuator to activate LOCK MODE. The actuator can not be brought to STAND-BY MODE or CALIBRATION MODE until it was switched back again to NORMAL MODE by pressing the button as mentioned before (releasing the button now after 3x green LED blinks). During LOCK MODE, the actuator works just as described in NORMAL or POSITIONING MODE, but with partly locked button-functions (shown with 1x or 2x red LED blinks).

#### • REMARK

Pressing the RESET-button for more than 12 sec., no activation/deactivation occurs.

## Manual override

Manual override is done by means of control knob on actuator housing:

- Disconnect power supply or press STAND BY/ RESET button
- Adjust valve position using the control knob (observe the rotation direction)

When manual override is not needed:

- Restore power supply or press STAND BY/ RESET button again

*Remark:*

*When the manual override has been used, the output signal (X) is not correct until the actuator reaches its end position.*

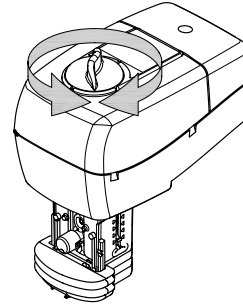

## Settings DIP switch settings

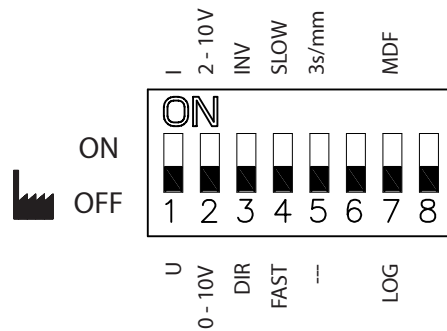

### DIP switches

- **SW 1:** U/I - Input signal type selector
  - OFF position; voltage input is selected
  - ON position; current input is selected
- **SW 2:** Input signal range selector
  - OFF position; the input signal is in the range from 0-10 V (voltage input) or from 0-20 mA (current input)
  - ON position; the input signal is in the range from 2-10 V (voltage input) or from 4-20 mA (current input)
- **SW 3:** Direct or inverse acting selector
  - OFF position; the actuator is in direct acting mode (stem extracts as voltage increases)
  - ON position; the actuator is in inverse acting mode (stem retracts as voltage increases)
- **SW 4:** Fast/Slow - Speed selector
  - OFF position; the actuating speed is 7.5 s/mm
  - ON position; the actuating speed is 15 s/mm

- **SW 5:** ---/ 3s/mm - Normal or Very high speed selector
  - If set to OFF position, the actuator is working in “normal” selected speed (7.5 or 15 s/mm).
  - If set to ON position, the actuator is working in very high actuating speed 3 s/mm.

- **SW 6:** Not used

- **SW 7:** LOG/MDF - Logarithmic or modified flow through valve selector
  - OFF position; ..... LOG ( $\alpha=0.2$ , factory setting)
  - ON position; .....MDF (initial setting:  $\alpha=1$ , linear)

### Explanation:

If SW 7 is in OFF position, alpha knob is not activated. Turning alpha knob will not influence a value ( $\alpha=0.2$ ).

If SW 7 is in ON position, a value can be manipulated using alpha knob. MDF initial setting of alpha knob is 1, which means linear setting. Regarding alpha knob setting see explanation below.

- **SW 8:** Not used

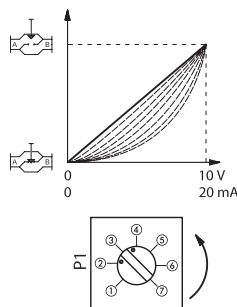

Alpha knob found on PCB in MDF initial setting (linear,  $\alpha=1$ )

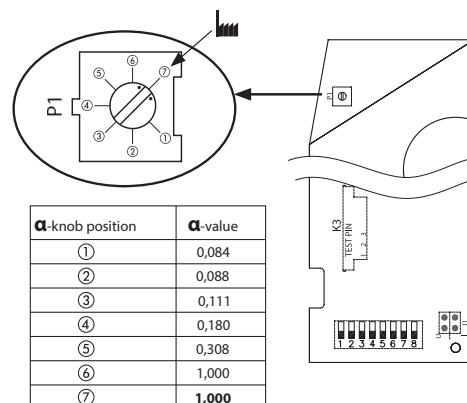

### Equal-percentage valve-flow adjustment (SW 7 in position ON)

The actuator has a special valve-flow adjustment feature called alpha value. Actuator characteristics can be, by turning

In order to have optimal control, linear characteristics of system (valve, actuator, HEX) is required. This can be assured using the right  $\alpha$  value. Appropriate  $\alpha$  value depends on temperatures of heating/cooling medium and controlled temperature of heated/cooled medium. Calculate a value

the alpha knob counter clockwise (CCW), variably-adjusted from  $\alpha=1$  (linear) to  $\alpha=0.1$ .

according to the Tech Note number AC042486454455en... (Setting the right  $\alpha$  value).

## Product details

### General data

### Technical data

Power supply		V	24 AC/DC; $\pm 10\%$
Power consumption	running	VA	4.5
	standby		1.2
Frequency		Hz	50/60
Control input Y		V	0-10 (2-10); $R_i = 95 \text{ k}\Omega$
		mA	0-20 (4-20); $R_i = 500 \Omega$
Output signal X		V	0-10 (2-10); $R_L = 650 \Omega$ (maximal load)
Closing force		N	400
Max. stroke		mm	20
Speed		s/mm	3 or 7.5 or 15
Max. medium temperature			120
Ambient temperature		$^{\circ}\text{C}$	0 ... 55
Storage and transport temperature			-40 ... 70
Humidity			95% r.h., non-condensing
Protection class			II
Grade of enclosure			IP 54
Weight		kg	0.45

## Dimensions

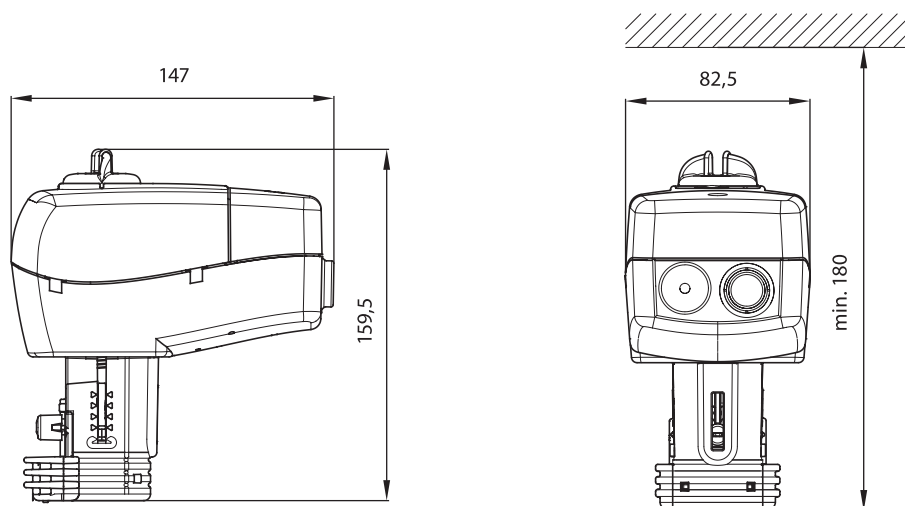

## Installation

### Mechanical

No tool is required to mount actuator on the valve. Installation of the valve with the actuator is allowed in horizontal position or upwards.

Installation downwards is not allowed.

The actuator must not be installed in an explosive atmosphere, at ambient temperature lower than 0 °C or at ambient temperature higher than 55 °C. It must not be subject to steam jets, water jets or dripping liquid as well.

### Note:

*The actuator may be rotated up to 360° with respect to the valve stem by loosening the retaining fixture. Once the actuator is placed, retighten the fixture.*

### Electrical

Electrical connections can be accessed by removing the actuator cover. Two cable gland entries without thread (Ø16 and combined Ø16/Ø20) are prepared for cable glands. From factory one entry is provided by rubber cable gland and the other entry is prepared for opening.

### Note:

*Cable and cable gland used must not compromise the actuator's IP rating, and must ensure the connectors are fully strain relieved. Rubber cable gland delivered from factory does not compromise IP rating but it does not provide fully strain relieve according to LVD directive.*

*Please observe local rules and regulations as well.*

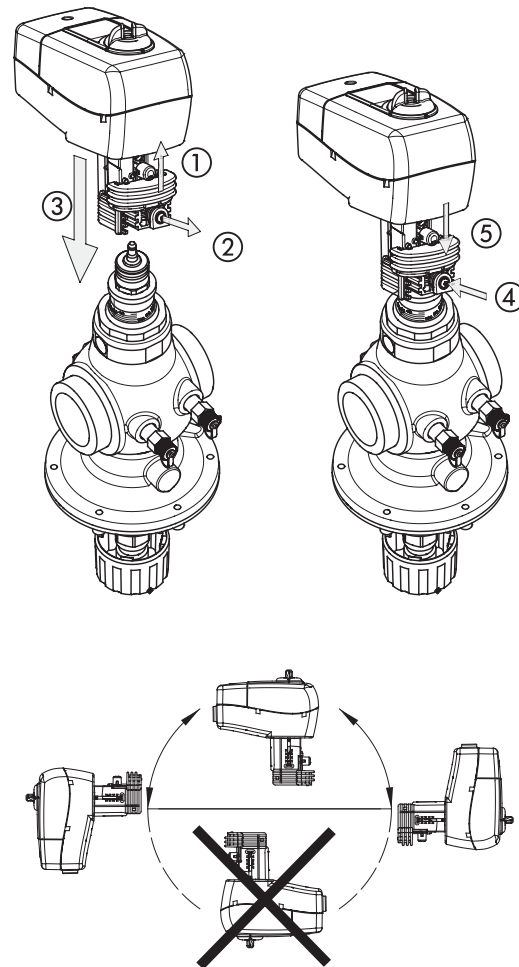

## Wiring



24 V AC/DC only

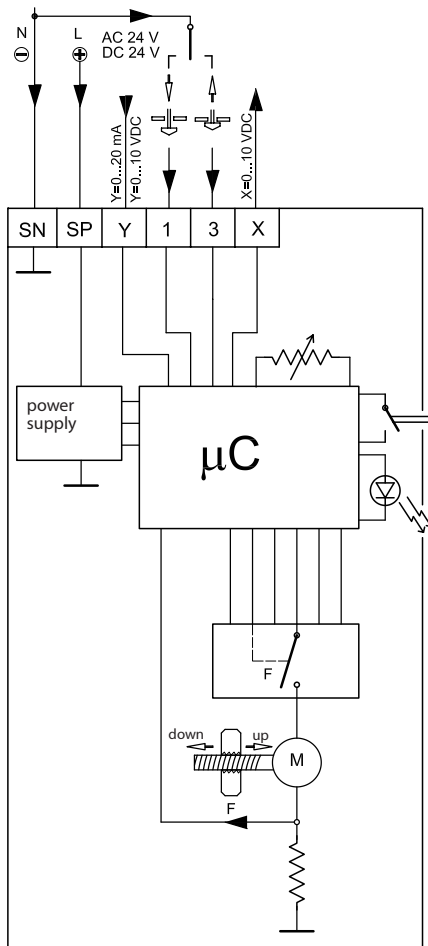

<b>SP</b>	24 V AC/DC	Power supply
<b>SN</b>	0 V	Common
<b>Y</b>	0-10 V (2-10 V)	Input signal
	0-20 mA (4-20 mA)	
<b>X</b>	0-10 V	Output signal
	(2-10 V)	
<b>1, 3</b>	Override input signal	

The actuator can be driven to the fully-closed position by connecting SN to terminal 1 or fully open by connecting SN to terminal 3.

E.g. terminal 3 can be connected to a thermostat to prevent freezing and terminal 1 can be connected to the thermostat to prevent overheating.

Wiring length	Recommended cross-sectional area of the wiring
0-50 m	0.75 mm <sup>2</sup>
> 50 m	1.5 mm <sup>2</sup>

**Important:** AME 435QM can be used only for modulating control. For 3-point control use AMV 435 (082H0162/163). It is recommended to use modulating control with AB-QM.

## Certificates, declarations and approvals

The list contains all certificates, declarations, and approvals for this product type. Individual code number may have some or all of these approvals, and certain local approvals may not appear on the list.

When you click on the link you will be directed to the latest version of the 'Declaration of Conformity'. Products developed and sold before this date of issue conform to the directives/standards in force at the time of their sale.

Approval type	Title	Certification body	Approval topic
EU Declaration	<a href="#">Danfoss EU</a> <a href="#">221011EN0815101.04</a>	Danfoss	LVD, EU RoHS
Export Control Declaration	<a href="#">Gear and Thermal actuators</a>	Danfoss	

## Contact details

### Online support

Danfoss offers a wide range of support along with our products, including digital information, software, mobile apps and expert guidance. See the possibilities below.



#### The Danfoss Design center

Discover the Design Center, our advanced digital platform that streamlines product selection. With integrated tools and enhanced type pages, it's simpler than ever to access product information and documentation, and to select the right products. Check the availability of Danfoss products at partner locations and enjoy seamless transitions from selection to purchase with our basket-to-basket functionality. Whether you're buying from our distributors or directly from the Product Store, the Design Center simplifies your experience. Learn more at: [designcenter.danfoss.com](https://designcenter.danfoss.com).



#### The Danfoss product store

The Danfoss Product Store is a one-stop shop available 24/7 for our customers, no matter where you are in the world or what area of industry you work in. Browse our catalog, check product details and documentation, view your prices and product availability, and quickly finalize your purchase. Start browsing at: [store.danfoss.com](https://store.danfoss.com).



#### Danfoss Partner Portal/Product Data tool

Designed to support you with easy access to product data extracts, essential resources, tools, and information. The Partner Portal provides a centralized hub for product documentation, training materials, marketing assets, and technical support, ensuring you have everything you need to succeed and grow your business with Danfoss. The Partner Portal is available 24/7 at: [partner.danfoss.com](https://partner.danfoss.com) and is ready to support your business.



#### Find technical documentation

Find technical documentation you need to get your project up running. Get direct access to our official collection of data sheets, certificates and declarations, manuals and guides, 3D models and drawings, case stories, brochures, and much more. Start searching now at: [documentation.danfoss.com](https://documentation.danfoss.com).



#### Danfoss Learning

Danfoss Learning is a free online learning platform. It features courses and materials specifically designed to help engineers, installers, service technicians, and wholesalers better understand the products, applications industry topics, and trends that will help you do your job better. Find your local Danfoss website here: [learning.danfoss.com](https://learning.danfoss.com).



#### Get local information and support

Local Danfoss websites are the main sources for help and information about our company and products. Find product availability, get the latest regional news, or connect with a nearby expert - all in your own language. Find your local Danfoss website here: [danfoss.com](https://danfoss.com).

#### Danfoss A/S

Climate Solutions . danfoss.com . +45 7488 2222

---

Any information, including, but not limited to information on selection of product, its application or use, product design, weight, dimensions, capacity or any other technical data in product manuals, catalogues description, advertisements, etc. and whether made available in writing, orally, electronically, online or via download, shall be considered informative, and is only binding if and to the extent, explicit reference is made in a quotation or order confirmation. Danfoss cannot accept any responsibility for possible errors in catalogues, brochures, videos and other material. Danfoss reserves the right to alter its products without notice. This also applies to products ordered but not delivered provided that such alterations can be made without changes to form, fit or function of the products. All trademarks in this material are property of Danfoss A/S or Danfoss group companies. Danfoss and the Danfoss logo are trademarks of Danfoss A/S. All rights reserved.

---