

## Installation Guide

### VG, VGF, VGS, VGU, VGUF

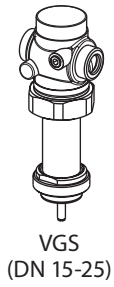

MAINTENANCE  
FREE



VGS  
(DN 15-25)



VG/VGU  
(DN 15-25)

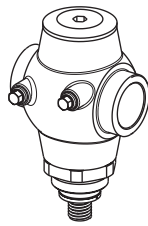

VG/VGU  
(DN 32-50)

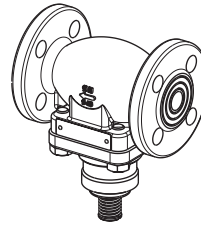

VGF  
(DN 15-25)

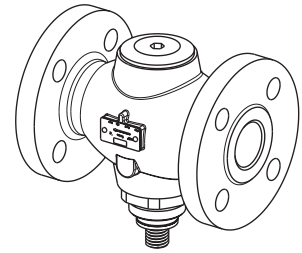

VGF/VGUF  
(DN 32-50)

**VG** (DN 15-50)  
**VGF** (DN 15-50)  
**VGS** (15-25)  
**VGU** (15-50)  
**VGUF** (32-50)

+

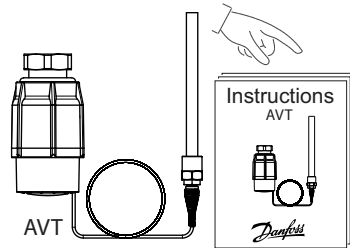

**VG** (DN 15-50)  
**VGF** (DN 15-50)  
**VGS** (15-25)

+

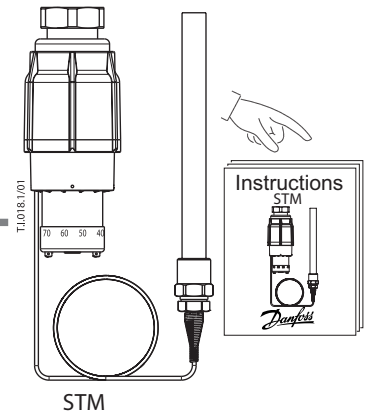

**VGU** (DN 15-50)  
**VGUF** (DN 32-50)

-

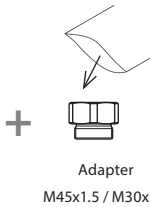

M45x1.5 / M30x1.5

+

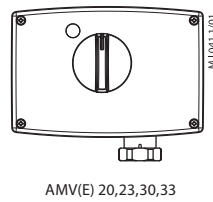

AMV(E) 20,23,30,33

=

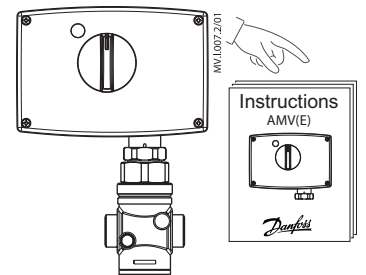

# Installation Guide VG, VGF, VGS, VGU, VGUF

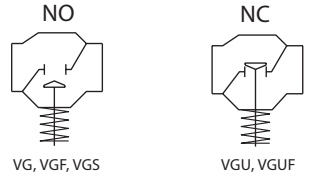
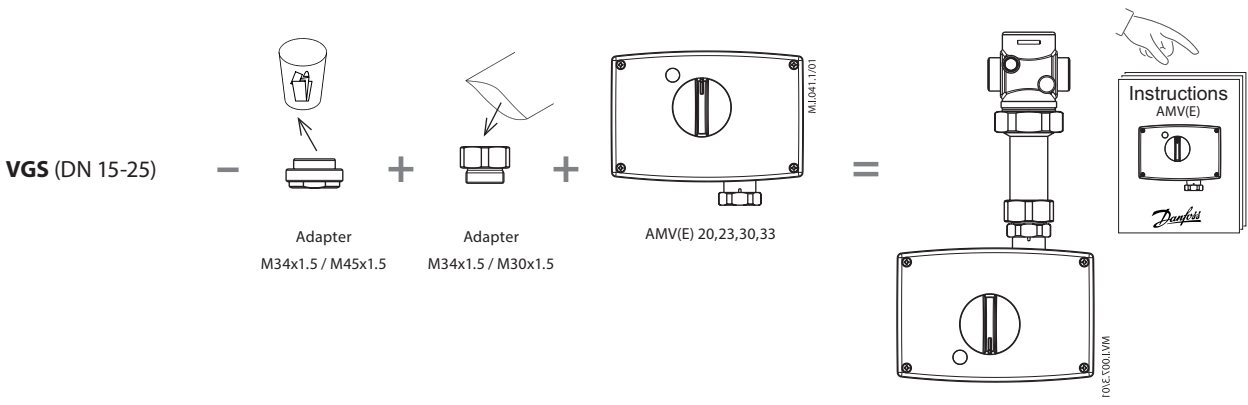

| Valve type | PN | °C               |                  |
|------------|----|------------------|------------------|
|            |    | T <sub>max</sub> | T <sub>min</sub> |
| VG         | 25 | 150              | 2                |
| VGF        | 25 | 150              | 2                |
| VGS        | 25 | 200              | 2                |
| VGU        | 25 | 150              | 2                |
| VGUF       | 25 | 150              | 2                |

According to EN 1092-2, EN 1092-3

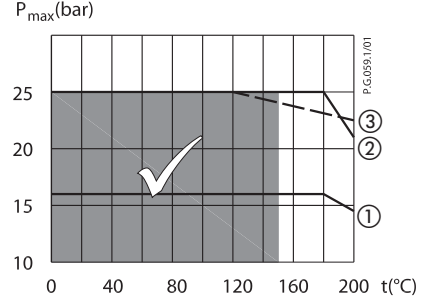

# Installation Guide VG, VGF, VGS, VGU, VGUF

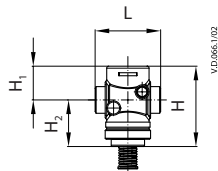

VGU DN 15-25

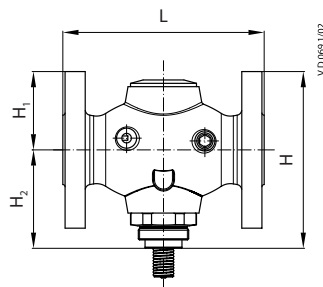

VGUF DN 32-50

### VGU

| DN | L   | H   | H <sub>1</sub> | H <sub>2</sub> | Weight (kg) |
|----|-----|-----|----------------|----------------|-------------|
|    | mm  |     |                |                |             |
| 15 | 65  | 80  | 34             | 46             | 0,7         |
| 20 | 70  | 80  | 34             | 46             | 0,8         |
| 25 | 75  | 83  | 37             | 46             | 0,9         |
| 32 | 100 | 154 | 63             | 91             | 3,2         |
| 40 | 110 | 154 | 63             | 91             | 3,3         |
| 50 | 130 | 154 | 63             | 91             | 4,1         |

### VGUF

| DN | L   | H   | H <sub>1</sub> | H <sub>2</sub> | Weight (kg) |
|----|-----|-----|----------------|----------------|-------------|
|    | mm  |     |                |                |             |
| 32 | 180 | 158 | 70             | 88             | 7,5         |
| 40 | 200 | 163 | 75             | 88             | 9,0         |
| 50 | 230 | 171 | 83             | 88             | 11,1        |

**Note:** other flange dimensions - see table for tailpieces

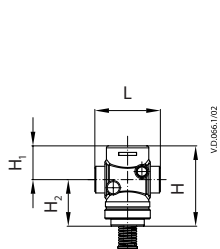

VG DN 15-25

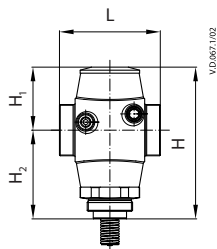

VG DN 32-50

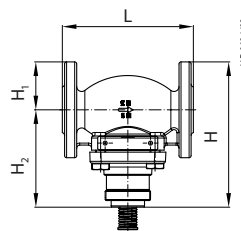

VGF DN 15-25

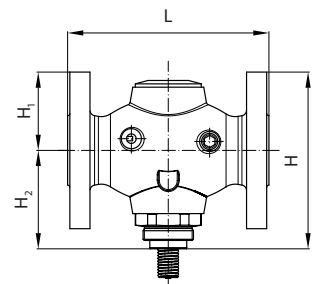

VGF DN 32-50

### VG

| DN | L   | H   | H <sub>1</sub> | H <sub>2</sub> | Weight (kg) |
|----|-----|-----|----------------|----------------|-------------|
|    | mm  |     |                |                |             |
| 15 | 65  | 80  | 34             | 46             | 0,7         |
| 20 | 70  | 80  | 34             | 46             | 0,8         |
| 25 | 75  | 83  | 37             | 46             | 0,9         |
| 32 | 100 | 154 | 63             | 91             | 3,0         |
| 40 | 110 | 154 | 63             | 91             | 3,1         |
| 50 | 130 | 154 | 63             | 91             | 3,8         |

### VGF

| DN | L   | H   | H <sub>1</sub> | H <sub>2</sub> | Weight (kg) |
|----|-----|-----|----------------|----------------|-------------|
|    | mm  |     |                |                |             |
| 15 | 130 | 144 | 48             | 96             | 3,3         |
| 20 | 150 | 149 | 53             | 96             | 4,1         |
| 25 | 160 | 154 | 58             | 96             | 4,7         |
| 32 | 180 | 158 | 70             | 88             | 7,5         |
| 40 | 200 | 163 | 75             | 88             | 9,0         |
| 50 | 230 | 171 | 83             | 88             | 11,1        |

**Note:** other flange dimensions - see table for tailpieces

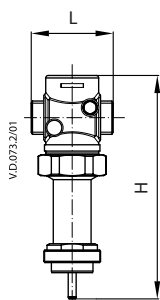

| DN  | 15     | 20    | 25  |       |     |
|-----|--------|-------|-----|-------|-----|
| VGS | L      | 65    | 70  | 75    |     |
|     | H      | 156,5 | 155 | 158,5 |     |
|     | Weight | kg    | 0,7 | 0,8   | 0,9 |

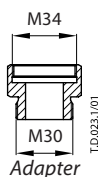

M34 × 1,5 mm / M30 × 1,5 mm

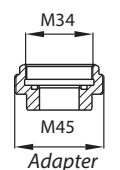

M34 × 1,5 mm / M45 × 1,5 mm

# Installation Guide VG, VGF, VGS, VGU, VGUF

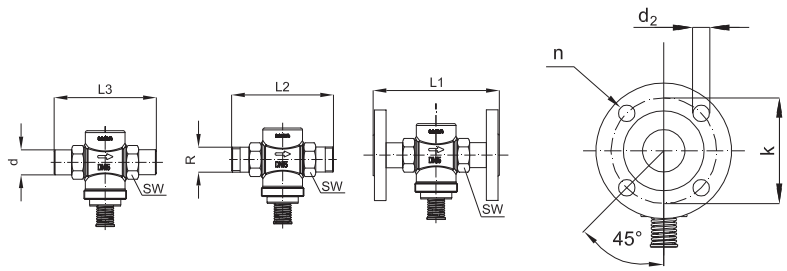

|                  |    |           |           |            |            |           |            |
|------------------|----|-----------|-----------|------------|------------|-----------|------------|
| DN               |    | 15        | 20        | 25         | 32         | 40        | 50         |
| SW               |    | 32 (G ¾A) | 41 (G 1A) | 50 (G 1¼A) | 63 (G 1¾A) | 70 (G 2A) | 82 (G 2½A) |
| d                |    | 21        | 26        | 33         | 42         | 47        | 60         |
| R <sup>1)</sup>  |    | ½         | ¾         | 1          | 1 ¼        | -         | -          |
| L1 <sup>2)</sup> |    | 130       | 150       | 160        | -          | -         | -          |
| L2               | mm | 131       | 142       | 159        | 172        | -         | -          |
| L3               |    | 139       | 154       | 159        | 184        | 244       | 298        |
| k                |    | 65        | 75        | 85         | 100        | 110       | 125        |
| d <sub>2</sub>   |    | 14        | 14        | 14         | 18         | 18        | 18         |
| n                |    | 4         | 4         | 4          | 4          | 4         | 4          |

<sup>1)</sup> Conical ext. thread acc. to EN 10266-1  
<sup>2)</sup> Flanges PN 25, acc. to EN 1092-2

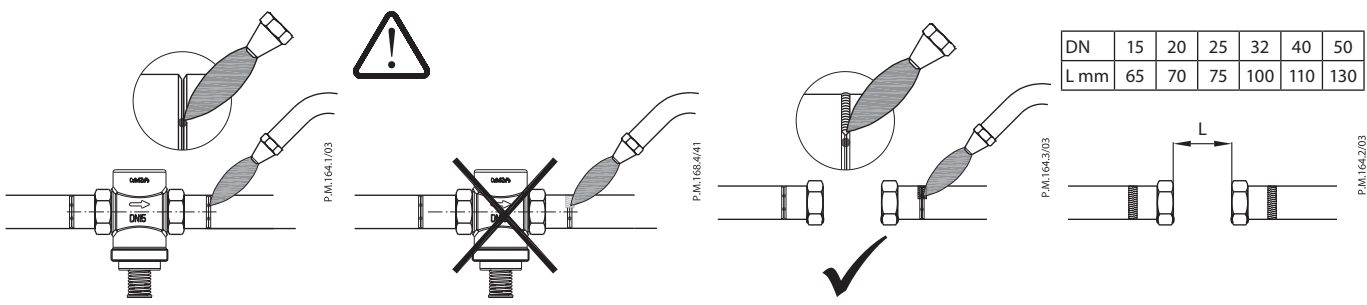

Danfoss can accept no responsibility for possible errors in catalogues, brochures and other printed material. Danfoss reserves the right to alter its products without notice. This also applies to products already on order provided that such alterations can be made without subsequential changes being necessary in specifications already agreed. All trademarks in this material are property of the respective companies. Danfoss and the Danfoss logotype are trademarks of Danfoss A/S. All rights reserved.